

Deep Well No. 3 - NE corner of property

Registration No. GR 2675

Certificate No. GR 2610

Registration Statement

OF CLAIMANT OF RIGHT TO APPROPRIATE GROUND WATER

TO THE STATE ENGINEER OF OREGON:

I, Ralph H. Cake, President of Equitable Savings & Loan Association,

of 411 SW 6th Avenue County of Multnomah
(Mailing address)

State of Oregon, do hereby make application for a certificate of registration as evidence of a right to appropriate ground water.

1. Source from which water is withdrawn is pump well
(Flowing well, pump well, infiltration trench, or tunnel)

2. Location is: 421 SW 6th Avenue
(Approximate distance and direction from nearest city or town)

and is more particularly described as follows:

(a) SW 1/4 of SW 1/4 of Sec. 34, Twp. 1 N, Rge. 1 E
(Give distance and bearing to corner of section or other legal subdivision)
(Smallest legal subdivision) (N. or S.) (E. or W.)

or (b) within limits of recorded platted property, town or city:

N.E. corner of Lot 1 Block 176 of City of Portland
(Name of plat or addition)
County of Multnomah
(If within city or town, give name)

3. Construction Work was begun on 12-3-46; was completed on 1-1-47
(Date) (Date)

and the ground water claimed was first used for the purposes set out below on 1-1-48
(Date)

since which time the water has been used continuously at varying g.p.m.
(Continuously or intermittently)

from to
(Date) (Date)

4. Quantity of water claimed and used is 510 gallons per minute; acre feet per year.

5. Purpose or Purposes for which water is used heat source, heat sink for heat pump
(Domestic, irrigation, municipal, manufacturing, industrial, etc.)

6. Description of Well: Depth 165 feet. Type drilled
(Dug or drilled)

diameter 12 inches. Elevation of ground at well site 25.00 feet, mean sea level.
(As near as known)

Depth to water table static level 30 ft. below um. feet.

7. Capacity of Well: 510 g.p.m. with 22 feet drawdown.

 g.p.m. with feet drawdown.

Date of test 2-2-47

If Flowing Well: Measured discharge g.p.m. on (Date)

Shut-in pressure at ground surface lbs. per sq. in. on (Date)

Water is controlled by
(Cap, valve, etc.)

8. **Casing:** (Give diameter, commercial specifications and depth below ground surface of each casing size.)

12 inch diameter from 0 to 165 feet
 inch diameter from to feet
 inch diameter from to feet
 inch diameter from to feet

Describe and show depth of shoe, plug, adapter, liner or other details:

9. **Perforated Casings or Screens:**

5 rows 1 ft. apart from 127 to 165
(Number per foot and size of perforations, or describe screen)
 from to
 from to
 from to

10. **Log of Well:** (Describe each stratum or formation clearly, indicate if water bearing, and give thickness and depth as indicated.)

MATERIAL	Thickness (Feet)	Depth to Bottom (Feet)
Sand, gravel, boulders	35	130
Cemented gravel	20	110
Blue clay	3	0

If log of well is not available, give name and address of driller. A. M. Janssen Drilling Co.

21075 SW Tualatin Val. Hy. Aloha, Oregon.

11. Infiltration Trench: Covered or open U

Dimensions: Length 12 ft. Minimum depth _____ ft. Maximum depth _____ ft.

Bottom width _____ ft. Discharge _____ g.p.m. Date of test _____

12. Tunnel: Type of lining _____

Dimensions: _____
(Length, course, and cross sectional size)

Position of water bearing stratum with reference to portal of tunnel _____

Log of tunnel: (Preceding table for log of well may be used, if desired. Give footage from portal and character of materials, as pertinent.)

13. Pumping Equipment: V. 3 G.P.M. 151 ft. head.

(a) Pump Peerless Moturbo, 10" M.A. 5 stage, 6" suction Capacity 371 g.p.m.
(Make, type and size)

(b) Motor U. S. Vertical
(Type and horsepower)

14. Location of area irrigated or to be irrigated, or place of use if for purposes other than irrigation.

Township North or South	RANGE or W. of Willamette Meridian	Section	Forty-acre Tract	Number Acres To Be Irrigated	Date of Reclamation
<u>T1N</u>	<u>R1E</u>	<u>34</u>	<u>SW 1/4 of SW 1/4</u>	<u>Industrial</u>	<u>1948</u>

15. If the ground water supply is supplemental to an existing water supply, identification of any application for a permit, permit, certificate or adjudicated right to appropriate water made or held by the registrant.

Township 1N Range 1E, W.M.
North

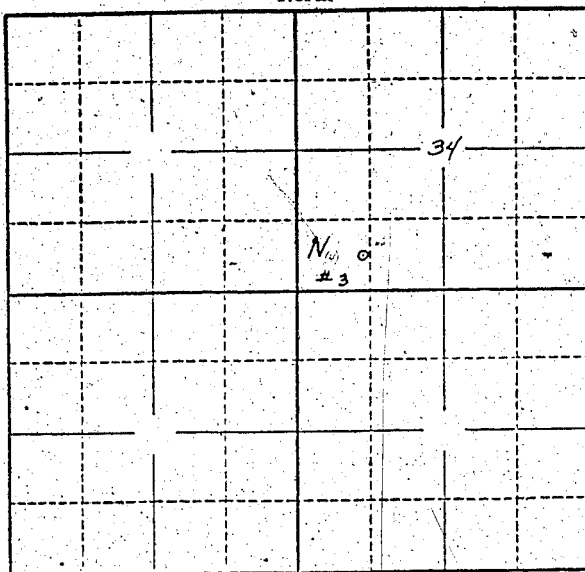

Locate well and acreage of irrigated land on plat.
Scale: 2" = 1 Mile

STATE OF OREGON }
County of Multnomah } ss.

I, Ralph H. Cake, being first duly sworn, do hereby certify that I have read the foregoing Registration Statement and that all of the items therein contained are true to the best of my knowledge and belief.

Ralph H. Cake
(Signature of Registrant)

Subscribed and sworn to before me this 24th day of July, 19 58

My commission expires Nov. 6, 1959

[Signature]
(Notary Public)

(SEAL)

CERTIFICATE OF REGISTRATION

STATE OF OREGON }
County of Marion } ss.

This is to certify that the foregoing Registration Statement was received in the office of the State Engineer on the 25th day of July, 1958, at 8:00 o'clock A.M. and has been duly recorded in said office in Book No. 11 of Registration Statements on page GR 2610

Witness my hand this 6th day of April, 19 59

[Signature]
(State Engineer)

By _____ (Deputy)

GR - 2610

\$ 22.00