

# Registration Statement

## OF CLAIMANT OF RIGHT TO APPROPRIATE GROUND WATER

TO THE STATE ENGINEER OF OREGON:

I, MARY MARTELLO  
of 11175 S.E. 22<sup>ND</sup> AVE - PORTLAND 66 County of CLATSOP  
State of OREGON do hereby make application for a certificate of registration as evidence of a right to appropriate ground water.

1. Source from which water is withdrawn is PUMP WELL  
(Flowing well, pump well, infiltration trench, or tunnel)

2. Location is: ABOUT 1 MILE SOUTH OF THE CITY LIMITS OF PORTLAND  
(Approximate distance and direction from nearest city or town)

and is more particularly described as follows:

(a) 1700 feet south & 280 feet west from NE Corner Section 32  
SE 1/4 NE 1/4  
(Give distance and bearing to corner of section or other legal subdivision)

being within ~~Section 32~~ of Sec. 32, Twp. 13, Rge. 2E  
(Smallest legal subdivision) (N. or S.) (E. or W.)

or (b) within limits of recorded platted property, town or city: \_\_\_\_\_

in Lot \_\_\_\_\_, Block \_\_\_\_\_ of \_\_\_\_\_  
(Name of plat or addition)

County of \_\_\_\_\_  
(If within city or town, give name)

3. Construction Work was begun on Aug. 25, 1944; was completed on Aug. 29, 1944  
(Date) (Date)

and the ground water claimed was first used for the purposes set out below on Aug. 29, 1944  
(Date)

since which time the water has been used CONTINUOUSLY  
(Continuously or Intermittently)

from Aug. 28, 1944 to JULY 23, 1952  
(Date) (Date)

4. Quantity of water claimed and used is 24 gallons per minute; \_\_\_\_\_ acre feet per year.

5. Purpose or Purposes for which water is used IRRIGATION

(Domestic, irrigation, municipal, manufacturing, industrial, etc.)

6. Description of Well: Depth 29 feet. Type DRILLED  
(Dug or drilled)

diameter 2 inches. Elevation of ground at well site 100 feet, mean sea level.  
(As near as known)

Depth to water table 40 feet.

7. Capacity of Well: 24 g.p.m. with \_\_\_\_\_ feet drawdown.

\_\_\_\_\_ g.p.m. with \_\_\_\_\_ feet drawdown.

Date of test Aug. 29, 1944

If Flowing Well: Measured discharge \_\_\_\_\_ g.p.m. on \_\_\_\_\_  
(Date)

Shut-in pressure at ground surface \_\_\_\_\_ lbs. per sq. in. on \_\_\_\_\_  
(Date)

Water is controlled by \_\_\_\_\_  
(Cap. valve, etc.)





Township 1S Range 2E, W.M.  
North

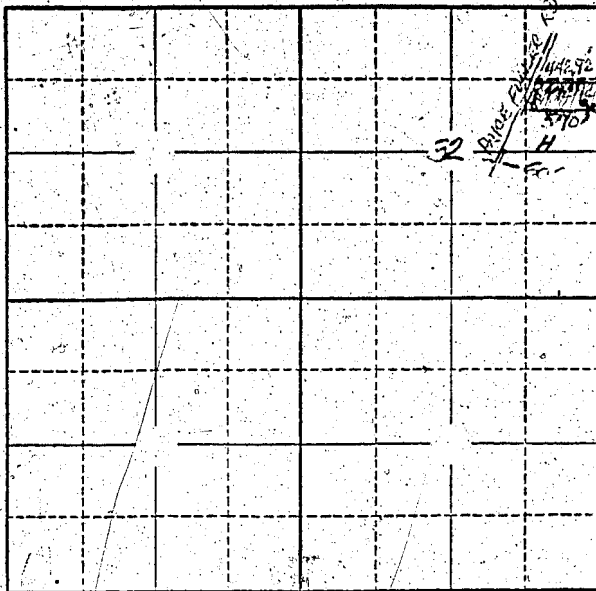

Locate well and acreage of irrigated land on plat.  
Scale: 2" = 1 Mile

STATE OF OREGON

County of CLATSOP } ss.

I, MARY MARTELL, being first duly sworn, do hereby certify that I have read the foregoing Registration Statement and that all of the items therein contained are true to the best of my knowledge and belief.

Mary Martell  
(Signature of Registrant)

Subscribed and sworn to before me this 23 day of July, 1958

My commission expires 8/21/60  
(Notary Public)

(SEAL)

**CERTIFICATE OF REGISTRATION**

STATE OF OREGON } ss.  
County of Marion

This is to certify that the foregoing Registration Statement was received in the office of the State Engineer on the 25 day of July, 1958, at 8:00 o'clock A. M. and has been duly recorded in said office in Book No. 11 of Registration Statements on page GR-2542

Witness my hand this 6th day of April, 1959

Lewis A. Stanley  
(State Engineer)

\$15.00

By \_\_\_\_\_ (Deputy)

GR - 2542