

STATE ENGINEER
SALEM, OREGON

Registration Statement

OF CLAIMANT OF RIGHT TO APPROPRIATE GROUND WATER

TO THE STATE ENGINEER OF OREGON:

I, Lamar Dodd

of 137 West Vilas Road, Central Point, County of Jackson

State of Oregon, do hereby make application for a certificate of registration as evidence of a right to appropriate ground water.

1. Source from which water is withdrawn is pump well
(Flowing well, pump well, infiltration trench, or tunnel)

2. Location is: 1 1/2 miles northeast of Central Point, Oregon
(Approximate distance and direction from nearest city or town)

and is more particularly described as follows:

(a) 295 feet South and 774 feet West from the N 1/2 corner Section 1
(Give distance and bearing to corner of section or other legal subdivision)

being within NW 1/4 NE 1/4 NW 1/4 of Sec. 1, Twp. 37 S., Rge. 2 W.
(Smallest legal subdivision) (N. or S.) (E. or W.)

or (b) within limits of recorded platted property, town or city:

in Lot _____, Block _____ of _____
(Name of plat or addition)

County of _____
(If within city or town, give name)

3. Construction Work was begun on 1938; was completed on 1949
(Date) (Date)

and the ground water claimed was first used for the purposes set out below on 1949
(Date)

since which time the water has been used continuously
(Continuously or Intermittently)

from 1949 to present
(Date) (Date)

4. Quantity of water claimed and used is 40 gallons per minute; 14 acre feet per year.

5. Purpose or Purposes for which water is used irrigation
(Domestic, irrigation, municipal, manufacturing, industrial, etc.)

6. Description of Well: Depth 40 feet. Type dug
(Dug or drilled)

diameter 120 inches. Elevation of ground at well site 1310 feet, mean sea level.
(As near as known)

Depth to water table 25 feet.

7. Capacity of Well: _____ g.p.m. with _____ feet drawdown.

_____ g.p.m. with _____ feet drawdown.

Date of test _____

If Flowing Well: Measured discharge _____ g.p.m. on _____
(Date)

Shut-in pressure at ground surface _____ lbs. per sq. in. on _____
(Date)

Water is controlled by _____
(Cap, valve, etc.)

8. Casing: (Give diameter, commercial specifications and depth below ground surface of each casing size.)

..... inch diameter none from to feet

..... inch diameter from to feet

..... inch diameter from to feet

..... inch diameter from to feet

Describe and show depth of shoe, plug, adapter, liner or other details:

.....

.....

9. Perforated Casings or Screens:

..... none from to

(Number per foot and size of perforations, or describe screen)

..... from to

..... from to

..... from to

10. Log of Well: (Describe each stratum or formation clearly, indicate if water bearing, and give thickness and depth as indicated.)

MATERIAL	Thickness (Feet)	Depth to Bottom (Feet)
not known		

If log of well is not available, give name and address of driller. not known

11. Infiltration Trench: Covered or open

Dimensions: Length ft. Minimum depth ft. Maximum depth ft.

Bottom width ft. Discharge g.p.m. Date of test

12. Tunnel: Type of lining

Dimensions:
(Length, course, and cross sectional size)

Position of water bearing stratum with reference to portal of tunnel

Log of tunnel: (Preceding table for log of well may be used, if desired. Give footage from portal and character of materials, as pertinent.)

13. Pumping Equipment:

(a) Pump 2.0 inch centrifugal (deep well) Capacity 40 g.p.m.
(Make, type and size)

(b) Motor 2.0 H.P. electric motor
(Type and horsepower)

14. Location of area irrigated or to be irrigated, or place of use if for purposes other than irrigation.

Township North or South	Range E. or W. of Willamette Meridian	Section	Forty-acre Tract	Number Acres To Be Irrigated	Date of Reclamation
37 S.	2 W.	1	E $\frac{1}{2}$ W $\frac{1}{2}$ NE $\frac{1}{4}$ NW $\frac{1}{4}$	3.0 acres	1949

15. If the ground water supply is supplemental to an existing water supply, identification of any application for a permit, permit, certificate or adjudicated right to appropriate water made or held by the registrant.

none

Township 37 S Range 2 W, W.M.

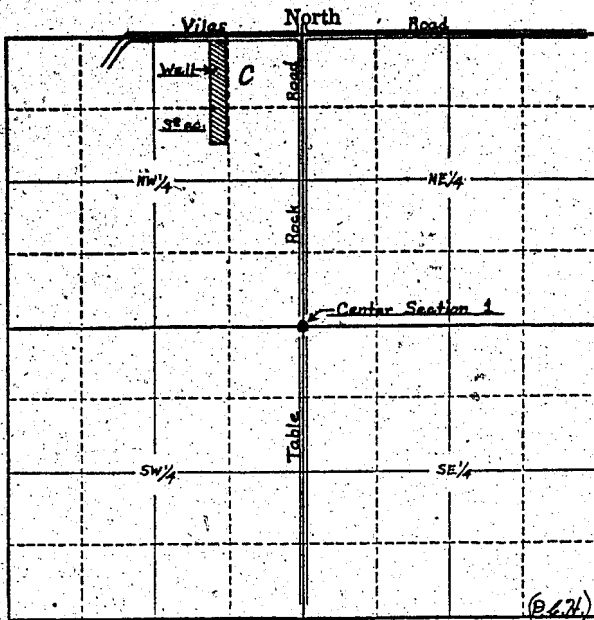

Locate well and acreage of irrigated land on plat.
Scale: 4' = 1 Mile

STATE OF OREGON

County of Jackson } ss.

I, Lamar Dodd, being first duly sworn, do hereby certify that I have read the foregoing Registration Statement and that all of the items therein contained are true to the best of my knowledge and belief.

Lamar Dodd
(Signature of Registrant)

Subscribed and sworn to before me this 23rd day of July, 1958

My commission expires August 25, 1958

[Notary Signature]
(Notary Public)

(SEAL)

CERTIFICATE OF REGISTRATION

STATE OF OREGON

County of Marion } ss.

This is to certify that the foregoing Registration Statement was received in the office of the State Engineer on the 25 day of July, 1958, at 8:00 o'clock A.M. and has been duly recorded in said office in Book No. 11 of Registration Statements on page GR 2548

Witness my hand this 6th day of April, 1959

Lewis A. Stanley
(State Engineer)

By _____ (Deputy)

\$15.00

GR - 2548