

RECEIVED
OCT 11 1956
STATE ENGINEER
SALMON, OREGON

REGISTRATION NO. GR-271
CERTIFICATE NO. GR-250

Registration Statement

OF CLAIMANT OF RIGHT TO APPROPRIATE GROUND WATER

(Under Chapter 708, Oregon Laws 1955.)

TO THE STATE ENGINEER OF OREGON:

I, W. T. Evenson, President of Wauna Lumber Company an Oregon Corporation,
of Wauna Ore County of Clatsop

State of Oregon, do hereby make application for a certificate of registration as evidence
of a right to appropriate ground water.

1. Source from which water is withdrawn is Well
(Flowing well, pump well, infiltration trench, or tunnel)

2. Location is: In the north edge of Wauna Lbr. Co town and Mill site
(Approximate distance and direction from nearest city or town)

and is more particularly described as follows:

(a) N. 4 1/2 W. 2735 ft from 1/4 S corner between Sec's 26 and 27, T. 8 N., R. 6 W
(Give distance and bearing to corner of section or other legal subdivision)

being within Lot 1 of Sec. 22, Twp. 8 N., Rge. 6 W.
(Smallest legal subdivision) (N. or S.) (E. or W.)

or (b) within limits of recorded platted property, town or city: Unincorporated

in Lot _____ Block _____ of _____
(Name of plat or addition)

County of Clatsop

(If within city or town, give name)

3. Construction Work was begun on Nov. 1, 1949; was completed on Dec 10, 1949
(Date) (Date)

and the ground water claimed was first used for the purposes set out below on December 1949
(Date)

since which time the water has been used Continuously
(Continuously or intermittently)

from December 1949 to present date
(Date) (Date)

4. Quantity of water claimed and used is 400 gallons per minute; 2500 acre
feet per year.

5. Purpose or Purposes for which water is used Domestic and Industrial
manufacturing, fire protection
(Domestic, irrigation, municipal, manufacturing, industrial, etc.)

6. Description of Well: Depth 60 feet. Type Drilled
(Dug or drilled)
diameter 10 inches. Elevation of ground at well site 25 feet, mean sea level.
(As near as known)

Depth to water table 40 feet.

7. Capacity of Well: 500 g.p.m. with 5 feet drawdown.
_____ g.p.m. with _____ feet drawdown.

Date of test December 1, 1949

If Flowing Well: Measured discharge _____ g.p.m. on _____
(Date)

Shut-in pressure at ground surface _____ lbs. per sq. in. on _____
(Date)

Water is controlled by _____
(Cap, valve, etc.)

8. Casing: (Give diameter, commercial specifications and depth below ground surface of each casing size.)

10 inch diameter from 25 to 35 feet
inch diameter from to feet
inch diameter from to feet
inch diameter from to feet

Describe and show depth of shoe, plug, adapter, liner or other details:

9. Perforated Casings or Screens:

none from to
(Number per foot and size of perforations, or describe screen)
from to
from to
from to

10. Log of Well: (Describe each stratum or formation clearly, indicate if water bearing, and give thickness and depth as indicated.)

MATERIAL	Thickness (Feet)	Depth to Bottom (Feet)
No record		4

GR-250A

If log of well is not available, give name and address of driller. Pacific Well Drilling Company,
Scappoose, Oregon

11. Infiltration Trench: Covered or open

Dimensions: Length ft. Minimum depth ft. Maximum depth ft.

Bottom width ft. Discharge g.p.m. Date of test

12. Tunnel: Type of lining

Dimensions:
(Length, course, and cross sectional size)

Position of water bearing stratum with reference to portal of tunnel

Log of tunnel: (Preceding table for log of well may be used, if desired. Give footage from portal and character of materials, as pertinent.)

13. Pumping Equipment:

(a) Pump Cock Turbine Capacity 500 g.p.m.
(Make, type and size)

(b) Motor General Electric 15 hp
(Type and horsepower)

14. Location of area irrigated or to be irrigated, or place of use if for purposes other than irrigation.

Township North or South	Range E. or W. of Willamette Meridian	Section	Forty-acre Tract	Number Acres To Be Irrigated	Date of Reclamation
8 N.	6 W	23	Lot 1	<i>Industrial Use</i>	<i>Dec. 1949</i>
8 N.	6 W	22	Lot 1	"	"
8 N.	6 W	22	Lot 2	"	"
8 N.	6 W.	27	NE $\frac{1}{4}$ NE $\frac{1}{4}$	"	"
8 N.	6 W	27	SE $\frac{1}{4}$ NE $\frac{1}{4}$	"	"
8 N.	6 W.	22	SW $\frac{1}{4}$ SE $\frac{1}{4}$	"	"

15. If the ground water supply is supplemental to an existing water supply, identification of any application for a permit, permit, certificate or adjudicated right to appropriate water made or held by the registrant.

Township 8N Range 6W W.M.
North

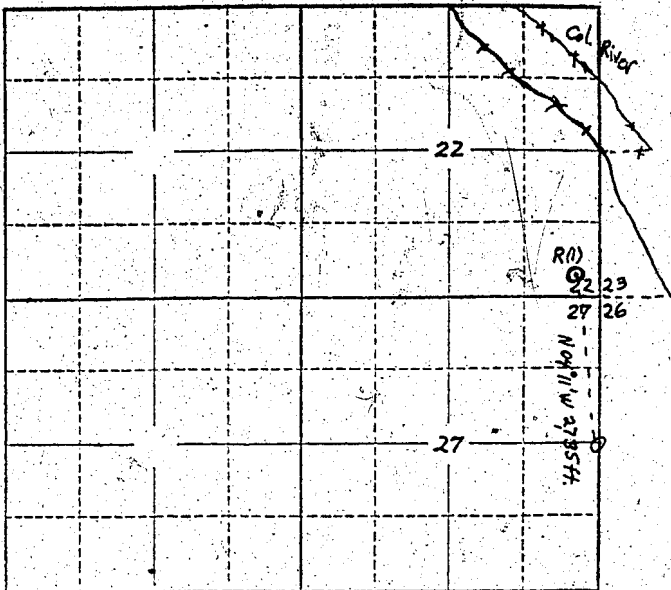

Locate well and acreage of irrigated land on plat.
Scale: 2" = 1 Mile

STATE OF OREGON

County of Clatsop

} ss.

I, W. T. Evenson, being first duly sworn, do hereby certify that I have read the foregoing Registration Statement and that all of the items therein contained are true to the best of my knowledge and belief.

W. T. Evenson
President of Wabuda Lumber Company
(Signature of Registrant)

Subscribed and sworn to before me this 10th day of Oct., 1956

My commission expires Aug. 19, 1959

J. P. [Signature]
(Notary Public)

(SEAL)

CERTIFICATE OF REGISTRATION

STATE OF OREGON

County of Marion

} ss.

This is to certify that the foregoing Registration Statement was received in the office of the State Engineer on the 12th day of October, 1956, at 10:30 o'clock A.M. and has been duly recorded in said office in Book No. 2 of Registration Statements on page GR-250-C

~~Construction completed by X-X-X-X-X-X-X-X-X-X and the water completed by X-X-X-X-X-X-X-X-X-X~~

Witness my hand this 15th day of January, 1957

Lewis A. [Signature]
(State Engineer)

By _____
(Deputy)