

Registration Statement

OF CLAIMANT OF RIGHT TO APPROPRIATE GROUND WATER

TO THE STATE ENGINEER OF OREGON:

I, Lester A. Frost

of Selma County of Josephine

(Mailing address)

State of Oregon, do hereby make application for a certificate of registration as evidence of a right to appropriate ground water.

1. Source from which water is withdrawn is Infiltration Trench
(Flowing well, pump well, infiltration trench, or tunnel)

2. Location is: 3 miles East of Selma, Oregon
(Approximate distance and direction from nearest city or town)

and is more particularly described as follows:

(a) 950 feet North and 100 feet East of the East 1/4 cor. Sec. 18
(Give distance and bearing to corner of section or other legal subdivision)

being within SW 1/4 NW 1/4 of Sec. 17, Twp. 38 S, Rge. 7 W
(Smallest legal subdivision) (N. or S.) (E. or W.)

or (b) within limits of recorded platted property, town or city:

in Lot _____, Block _____ of _____
(Name of plat or addition)

County of _____
(If within city or town, give name)

3. Construction Work was begun on July 1 1949; was completed on July 10, 1949
(Date) (Date)

and the ground water claimed was first used for the purposes set out below on July 20, 1949
(Date)

since which time the water has been used continuously
(Continuously or Intermittently)

from July 20, 1949 to Aug. 1, 1958
(Date) (Date)

4. Quantity of water claimed and used is 900 gallons per minute; 200 acre feet per year.
On farm, with rotation 2.0 c.f.s. On this unit 27 ac. 0.74 c.f.s.

5. Purpose or Purposes for which water is used Irrigation

(Domestic, irrigation, municipal, manufacturing, industrial, etc.)

6. Description of Well: Depth _____ feet. Type _____
(Dug or drilled)

diameter _____ inches. Elevation of ground at well site _____ feet, mean sea level.
(As near as known)

Depth to water table _____ feet.

7. Capacity of Well: _____ g.p.m. with _____ feet drawdown.

_____ g.p.m. with _____ feet drawdown.

Date of test _____

If Flowing Well: Measured discharge _____ g.p.m. on _____
(Date)

Shut-in pressure at ground surface _____ lbs. per sq. in. on _____
(Date)

Water is controlled by _____
(Cap, valve, etc.)

8. **Casing:** (Give diameter, commercial specifications and depth below ground surface of each casing size.)

..... inch diameter	from	to	feet
..... inch diameter	from	to	feet
..... inch diameter	from	to	feet
..... inch diameter	from	to	feet

Describe and show depth of shoe, plug, adapter, liner or other details:

.....

.....

9. **Perforated Casings or Screens:**

.....	from	to
(Number per foot and size of perforations, or describe screen)	from	to
.....	from	to
.....	from	to

10. **Log of Well:** (Describe each stratum or formation clearly, indicate if water bearing, and give thickness and depth as indicated.)

MATERIAL	Thickness (Feet)	Depth to Bottom (Feet)

If log of well is not available, give name and address of driller.....

11. Infiltration Trench: Covered or open open

Dimensions: Length 30 ft. Minimum depth 1 ft. Maximum depth 16 ft.

Bottom width 20 ft. Discharge 900 g.p.m. Date of test July, 1949

(Dropped 4 feet in 1 hr 30 min., then remained

12. Tunnel: Type of lining constant without further drawdown

Dimensions:
(Length, course, and cross sectional size)

Position of water bearing stratum with reference to portal of tunnel

Log of tunnel: (Preceding table for log of well may be used, if desired. Give footage from portal and character of materials, as pertinent.)

13. Pumping Equipment:

(a) Pump 4" centrifugal pump Capacity 900 g.p.m.
(Make, type and size)

(b) Motor Electric motor, E.H.P.
(Type and horsepower)

14. Location of area irrigated or to be irrigated, or place of use if for purposes other than irrigation.

Township North or South	Range E. or W. of Willamette Meridian	Section	Forty-acre Tract	Number Acres To Be Irrigated	Date of Reclamation
38 S	7 W	17	SW 1/4 NW 1/4	4	July, 1949
38 S	7 W	18	SE 1/4 NE 1/4	30	July, 1949
38 S	7 W	18	SW 1/4 NE 1/4	3	July, 1949
Description:					
The West half of D.L.C. of William Guest and Mary Guest, his wife, being Claim No. 40, in Sections 7, 8, 17, 18 in Township 38 South Range 7 West of the Willamette Meridian, in Josephine County, Oregon, Excepting therefrom a tract conveyed to School District No. 43 of Josephine County, Oregon described as follows: Commencing at a point 20 feet North and 30 feet East of the Southwest corner of D.L.C. No. 40, and running thence North 12 rods, East 30 rods, South 12 rods, West 30 rods to the place of beginning.					

15. If the ground water supply is supplemental to an existing water supply, identification of any application for a permit, permit, certificate or adjudicated right to appropriate water made or held by the registrant.

Township 38 S. Range 7 W. W.M.
North

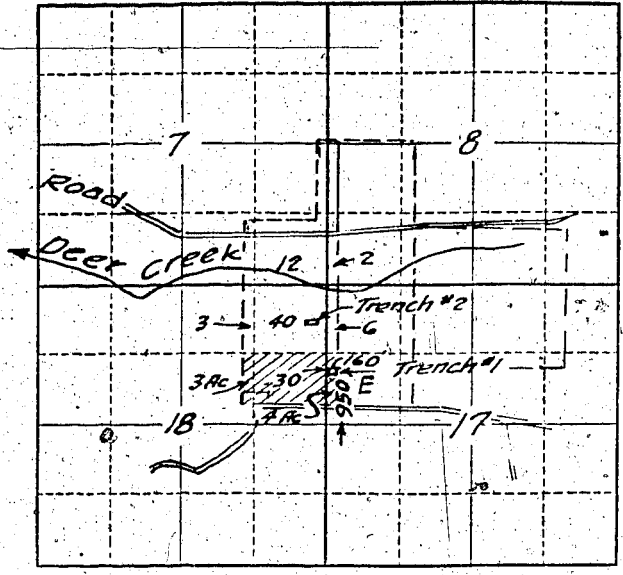

Locate well and acreage of irrigated land on plat.
Scale: 2" = 1 Mile

STATE OF OREGON }
County of Josephine } ss.

Lester A. Frost, being first duly sworn, do hereby certify that I have read the foregoing Registration Statement and that all of the items therein contained are true to the best of my knowledge and belief.

Lester A. Frost
(Signature of Registrant)

Subscribed and sworn to before me this 25th day of July, 1958

My commission expires Feb. 27, 1961

(Notary Public)

(SEAL)

CERTIFICATE OF REGISTRATION

STATE OF OREGON }
County of Marion } ss.

This is to certify that the foregoing Registration Statement was received in the office of the State Engineer on the 5th day of July, 1958, at 5:10 o'clock A. M. and has been duly recorded in said office in Book No. 11 of Registration Statements on page GR-2600

Witness my hand this 6th day of April, 1959

(State Engineer)

By _____
(Deputy)

GR-2600

16-05