

Registration Statement

OF CLAIMANT OF RIGHT TO APPROPRIATE GROUND WATER

TO THE STATE ENGINEER OF OREGON:

I, Olga M. Martensen ~~John~~
of 1700 Beal St Junction City County of Lane
(Mailing address)

State of Oregon, do hereby make application for a certificate of registration as evidence of a right to appropriate ground water.

1. Source from which water is withdrawn is Pump Well
(Flowing well, pump well, infiltration trench, or tunnel)

2. Location is: 1/4 mile N.E. Junction City, Oreg.
(Approximate distance and direction from nearest city or town)

and is more particularly described as follows: 760 feet south & 230 feet east from NW corner 32,

(a) NW 1/4 of NW 1/4 of Sec. 32.
(Give distance and bearing to corner of section or other legal subdivision)

being within NW 1/4 of NW 1/4 of Sec. 32, Twp. 15 S, Rge. 4-W
(Smallest legal subdivision) (S. or S.) (W. or W.)

or (b) within limits of recorded platted property, town or city:

in Lot _____, Block 16 of Milletts Platt
(Name of plat or addition)

County of Lane
(If within city or town, give name)

3. Construction Work was begun on 7/1/48; was completed on 7/1/48
(Date) (Date)

and the ground water claimed was first used for the purposes set out below on 7/1/48
(Date)

since which time the water has been used Intermittently
(Continuously or intermittently)

from 7/1/48 to Oct 1958
(Date) (Date)

4. Quantity of water claimed and used is 150 gallons per minute; 25 acre feet per year.

5. Purpose or Purposes for which water is used Pasture Irrigation
(Domestic, irrigation, municipal, manufacturing, industrial, etc.)

6. Description of Well: Depth 215 feet. Type Driven
(Dug or drilled)

diameter 4" inches. Elevation of ground at well site _____ feet, mean sea level.
(As near as known)

Depth to water table 11 feet.

7. Capacity of Well: 200 g.p.m. with 3.0 feet drawdown.

_____ g.p.m. with _____ feet drawdown.

Date of test 7/1/48

If Flowing Well: Measured discharge _____ g.p.m. on _____
(Date)

Shut-in pressure at ground surface _____ lbs. per sq. in. on _____
(Date)

Water is controlled by _____
(Cap, valve, etc.)

Township 15S Range 9W W.M.
North

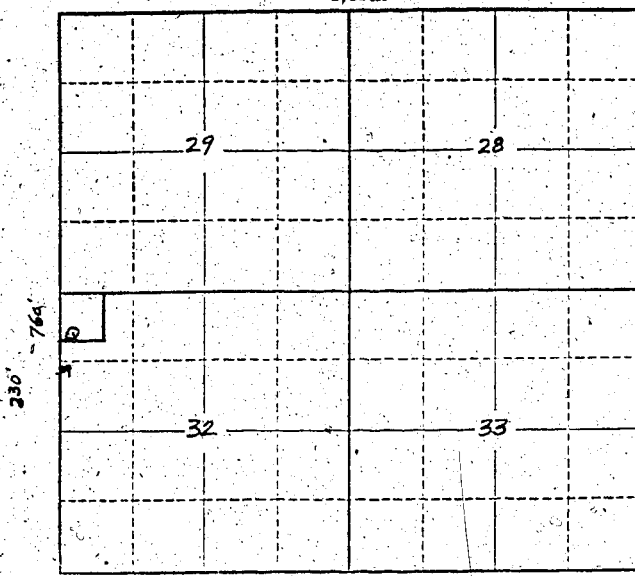

Locate well and acreage of irrigated land on plat.
Scale: 2" = 1 Mile

STATE OF OREGON

County of Marion } ss.

I, Samuel M. ... being first duly sworn, do hereby certify that I have read the foregoing Registration Statement and that all of the items therein contained are true to the best of my knowledge and belief.

Samuel M. ...
(Signature of Registrant)

Subscribed and sworn to before me this 11 day of April, 1959.

My commission expires ... (Notary Public)

(SEAL)

CERTIFICATE OF REGISTRATION

STATE OF OREGON

County of Marion } ss.

This is to certify that the foregoing Registration Statement was received in the office of the State Engineer on the 11 day of April, 1959, at ... o'clock ... M. and has been duly recorded in said office in Book No. 11 of Registration Statements on page GR 2604

Witness my hand this 6th day of April, 1959.

... (State Engineer)

By ... (Deputy)