

Registration Statement

OF CLAIMANT OF RIGHT TO APPROPRIATE GROUND WATER

TO THE STATE ENGINEER OF OREGON:

I, Gas Bucht
of B2 Box 38 Silverton County of Jefferson
(Mailing address)

State of Oregon do hereby make application for a certificate of registration as evidence of a right to appropriate ground water.

1. Source from which water is withdrawn is Pump well
(Flowing well, pump well, infiltration trench, or tunnel)

2. Location is: 3 miles W. of Silverton
(Approximate distance and direction from nearest city or town)

and is more particularly described as follows:

(a) 485' S E 200' E from NW Corner Section 4
(Give distance and bearing to corner of section or other legal subdivision)

being within NW 1/4 NW 1/4 of Sec. 4, Twp. 7S Rge. 1W
(Smallest legal subdivision) (N. or S.) (E. or W.)

or (b) within limits of recorded platted property, town or city:

in Lot _____ Block _____ of _____
(Name of plat or addition)

County of _____
(If within city or town, give name)

3. Construction Work was begun on 1-2-48; was completed on 3-12-48
(Date) (Date)

and the ground water claimed was first used for the purposes set out below on 1948
(Date)

since which time the water has been used Continuously
(Continuously or intermittently)

from April to September
(Date) (Date)

4. Quantity of water claimed and used is _____ gallons per minute; _____ acre feet per year.

5. Purpose or Purposes for which water is used Irrigation
(Domestic, irrigation, municipal, manufacturing, industrial, etc.)

6. Description of Well: Depth 27.6 feet. Type Drilled
(Dug or drilled)

diameter 8 inches. Elevation of ground at well site _____ feet, mean sea level.
(As near-as known)

Depth to water table Not known feet.

7. Capacity of Well: 132 g.p.m. with ? feet drawdown.

_____ g.p.m. with _____ feet drawdown.

Date of test 1948

If Flowing Well: Measured discharge _____ g.p.m. on _____
(Date)

Shut-in pressure at ground surface _____ lbs. per sq. in. on _____
(Date)

Water is controlled by _____
(Cap, valve, etc.)

Township 75 Range 1W, W.M.
North

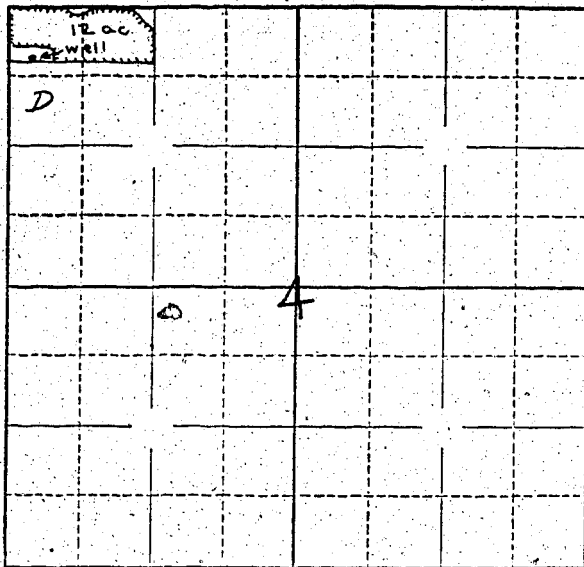

Locate well and acreage of irrigated land on plat.

Scale: ~~1/4~~ - 1 Mile

4"

STATE OF OREGON

County of Marion

} ss.

I, Gus Biehl, being first duly sworn, do hereby certify that I have read the foregoing Registration Statement and that all of the items therein contained are true to the best of my knowledge and belief.

Gus Biehl
(Signature of Registrant)

Subscribed and sworn to before me this 28th day of July, 1958

My commission expires 12th June 1961

Wm. S. Bartholomew
(Notary Public)

(SEAL)

CERTIFICATE OF REGISTRATION

STATE OF OREGON

County of Marion

} ss.

This is to certify that the foregoing Registration Statement was received in the office of the State Engineer on the 28th day of July, 1958, at 12⁰⁰ o'clock A. M. and has been duly recorded in said office in Book No. 11 of Registration Statements on page GR-2605

Witness my hand this 6th day of April, 1959

Wm. A. Stone
(State Engineer)

By

(Deputy)

#15.00