

Registration Statement

OF CLAIMANT OF RIGHT TO APPROPRIATE GROUND WATER

TO THE STATE ENGINEER OF OREGON:

I, Paul and Mamie T. Culbertson
of 1663 South Stage Rd., Medford County of Jackson
(Mailing address)

State of Oregon, do hereby make application for a certificate of registration as evidence of a right to appropriate ground water.

1. Source from which water is withdrawn is a sump
(Flowing well, pump well, infiltration trench, or tunnel)

2. Location is: one mile northeast of Jacksonville
(Approximate distance and direction from nearest city or town)

and is more particularly described as follows:

(a) 2064.77 feet West and 50 feet North of SW corner of NW 1/4 corner
(Give distance and bearing to corner of section or other legal subdivision) of DIC #93,
being within Northeast 1/4 of Southeast 1/4 of Sec. 29 Twp. 37 South Rge. 2 West
and Northwest 1/4 of Southwest 1/4 of Sec. 28, Twp. 37 South Rge. 2 West
(Section, Twp. or Rge.)
or (b) within limits of recorded platted property, town or city:

in Lot _____, Block _____ of _____
(Name of plat or addition)
County of Jackson
(If within city or town, give name)

3. Construction Work was begun on June, 1953; was completed on June, 1953
(Date) (Date)

and the ground water claimed was first used for the purposes set out below on July, 1953
(Date)

since which time the water has been used intermittently
(Continuously or intermittently)

from July, 1953 to July, 1958
(Date) (Date)

4. Quantity of water claimed and used is 1200 gallons per minute; 216 acre feet per year.

5. Purpose or Purposes for which water is used Irrigation

Sump (Domestic, irrigation, municipal, manufacturing, industrial, etc.)

6. Description of Well: Depth 24' feet. Type Dug
(Dug or drilled)

diameter 40' x 30' inches. Elevation of ground at well site 1500 feet, mean sea level.
(As near as known)

Depth to water table 3 feet.

7. Capacity of Well: 1200 g.p.m. with 6 feet drawdown.

 g.p.m. with feet drawdown.

Date of test June, 1953

If Flowing Well: Measured discharge g.p.m. on
(Date)

Shut-in pressure at ground surface lbs. per sq. in. on
(Date)

Water is controlled by
(Cap, valve, etc.)

Township 37 S Range 2 W W.M.
North

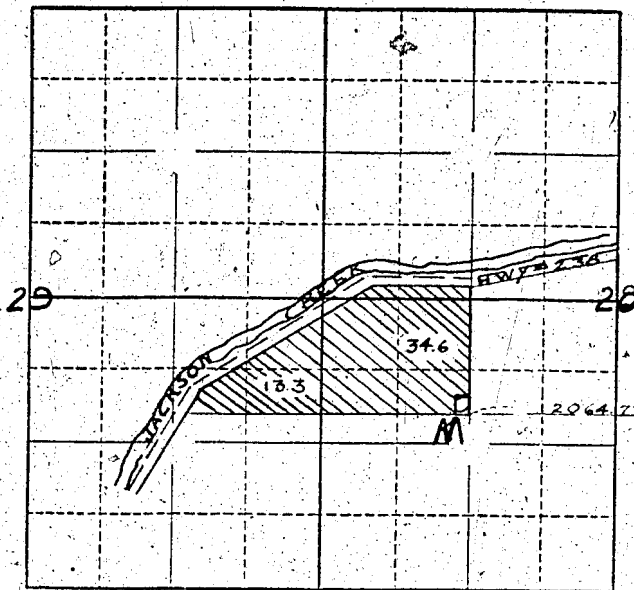

Locate well and acreage of irrigated land on plat.
Scale 4" = 1 Mile

STATE OF OREGON

County of Jackson } ss.
Paul Culbertson and

I, Marie L. Culbertson being first duly sworn, do hereby certify that I have read the foregoing Registration Statement and that all of the items therein contained are true to the best of my knowledge and belief.

Paul Culbertson
(Signature of Registrant)

Subscribed and sworn to before me this 11th day of July, 1958, 19...

My commission expires 1-28-59

(Notary Public)

(SEAL)

CERTIFICATE OF REGISTRATION

STATE OF OREGON } ss.
County of Marion

This is to certify that the foregoing Registration Statement was received in the office of the State Engineer on the 25th day of July, 1958, at 3:00 o'clock A.M. and has been duly recorded in said office in Book No. 11 of Registration Statements on page GR-2628

Witness my hand this 6th day of April, 1959

Arthur H. Hume
(State Engineer)

By _____ (Deputy)

GR - 2628

#1770