

Registration Statement

OF CLAIMANT OF RIGHT TO APPROPRIATE GROUND WATER

TO THE STATE ENGINEER OF OREGON:

I, Arvin A. Burnett

of 17495 S.W. Rigert Road County of Washington
(Mailing address)

State of Oregon, do hereby make application for a certificate of registration as evidence of a right to appropriate ground water.

1. Source from which water is withdrawn is pump well
(Flowing well, pump well, infiltration trench, or tunnel)

2. Location is: 1/2 miles S.W. of Beaverton, Oregon
(Approximate distance and direction from nearest city or town)

and is more particularly described as follows:

(a) 2700 ft. N.W. of S.E. cor. of Sec. 19
(Give distance and bearing to corner of section or other legal subdivision)

being within the N.W. 1/4 of the S.E. 1/4 of Sec. 19 Twp. 1 S Rge. 1 W
(Smallest legal subdivision) (N. or S.) (E. or W.)

or (b) within limits of recorded platted property, town or city: the west 8 acres

in Lot 13, Block _____ of Aldrich Acreage
(Name of plat or addition)

County of Washington

(If within city or town, give name)

3. Construction Work was begun on Sept. 15, 1954; was completed on Nov. 3, 1954
(Date) (Date)

and the ground water claimed was first used for the purposes set out below on April 1, 1955
(Date)

since which time the water has been used continuously
(Continuously or intermittently)

from April, 1955 to Aug. 1, 1958
(Date) (Date)

4. Quantity of water claimed and used is 12 gallons per minute; _____ acre feet per year. Useage tested by Henry B urns, Engineer June 15, 1957

5. Purpose or Purposes for which water is used exempt ~~Domestic and irrigation~~ of .57 acres

(Domestic, irrigation, municipal, manufacturing, industrial, etc.)

6. Description of Well: Depth 283 feet. Type Drilled

(Dug or drilled)

diameter 6 inches. Elevation of ground at well site 350 feet, mean sea level.
(As near as known)

Depth to water table 150 feet.

7. Capacity of Well: 15 g.p.m. with nominal feet drawdown.

_____ g.p.m. with _____ feet drawdown.

Date of test Nov. 4, 1954 by Jack Barron, Well Driller.

If Flowing Well: Measured discharge _____ g.p.m. on _____
(Date)

Shut-in pressure at ground surface _____ lbs. per sq. in. on _____
(Date)

Water is controlled by _____
(Cap, valve, etc.)

Township 1 S Range 1 W W.M.

North

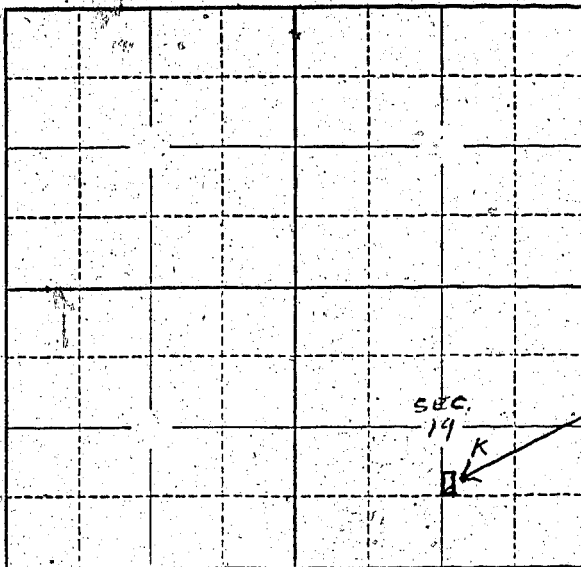

Well and irrigated land

Locate well and acreage of irrigated land on plat.

Scale: 2" = 1 Mile

STATE OF OREGON

County of Multnomah } ss.

I, _____, being first duly sworn, do hereby certify that I have read the foregoing Registration Statement and that all of the items therein contained are true to the best of my knowledge and belief.

Arvin B. [Signature]
(Signature of Registrant)

Subscribed and sworn to before me this 25th day of July, 1958

My commission expires 2/24/59 *Dorothy C. Gady*
(Notary Public)

(SEAL)

CERTIFICATE OF REGISTRATION

STATE OF OREGON } ss.
County of Marion

This is to certify that the foregoing Registration Statement was received in the office of the State Engineer on the 28 day of July, 1958, at 8:00 o'clock A. M. and has been duly recorded in said office in Book No. 11 of Registration Statements on page GR-2636

Witness my hand this 6th day of April, 1959

Lewis W. Standen
(State Engineer)

\$1500

By _____
(Deputy)

GR - 2636