

RECEIVED  
JUL 28 1958  
STATE ENGINEER  
GALLIUM FORMS

Registration No. GR - 2820  
Certificate No. GR 2661

# Registration Statement

## OF CLAIMANT OF RIGHT TO APPROPRIATE GROUND WATER

TO THE STATE ENGINEER OF OREGON:

I, Meadow Land Dairy  
of 16430 S.E. Powell, Portland<sup>34</sup> County of Multnomah  
(Mailing address)  
State of Oregon, do hereby make application for a certificate of registration as evidence  
of a right to appropriate ground water.

1. Source from which water is withdrawn is Pump Well  
(Flowing well, pump well, infiltration trench, or tunnel)
2. Location is: 2 1/2 mi. West of Gresham  
(Approximate distance and direction from nearest city or town)

and is more particularly described as follows:

(a) N. 35° 00' E SW cor Sec 7  
(Give distance and bearing to corner of section or other legal subdivision)  
being within SW 1/4 SW 1/4 of Sec. 7, Twp. 1 S, Rge. 2 E  
(Smallest legal subdivision) (N. or S.) (E. or W.)

or (b) within limits of recorded platted property, town or city:

in Lot \_\_\_\_\_, Block \_\_\_\_\_ of \_\_\_\_\_  
(Name of plat or addition)  
County of \_\_\_\_\_  
(If within city or town, give name)

3. Construction Work was begun on 5 July 1950; was completed on 1 Aug. 1950  
(Date) (Date)  
and the ground water claimed was first used for the purposes set out below on 10 Aug. 1950  
(Date)  
since which time the water has been used intermittent  
(Continuously or intermittently)  
from May to October  
(Date) (Date)

4. Quantity of water claimed and used is 490 gallons per minute; ~~157~~ 181 acre  
feet per year.

5. Purpose or Purposes for which water is used irrigation  
(Domestic, irrigation, municipal, manufacturing, industrial, etc.)

6. Description of Well: Depth 26.1 feet. Type drilled  
(Dug or drilled)  
diameter 12 inches. Elevation of ground at well site 320 feet, mean sea level.  
(As near as known)  
Depth to water table 84 feet.

7. Capacity of Well: 490 g.p.m. with 101 feet drawdown.  
\_\_\_\_\_ g.p.m. with \_\_\_\_\_ feet drawdown.

Date of test 1 Aug. 1950

If Flowing Well: Measured discharge \_\_\_\_\_ g.p.m. on \_\_\_\_\_  
(Date)

Shut-in pressure at ground surface \_\_\_\_\_ lbs. per sq. in. on \_\_\_\_\_  
(Date)

Water is controlled by \_\_\_\_\_  
(Cap, valve, etc.)

8. Casing: (Give diameter, commercial specifications and depth below ground surface of each casing size.)

12 inch diameter from 1 to 261 feet  
 inch diameter from to feet  
 inch diameter from to feet  
 inch diameter from to feet

Describe and show depth of shoe, plug, adapter, liner or other details:

9. Perforated Casings or Screens:

(Number per foot and size of perforations, or describe screen) from 238 to 235  
 from 239 to 243  
 from 248 to 259  
 from to

10. Log of Well: (Describe each stratum or formation clearly, indicate if water bearing, and give thickness and depth as indicated.)

MATERIAL	Thickness (Feet)	Depth to Bottom (Feet)
Clay	19	22
Cement Gravel	42	64
Sand	11	75
Cement Gravel	95	170
Gravel	7660	230
Gravel + Sand	10	240
Coarse Gravel	3	243
Gravel + Fine Sand	2	245
Large Water Bearing Gravel	16	261

If log of well is not available, give name and address of driller. Haakon J. Bottner  
1154 NE GLISAN, PORT. ORE

11. Infiltration Trench: Covered or open \_\_\_\_\_

Dimensions: Length \_\_\_\_\_ ft. Minimum depth \_\_\_\_\_ ft. Maximum depth \_\_\_\_\_ ft.

Bottom width \_\_\_\_\_ ft. Discharge \_\_\_\_\_ g.p.m. Date of test \_\_\_\_\_

12. Tunnel: Type of lining \_\_\_\_\_

Dimensions: \_\_\_\_\_  
(Length, course, and cross sectional size)

Position of water bearing stratum with reference to portal of tunnel \_\_\_\_\_

Log of tunnel: (Preceding table for log of well may be used, if desired. Give footage from portal and character of materials, as pertinent.)

13. Pumping Equipment:

(a) Pump Pomona Turbine Capacity 490 g.p.m.  
(Make, type and size)

(b) Motor 75 Hp. Electric  
(Type and horsepower)

14. Location of area irrigated or to be irrigated, or place of use if for purposes other than irrigation.

Township North or South	Range E. or W. of Willamette Meridian	Section	Forty-acre Tract	Number Acres To Be Irrigated	Date of Reclamation
1S	2E	7	NW $\frac{1}{4}$ SW $\frac{1}{4}$	2.5	Aug 1950
1S	2E	7	SW $\frac{1}{4}$ SW $\frac{1}{4}$	17.5	Aug 1950
1S	2E	7	SE $\frac{1}{4}$ SW $\frac{1}{4}$	34.3	Aug 1950
1S	2E	7	SW $\frac{1}{4}$ SE $\frac{1}{4}$	6.0	Aug 1950
1S	2E	18	NW $\frac{1}{4}$ NW $\frac{1}{4}$	1.3	Aug 1950
1S	2E	18	NE $\frac{1}{4}$ NW $\frac{1}{4}$	9.3	Aug 1950
1S	2E	18	NW $\frac{1}{4}$ NE $\frac{1}{4}$	1.5	Aug 1950
				72.4	

15. If the ground water supply is supplemental to an existing water supply, identification of any application for a permit, permit, certificate or adjudicated right to appropriate water made or held by the registrant.

Township 15 Range 2E, W.M.

North

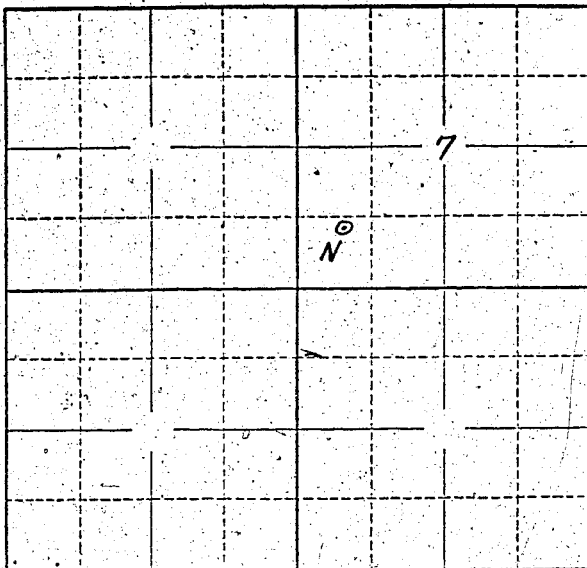

Locate well and acreage of irrigated land on plat.

Scale: 2" = 1 Mile

STATE OF OREGON

County of Multnomah

} ss.

I, Water D. Anderson, being first duly sworn, do hereby certify that I have read the foregoing Registration Statement and that all of the items therein contained are true to the best of my knowledge and belief.

(Signature of Registrant)

Subscribed and sworn to before me this 26 day of July, 1959

My commission expires 10/10/1959

(Notary Public)

(SEAL)

**CERTIFICATE OF REGISTRATION**

STATE OF OREGON

County of Marion

} ss.

This is to certify that the foregoing Registration Statement was received in the office of the State Engineer on the 28th day of July, 1959, at 8:00 o'clock A.M. and has been duly recorded in said office in Book No. 11 of Registration Statements on page GR-2661

Witness my hand this 6th day of April, 1959

(State Engineer)

By

(Deputy)

GR 2661

\$ 21.45