

RECEIVED
JUL 28 1958
STATE ENGINEER
SEASIDE, OREGON

Registration No. GR - 2826

Certificate No. GR. 2665

Registration Statement

OF CLAIMANT OF RIGHT TO APPROPRIATE GROUND WATER

TO THE STATE ENGINEER OF OREGON:

I, Victor S. Madsen

of 61 B. Rt 4 Hillsboro County of Washington

State of Oregon, do hereby make application for a certificate of registration as evidence of a right to appropriate ground water.

1. Source from which water is withdrawn is pump well
(Flowing well, pump well, infiltration trench, or tunnel)

2. Location is: 3 mi. S E from Hillsboro Ore
(Approximate distance and direction from nearest city or town)

and is more particularly described as follows:

(a) approximately 200' S and 100' E from corner
(Give distance and bearing to corner of section or other legal subdivision)

being within N E 1/4 of Sec. 12, Twp. 17, Rge. 23
(Smallest legal subdivision) (N. or S.) (E. or W.)

or (b) within limits of recorded platted property, town or city:

in Lot _____, Block _____ of _____
(Name of plat or addition)

County of Washington
(If within city or town, give name)

3. Construction Work was begun on 3-5-54; was completed on 7-1-54
(Date) (Date)

and the ground water claimed was first used for the purposes set out below on July 1, 1954
(Date)

since which time the water has been used continuously
(Continuously or intermittently)

from July 1, 1954 to present
(Date) (Date)

4. Quantity of water claimed and used is 3.5 gallons per minute; 2.0 acre feet per year.

5. Purpose or Purposes for which water is used exempt
(Domestic, irrigation, municipal, manufacturing, industrial, etc.)

6. Description of Well: Depth 70 feet. Type drilled
(Dug or drilled)

diameter 6 inches. Elevation of ground at well site _____ feet, mean sea level.
(As near as known)

Depth to water table 77 feet.

7. Capacity of Well: 3.5 g.p.m. with _____ feet drawdown.

_____ g.p.m. with _____ feet drawdown.

Date of test 5-17-55

If Flowing Well: Measured discharge _____ g.p.m. on _____
(Date)

Shut-in pressure at ground surface _____ lbs. per sq. in. on _____
(Date)

Water is controlled by _____
(Cap. valve, etc.)

8. Casing: (Give diameter, commercial specifications and depth below ground surface of each casing size.)

12" inch diameter outside casing from 0 to 20 feet
 6 inch diameter inside casing from 0 to 70 feet
 inch diameter from to feet
 inch diameter from to feet

Describe and show depth of shoe, plug, adapter, liner or other details:

packed between casing and below with pea gravel

9. Perforated Casings or Screens:

(Number per foot and size of perforations, or describe screen) from to
 from to
 from to
 from to

10. Log of Well: (Describe each stratum or formation clearly, indicate if water bearing, and give thickness and depth as indicated.)

MATERIAL	Thickness (Feet)	Depth to Bottom (Feet)
Brown sandy clay		
Brown sand	30	60
Gray sand	60	120

If log of well is not available, give name and address of driller.

11. Infiltration Trench: Covered or open

Dimensions: Length ft. Minimum depth ft. Maximum depth ft.

Bottom width ft. Discharge g.p.m. Date of test

12. Tunnel: Type of lining

Dimensions:
(Length, course, and cross sectional size)

Position of water bearing stratum with reference to portal of tunnel

Log of tunnel: (Preceding table for log of well may be used, if desired. Give footage from portal and character of materials, as pertinent.)

13. Pumping Equipment:

(a) Pump Faccuza Jet Capacity 50 g.p.m.
(Make, type and size)

(b) Motor Electric 3 HP
(Type and horsepower)

14. Location of area irrigated or to be irrigated, or place of use if for purposes other than irrigation.

Township North or South	Range E. or W. of Willamette Meridian	Section	Forty-acre Tract	Number Acres To Be Irrigated	Date of Reclamation
19	2W	8	SE 1/4 of NE 1/4	16 ⁰	1957
"	"	"	NE 1/4 of NE 1/4	2 ⁰	"
				18 ⁰ ac	"

15. If the ground water supply is supplemental to an existing water supply, identification of any application for a permit, permit, certificate or adjudicated right to appropriate water made or held by the registrant.

Permit # 24018 P-1826
 Application # 30476 - R-30476

Township 15 Range 2 W, W.M.
North

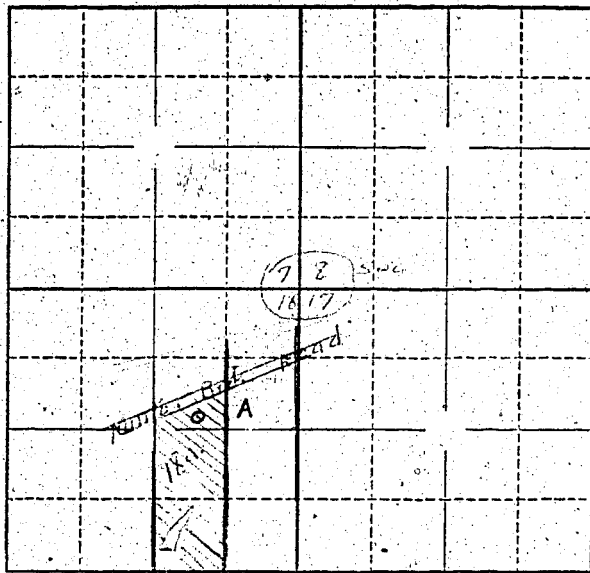

Locate well and acreage of irrigated land on plat.

Scale: $\frac{1}{4}$ " = 1 Mile

$4'' = 1 \text{ mile}$

STATE OF OREGON

County of Washington } ss.

I, Victor S. Madsen, being first duly sworn, do hereby certify that I have read the foregoing Registration Statement and that all of the items therein contained are true to the best of my knowledge and belief.

Victor S. Madsen
(Signature of Registrant)

Subscribed and sworn to before me this 5 day of July, 1958.

My commission expires 1-21-62

Blair M. ...
(Notary Public)

(SEAL)

CERTIFICATE OF REGISTRATION

STATE OF OREGON } ss.
County of Marion

This is to certify that the foregoing Registration Statement was received in the office of the State Engineer on the 28 day of July, 1958, at 8:00 o'clock A.M. and has been duly recorded in said office in Book No. 11 of Registration Statements on page GR-2665

Witness my hand this 6th day of April, 1959.

\$1500

Nura U. ...
(State Engineer)

By _____
(Deputy)