

Registration Statement

OF CLAIMANT OF RIGHT TO APPROPRIATE GROUND WATER

TO THE STATE ENGINEER OF OREGON:

I, Bud Andrews Junction City
of Box 724 Lone Pine Drive County of Lane
(Mailing address)

State of Oregon, do hereby make application for a certificate of registration as evidence of a right to appropriate ground water.

- 1. Source from which water is withdrawn is Pump Well #1
(Flowing well, pump well, infiltration trench, or tunnel)
- 2. Location is: 7 mi. S of Junction City
(Approximate distance and direction from nearest city or town)

and is more particularly described as follows:

(a) 1460' W & 410' N from SW 1/4 Cor Sec 23
(Give distance and bearing to corner of section or other legal subdivision)

being within SW 1/4 of Sec. 23, Twp. 16 S, Rge. 4 W
(Smallest legal subdivision) (N. or S.) (E. or W.)

or (b) within limits of recorded platted property, town or city:

in Lot _____, Block _____ of _____
(Name of plat or addition)

County of _____
(If within city or town, give name)

3. Construction Work was begun on 1944; was completed on 1944
(Date) (Date)

and the ground water claimed was first used for the purposes set out below on 1944
(Date)

since which time the water has been used Continuously
(Continuously or Intermittently)

from May to Oct
(Date) (Date)

4. Quantity of water claimed and used is 300 gallons per minute; 20 acre feet per year.

5. Purpose or Purposes for which water is used Irrigation
(Domestic, irrigation, municipal, manufacturing, industrial, etc.)

6. Description of Well: Depth 25 feet. Type Drone
(Dug or drilled)

diameter 4 inches. Elevation of ground at well site _____ feet, mean sea level.
(As near as known)

Depth to water table 16 feet.

7. Capacity of Well: _____ g.p.m. with _____ feet drawdown.

_____ g.p.m. with _____ feet drawdown.

Date of test _____

If Flowing Well: Measured discharge _____ g.p.m. on _____
(Date)

Shut-in pressure at ground surface _____ lbs. per sq. in. on _____
(Date)

Water is controlled by _____
(Cap, valve, etc.)

8. Casing: (Give diameter, commercial specifications and depth below ground surface of each casing size.)

4" inch diameter *Steel* from 0 to 25 feet
..... inch diameter from to feet
..... inch diameter from to feet
..... inch diameter from to feet

Describe and show depth of shoe, plug, adapter, liner or other details:

9. Perforated Casings or Screens:

Slotted from 22 to 25
(Number per foot and size of perforations, or describe screen)
..... from to
..... from to
..... from to

10. Log of Well: (Describe each stratum or formation clearly, indicate if water bearing, and give thickness and depth as indicated.)

MATERIAL	Thickness (Feet)	Depth to Bottom (Feet)
<i>none</i>		

If log of well is not available, give name and address of driller.

11. Infiltration Trench: Covered or open

Dimensions: Length ft. Minimum depth ft. Maximum depth ft.

Bottom width ft. Discharge g.p.m. Date of test

12. Tunnel: Type of lining

Dimensions:
(Length, course, and cross sectional size)

Position of water bearing stratum with reference to portal of tunnel

Log of tunnel: (Preceding table for log of well may be used, if desired. Give footage from portal and character of materials, as pertinent.)

13. Pumping Equipment:

- (a) Pump ~~Beatty Fair Bank~~ *Beatty Fair Bank* capacity *300* g.p.m.
(Make, type and size)
- (b) Motor *Gas 30 HP*
(Type and horsepower)

14. Location of area irrigated or to be irrigated, or place of use if for purposes other than irrigation.

Township North or South	Range E or W of Willamette Meridian	Section	Forty-acre Tract	Number Acres To Be Irrigated	Date of Reclamation
T 16 S	R 4 W	23	SW/SW	7.0	1944
		26	NW/NW	1.5	"
				8.5	

15. If the ground water supply is supplemental to an existing water supply, identification of any application for a permit, permit, certificate or adjudicated right to appropriate water made or held by the registrant.

Township 16 S Range 4 W W.M.
North

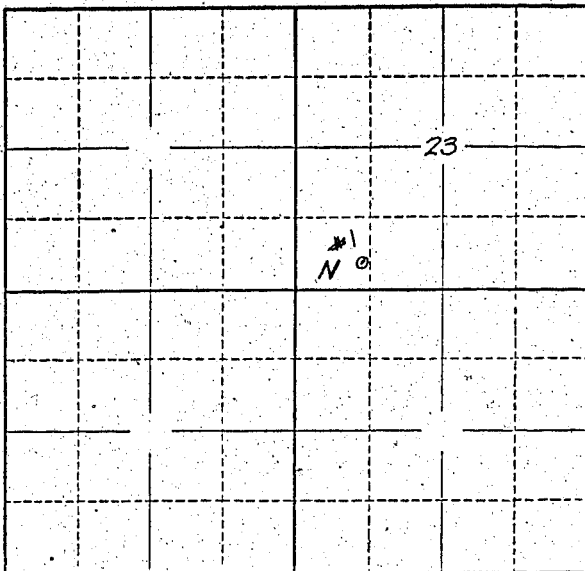

Locate well and acreage of irrigated land on plat.
Scale: 2" = 1 Mile

STATE OF OREGON

County of Marion

ss.

I, Bud Andrews, being first duly sworn, do hereby certify that I have read the foregoing Registration Statement and that all of the items therein contained are true to the best of my knowledge and belief.

Bud Andrews
(Signature of Registrant)

Subscribed and sworn to before me this 1st day of April, 1958.

My commission expires 12th June 1961

Wm. S. Bartholomew
(Notary Public)

(SEAL)

CERTIFICATE OF REGISTRATION

STATE OF OREGON

County of Marion

ss.

This is to certify that the foregoing Registration Statement was received in the office of the State Engineer on the 28th day of July, 1958, at 2:00 o'clock A.M. and has been duly recorded in said office in Book No. 11 of Registration Statements on page GR 2671

Witness my hand this 6th day of April, 1959.

\$15.00

Wm. A. Sholey
(State Engineer)

By

(Deputy)