

Registration Statement

OF CLAIMANT OF RIGHT TO APPROPRIATE GROUND WATER

TO THE STATE ENGINEER OF OREGON:

I, Lyle Trux
104-G Clark Co. Courthouse
of 201-Biarock-Bldg. Vancouver, County of Clark

State of Washington, do hereby make application for a certificate of registration as evidence of a right to appropriate ground water.

Source from which water is withdrawn is Pump Well No. 2
(Flowing well, pump well, infiltration trench, or tunnel)

2. Location is: 5 miles SW of Albany, Oregon
(Approximate distance and direction from nearest city or town)

and is more particularly described as follows:

(a) S. 56° W. 11.0 chains from NE corner of SE 1/4 of S. 29, T. 11 S., R. 4 W.
(Give distance and bearing to corner of section or other legal subdivision)

being within NE 1/4 of SE 1/4 of Sec. 29, Twp. 11 S. Rge. 4 W.
(Smallest legal subdivision) (of or S.) (of or W.)

or (b) within limits of recorded platted property, town or city:

in Lot _____, Block _____ of _____
(Name of plat or addition)

County of Linn
(If within city or town, give name)

3. Construction Work was begun on 1948; was completed on 1948
(Date) (Date)

and the ground water claimed was first used for the purposes set out below on 1948
(Date)

since which time the water has been used continuously
(Continuously or intermittently)

from 1948 to present time
(Date) (Date)

4. Quantity of water claimed and used is 500 gallons per minute; 96.6 acre feet per year.

5. Purpose or Purposes for which water is used Irrigation

(Domestic, irrigation, municipal, manufacturing, industrial, etc.)

6. Description of Well: Depth 25 feet. Type Drilled
(Dug or drilled)

diameter 12 inches. Elevation of ground at well site 200 feet, mean sea level.
(As near as known)

Depth to water table 12 feet.

7. Capacity of Well: _____ g.p.m. with _____ feet drawdown.

_____ g.p.m. with _____ feet drawdown.

Date of test Not tested

If Flowing Well: Measured discharge _____ g.p.m. on _____
(Date)

Shut-in pressure at ground surface _____ lbs. per sq. in. on _____
(Date)

Water is controlled by _____
(Cap. valve, etc.)

Township 11 S Range 4 W W.M.
North

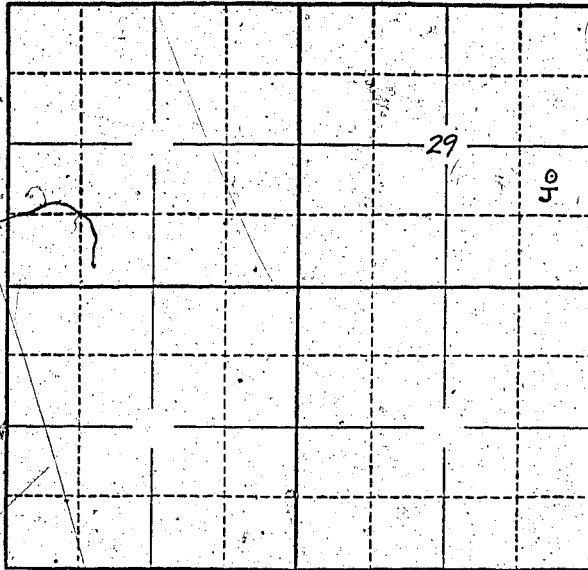

Locate well and acreage of irrigated land on plat.
Scale: 2" = 1 Mile

STATE OF OREGON WASHINGTON
County of Clark } ss.

I, Lyle Truax, being first duly sworn, do hereby certify that I have read the foregoing Registration Statement and that all of the items therein contained are true to the best of my knowledge and belief.

[Handwritten Signature]

(Signature of Registrant)

Subscribed and sworn to before me this 22nd day of April, 1959

My commission expires April 10, 1964 _____
(Notary Public)

(SEAL)

CERTIFICATE OF REGISTRATION

STATE OF OREGON } ss.
County of Marion

This is to certify that the foregoing Registration Statement was received in the office of the State Engineer on the 28th day of July, 1958, at 8:00 o'clock A. M. and has been duly recorded in said office in Book No. 12 of Registration Statements on page GR-2693.

Witness my hand this 25th day of May, 1959.

#15.45

[Handwritten Signature]

(State Engineer)

By _____
(Deputy)