

# Registration Statement

## OF CLAIMANT OF RIGHT TO APPROPRIATE GROUND WATER

TO THE STATE ENGINEER OF OREGON:

I, Lyle Trux  
104-G Clark Co. Courthouse  
 of 204 Blarock Bldg., Vancouver County of Clark  
(Mailing address)

State of Washington, do hereby make application for a certificate of registration as evidence of a right to appropriate ground water.

1. Source from which water is withdrawn is Pump Well No. 4  
(Flowing well, pump well, infiltration trench, or tunnel)

2. Location is: 5 miles SW of Albany, Oregon  
(Approximate distance and direction from nearest city or town)

and is more particularly described as follows:

(a) N. 45° E. 7 chains from SW corner S. 21, T. 11 S., R. 1 W.  
(Give distance and bearing to corner of section or other legal subdivision)  
 being within SW 1/4 of SW 1/4 of Sec. 21, Twp. 11 S., Rge. 1 W.  
(Smallest legal subdivision) (N. or S.) (E. or W.)

or (b) within limits of recorded platted property, town or city:

in Lot \_\_\_\_\_, Block \_\_\_\_\_ of \_\_\_\_\_  
(Name of plat or addition)

County of Linn  
(If within city or town, give name)

3. Construction Work was begun on 1954; was completed on 1954  
(Date) (Date)

and the ground water claimed was first used for the purposes set out below on 1954  
(Date)

since which time the water has been used continuously  
(Continuously or intermittently)

from 1954 to present time  
(Date) (Date)

4. Quantity of water claimed and used is 500 gallons per minute; 87.3 acre feet per year.

5. Purpose or Purposes for which water is used Irrigation

(Domestic, irrigation, municipal, manufacturing, industrial, etc.)

6. Description of Well: Depth 20 feet. Type Drilled  
(Dug or drilled)

diameter 12 inches. Elevation of ground at well site 200 feet, mean sea level.  
(As near as known)

Depth to water table 6 feet.

7. Capacity of Well: \_\_\_\_\_ g.p.m. with \_\_\_\_\_ feet drawdown.

\_\_\_\_\_ g.p.m. with \_\_\_\_\_ feet drawdown.

Date of test Not Tested

If Flowing Well: Measured discharge \_\_\_\_\_ g.p.m. on \_\_\_\_\_  
(Date)

Shut-in pressure at ground surface \_\_\_\_\_ lbs. per sq. in. on \_\_\_\_\_  
(Date)

Water is controlled by \_\_\_\_\_  
(Cap. valve, etc.)





Township 11 S Range 4 W, W.M.  
North

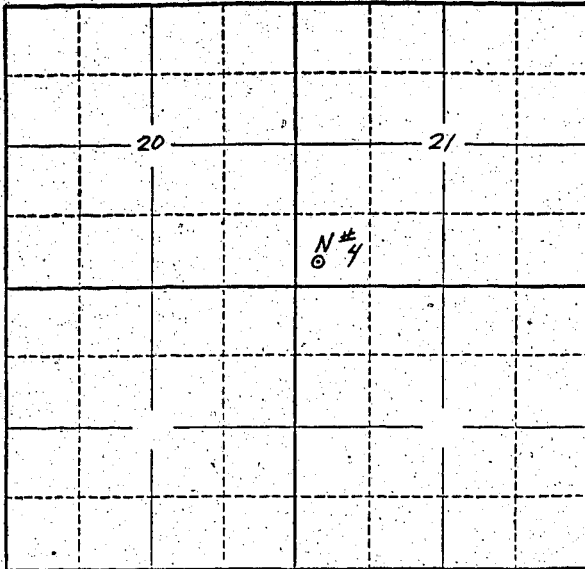

Locate well and acreage of irrigated land on plat.  
Scale: 2" = 1 Mile

STATE OF OREGON WASHINGTON }  
County of Clark } ss.

I, Lyle Truax, being first duly sworn, do hereby certify that I have read the foregoing Registration Statement and that all of the items therein contained are true to the best of my knowledge and belief.

Lyle Truax  
(Signature of Registrant)

Subscribed and sworn to before me this 25th day of July, 1958.

My commission expires Jan 5 1960 (Notary Public)

(SEAL)

**CERTIFICATE OF REGISTRATION**

STATE OF OREGON }  
County of Marion } ss.

This is to certify that the foregoing Registration Statement was received in the office of the State Engineer on the 28th day of July, 1958, at 8:00 o'clock A. M. and has been duly recorded in said office in Book No. 12 of Registration Statements on page GR-2695

Witness my hand this 25th day of May, 1959.

Alva D. Stanley  
(State Engineer)

\$15.00

By \_\_\_\_\_ (Deputy)