

# Registration Statement

## OF CLAIMANT OF RIGHT TO APPROPRIATE GROUND WATER

(Under Chapter 708, Oregon Laws 1955.)

TO THE STATE ENGINEER OF OREGON:

I, Benton A Bayce  
of Central Point County of Jackson  
State of Oregon, do hereby make application for a certificate of registration as evidence of a right to appropriate ground water.

1. Source from which water is withdrawn is Infiltration trench  
(flowing well, pump well, infiltration trench, or tunnel)
2. Location is: 4 miles N.W. of Central Point  
(Approximate distance and direction from nearest city or town)

and is more particularly described as follows:

- (a) 53 feet south and 643 east from the center of sec. 30  
(Give distance and bearing to corner of section or other legal subdivision)  
being within NW 1/4 of SE 1/4 of Sec. 30, Twp. 36 S, Rge. 2 W  
(Simplest legal subdivision) (N. or S.) (E. or W.)
- or (b) within limits of recorded platted property, town or city: \_\_\_\_\_

in Lot \_\_\_\_\_, Block \_\_\_\_\_ of \_\_\_\_\_  
(Name of plat or addition)  
County of Jackson  
(If within city or town, give name)

3. Construction Work was begun on July 1955, was completed on July 1955  
(Date) (Date)  
and the ground water claimed was first used for the purposes set out below on Oct 1957  
(Date)  
since which time the water has been used Intermittently  
(Continuously or Intermittently)  
from Oct 1957 to July '58  
(Date) (Date)

4. Quantity of water claimed and used is 100 gallons per minute; 32 acre feet per year.

5. Purpose or Purposes for which water is used ~~\_\_\_\_\_~~ Irrigation  
(Domestic, irrigation, municipal, manufacturing, industrial, etc.)

6. Description of Well: Depth 18 feet. Type Dug  
(Dug or drilled)  
diameter 26x48 inches. Elevation of ground at well site 1300 feet, mean sea level.  
(As near as known)  
Depth to water table 40 feet.

7. Capacity of Well: \_\_\_\_\_ g.p.m. with \_\_\_\_\_ feet drawdown.  
\_\_\_\_\_ g.p.m. with \_\_\_\_\_ feet drawdown.

Date of test none

If Flowing Well: Measured discharge \_\_\_\_\_ g.p.m. on \_\_\_\_\_  
(Date)

Shut-in pressure at ground surface \_\_\_\_\_ lbs. per sq. in. on \_\_\_\_\_  
(Date)

Water is controlled by \_\_\_\_\_  
(Cap, valve, etc.)





Section 30 5

Township 36 5 Range 2 W W.M. North

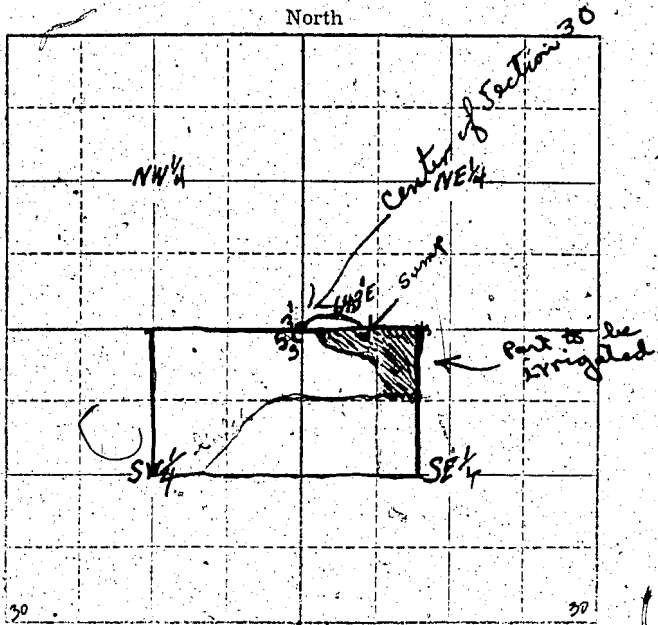

Locate well and acreage of irrigated land on plat.  
Scale: 4" = 1 Mile

STATE OF OREGON

County of Jackson ss.

I, Benton A. Boyce, being first duly sworn, do hereby certify that I have read the foregoing Registration Statement and that all of the items therein contained are true to the best of my knowledge and belief.

Benton A. Boyce  
(Signature of Registrant)

Subscribed and sworn to before me this 26<sup>th</sup> day of July, 1958

My commission expires Jan 9, 1959

(Notary Public)

(SEAL)

CERTIFICATE OF REGISTRATION

STATE OF OREGON

County of Marion ss.

This is to certify that the foregoing Registration Statement was received in the office of the State Engineer on the 25<sup>th</sup> day of July, 1958, at 1.00 o'clock P. M. and has been duly recorded in said office in Book No. 12 of Registration Statements on page GR-2712

~~xxxxxx~~

Witness my hand this 25<sup>th</sup> day of May, 1959

(State Engineer)

By

(Deputy)

GR-2712

\$15.00