

Registration No. GR - 2904

Certificate No. GR - 2733

# Registration Statement

## OF CLAIMANT OF RIGHT TO APPROPRIATE GROUND WATER

TO THE STATE ENGINEER OF OREGON:

I, Bud Andrews

of Box 724 Lone Pine Drive County of Lane

State of Oreg, do hereby make application for a certificate of registration as evidence of a right to appropriate ground water.

1. Source from which water is withdrawn is PUMP WELL #1  
(Flowing well, pump well, infiltration trench, or tunnel)

2. Location is: 6.5 from Junction City  
(Approximate distance and direction from nearest city or town)

and is more particularly described as follows:

(a) 1340' S & 1110' E from the W 1/4 Cor Sec 22  
(Give distance and bearing to corner of section or other legal subdivision)

being within SW/4 SW of Sec. 22, Twp. 16 S, Rge. 4 W  
(Smallest legal subdivision) (N. or S.) (E. or W.)

or (b) within limits of recorded platted property, town or city:

in Lot \_\_\_\_\_, Block \_\_\_\_\_ of \_\_\_\_\_  
(Name of plat or addition)

County of \_\_\_\_\_  
(If within city or town, give name)

3. Construction Work was begun on 1954; was completed on 1954  
(Date) (Date)

and the ground water claimed was first used for the purposes set out below on 1954  
(Date)

since which time the water has been used Continuously  
(Continuously or Intermittently)

from May to Oct  
(Date) (Date)

4. Quantity of water claimed and used is 300 gallons per minute; 40 acre feet per year.

5. Purpose or Purposes for which water is used Irrigation  
(Domestic, irrigation, municipal, manufacturing, industrial, etc.)

6. Description of Well: Depth 2.5 feet. Type drive  
(Dug or drilled)

diameter 4" inches. Elevation of ground at well site \_\_\_\_\_ feet, mean sea level.

Depth to water table 16 feet.  
(As near as known)

7. Capacity of Well: \_\_\_\_\_ g.p.m. with \_\_\_\_\_ feet drawdown.

\_\_\_\_\_ g.p.m. with \_\_\_\_\_ feet drawdown.

Date of test \_\_\_\_\_

If Flowing Well: Measured discharge \_\_\_\_\_ g.p.m. on \_\_\_\_\_  
(Date)

Shut-in pressure at ground surface \_\_\_\_\_ lbs. per sq. in. on \_\_\_\_\_  
(Date)

Water is controlled by \_\_\_\_\_  
(Cap. valve, etc.)



If log of well is not available, give name and address of driller. ....

11. Infiltration Trench: Covered or open .....

Dimensions: Length ..... ft. Minimum depth ..... ft. Maximum depth ..... ft.  
 Bottom width ..... ft. Discharge ..... g.p.m. Date of test .....

12. Tunnel: Type of lining .....

Dimensions: .....  
(Length, course, and cross sectional size)  
 Position of water bearing stratum with reference to portal of tunnel .....

Log of tunnel: (Preceding table for log of well may be used, if desired. Give footage from portal and character of materials, as pertinent.)

13. Pumping Equipment:

(a) Pump Berkley Centrifugal Capacity 300 g.p.m.  
(Make, type and size)  
 (b) Motor 10 HP Elect 3 Ph.  
(Type and horsepower)

14. Location of area irrigated or to be irrigated, or place of use if for purposes other than irrigation.

Township North or South	Range E. or W. of Willamette Meridian	Section	Forty-acre Tract	Number Acres To Be Irrigated	Date of Reclamation
16 S	4 W	22	SW/SW	12.5	1954
"	"	"	SE/SW	4.3	1954
				16.8	

*Description of Property for Well # 1*

Beginning at a point 1571.0 feet East of a point 648.6 feet South of a point 6600 feet West of the Northwest corner of the George W Evans Donation Land Claim No. 46, in Townships 16 South, Range 4 West of the Willamette Meridian, and running thence South 638.0 feet, thence North 89° 37' East 1510.0 feet, thence North 628.0 feet, thence West 1510.0 feet to the point of beginning, in Land County, Oregon.

15. If the ground water supply is supplemental to an existing water supply, identification of any application for a permit, permit, certificate or adjudicated right to appropriate water made or held by the registrant.

Township 16 S Range 4 W, W.M.  
North

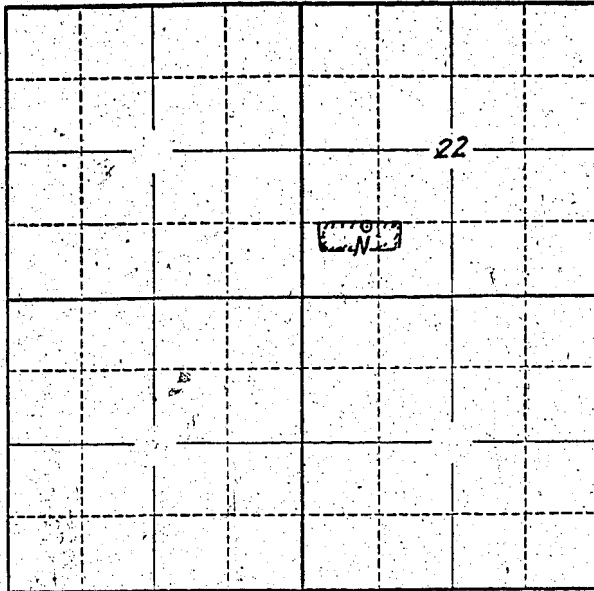

Locate well and acreage of irrigated land on plat.  
Scale: 2" = 1 Mile

STATE OF OREGON

County of Marion } ss.

I, Bud Andrews being first duly sworn, do hereby certify that I have read the foregoing Registration Statement and that all of the items therein contained are true to the best of my knowledge and belief.

Bud Andrews  
(Signature of Registrant)

Subscribed and sworn to before me this 1st day of April, 19 58

My commission expires 12th June 1961 Wm S. Bartholomew  
(Notary Public)

(SEAL)

**CERTIFICATE OF REGISTRATION**

STATE OF OREGON

County of Marion } ss.

This is to certify that the foregoing Registration Statement was received in the office of the State Engineer on the 22nd day of July, 1958, at 8:00 o'clock A.M. and has been duly recorded in said office in Book No. 12 of Registration Statements on page GR-2733.

Witness my hand this 25th day of May, 19 59

Lewis A. Sterling  
(State Engineer)

By \_\_\_\_\_  
(Deputy)

GR - 2733

\$15.00