

124 Levy
RECEIVED
JUL 9 1958
STATE ENGINEER
SALEM, OREGON

Registration No. GR - 2912

Certificate No. GR - 2741

Registration Statement

OF CLAIMANT OF RIGHT TO APPROPRIATE GROUND WATER

TO THE STATE ENGINEER OF OREGON:

I, EARL OLIVER

of Box 690 Canby

(Mailing address)

County of CLATSOP

State of ORE. do hereby make application for a certificate of registration as evidence of a right to appropriate ground water.

1. Source from which water is withdrawn is PUMP #2

(Flowing well, pump well, infiltration trench, or tunnel)

2. Location is: IN CITY LIMITS

(Approximate distance and direction from nearest city or town)

and is more particularly described as follows:

(a) N 81° 46' W 607.3 ft from S.E. Cor Charming Pendleton D.W.C.

(Give distance and bearing to corner of section or other legal subdivision)

being within NW 1/4 NW 1/4 of Sec. 33, Twp. 3S, Rge. 1E

(Smallest legal subdivision)

(N. or S.)

(E. or W.)

or (b) within limits of recorded platted property, town or city:

in Lot _____, Block _____ of _____

(Name of plat or addition)

County of _____

(If within city or town, give name)

3. Construction Work was begun on unknown; was completed on no date

(Date)

(Date)

and the ground water claimed was first used for the purposes set out below on 1925

(Date)

since which time the water has been used Irrigation Seasons

(Continuously or intermittently)

from 1925 to Present

(Date)

(Date)

4. Quantity of water claimed and used is 85 gallons per minute; 32 acre feet per year.

5. Purpose or Purposes for which water is used irrigation E.O.

(Domestic, irrigation, municipal, manufacturing, industrial, etc.)

6. Description of Well: Depth appr. 135 feet. Type dilled

(Dug or drilled)

diameter 6" inches. Elevation of ground at well site 150' feet, mean sea level.

(As near as known)

Depth to water table _____ feet.

7. Capacity of Well: appr. 85 g.p.m. with no data feet drawdown.

_____ g.p.m. with _____ feet drawdown.

Date of test no data

If Flowing Well: Measured discharge _____ g.p.m. on _____

(Date)

Shut-in pressure at ground surface _____ lbs. per sq. in. on _____

(Date)

Water is controlled by _____

(Cap, valve, etc.)

8. Casing: (Give diameter, commercial specifications and depth below ground surface of each casing size.)

6" inch diameter from 0 to approx. 185 feet
 inch diameter from to feet
 inch diameter from to feet
 inch diameter from to feet

Describe and show depth of shoe, plug, adapter, liner or other details: *no data*

9. Perforated Casings or Screens:

(Number per foot and size of perforations, or describe screen) from to
no data { from to
 from to
 from to

10. Log of Well: (Describe each stratum or formation clearly, indicate if water bearing, and give thickness and depth as indicated.)

MATERIAL	Thickness (Feet)	Depth to Bottom (Feet)
<i>no data</i>		

If log of well is not available, give name and address of driller. Not known

11. Infiltration Trench: Covered or open

Dimensions: Length ft. Minimum depth ft. Maximum depth ft.

Bottom width ft. Discharge g.p.m. Date of test

12. Tunnel: Type of lining

Dimensions:
(Length, course, and cross sectional size)

Position of water bearing stratum with reference to portal of tunnel

Log of tunnel: (Preceding table for log of well may be used, if desired. Give footage from portal and character of materials, as pertinent.)

13. Pumping Equipment:

(a) Pump Turbine Capacity 85 g.p.m.
(Make, type and size)

(b) Motor 5 HP Electric
(Type and horsepower)

14. Location of area irrigated or to be irrigated, or place of use if for purposes other than irrigation.

Township North or South	Range E. or W. of Willamette Meridian	Section	Forty-acre Tract	Number Acres To Be Irrigated	Date of Reclamation
35	1E	33	SWNW	11.72	1925

15. If the ground water supply is supplemental to an existing water supply, identification of any application for a permit, permit, certificate or adjudicated right to appropriate water made or held by the registrant.

None

Township ~~35~~ ³⁸ Range ~~1E~~ ^{1E}, W.M.
North

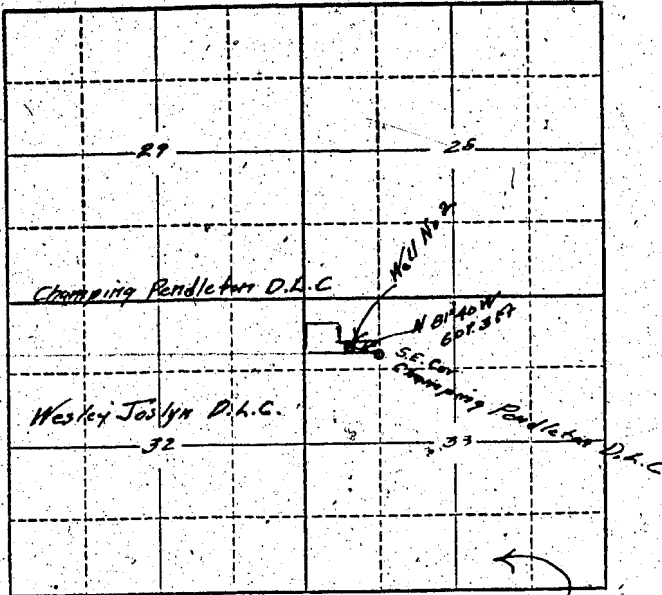

Locate well and acreage of irrigated land on plat.
Scale: 2" = 1 Mile

See Enclosed Detail Map.

STATE OF OREGON

County of Clackamas } ss.

I, Earl Oliver, being first duly sworn, do hereby certify that I have read the foregoing Registration Statement and that all of the items therein contained are true to the best of my knowledge and belief.

Earl Oliver
(Signature of Registrant)

Subscribed and sworn to before me this 26th day of July, 1958

My commission expires Feb. 15, 1960 John H. Neumann
(Notary Public)

(SEAL)

CERTIFICATE OF REGISTRATION

STATE OF OREGON

County of Marion } ss.

This is to certify that the foregoing Registration Statement was received in the office of the State Engineer on the 29th day of July, 1958, at 9:45 o'clock A. M. and has been duly recorded in said office in Book No. 12 of Registration Statements on page GR-2741

Witness my hand this 25th day of May, 1959

Lucre A. Stanley
(State Engineer)

By _____ (Deputy)

GR - 2741

15.00