

# Registration Statement

## OF CLAIMANT OF RIGHT TO APPROPRIATE GROUND WATER

TO THE STATE ENGINEER OF OREGON:

I, Louise H. Johnston  
of Rt. 1 Box 99 Jefferson County of Morion  
(Mailing address)

State of Oregon do hereby make application for a certificate of registration as evidence of a right to appropriate ground water.

1. Source from which water is withdrawn is Pump Well  
(Flowing well, pump well, infiltration trench, or tunnel)

2. Location is: \_\_\_\_\_  
(Approximate distance and direction from nearest city or town)

and is more particularly described as follows:

(a) 1128 ft. East & 462 ft. North from S.W. corner of Sec. 18  
(Give distance and bearing to corner of section or other legal subdivision)  
being within SW 1/4 of 37 1/2 of Sec. 18, Twp. 9 S, Rge. 3 W  
(Smallest legal subdivision) (N. or S.) (E. or W.)

or (b) within limits of recorded platted property, town or city: \_\_\_\_\_

in Lot \_\_\_\_\_, Block \_\_\_\_\_ of \_\_\_\_\_  
(Name of plat or addition)  
County of \_\_\_\_\_  
(If within city or town, give name)

3. Construction Work was begun on Mar. 5, 1953; was completed on Mar. 26, 1953  
(Date) (Date)

and the ground water claimed was first used for the purposes set out below on May 1953  
(Date)

since which time the water has been used intermittently  
(Continuously or intermittently)

from May 1953 to present  
(Date) (Date)

4. Quantity of water claimed and used is 154 gallons per minute; 137 1/2 acre feet per year.

5. Purpose or Purposes for which water is used irrigation  
(Domestic, irrigation, municipal, manufacturing, industrial, etc.)

6. Description of Well: Depth 50 feet. Type Drilled  
(Dug or drilled)

diameter 10 inches. Elevation of ground at well site \_\_\_\_\_ feet, mean sea level.  
(As near as known)

Depth to water table 26 feet.

7. Capacity of Well: 135 g.p.m. with 19 feet drawdown.

\_\_\_\_\_ g.p.m. with \_\_\_\_\_ feet drawdown.

Date of test Mar. 26, 1953

If Flowing Well: Measured discharge \_\_\_\_\_ g.p.m. on \_\_\_\_\_  
(Date)

Shut-in pressure at ground surface \_\_\_\_\_ lbs. per sq. in. on \_\_\_\_\_  
(Date)

Water is controlled by \_\_\_\_\_  
(Cap, valve, etc.)

8. Casing: (Give diameter, commercial specifications and depth below ground surface of each casing size.)

10 inch diameter *steel well casing* from 0 to 50 feet  
inch diameter from to feet  
inch diameter from to feet  
inch diameter from to feet

Describe and show depth of shoe, plug, adapter, liner or other details: \_\_\_\_\_  
\_\_\_\_\_  
\_\_\_\_\_

9. Perforated Casings or Screens:

$\frac{1}{2}$ " x 12" 6 per foot from 41 to 50  
(Number per foot and size of perforations, or describe screen)  
from to  
from to  
from to

10. Log of Well: (Describe each stratum or formation clearly, indicate if water bearing, and give thickness and depth as indicated.)

MATERIAL	Thickness (Feet)	Depth to Bottom (Feet)
Topsoil	3	3
Hardpan	1	4
Blue clay	34	38
silt & sand	3	41
Gravel	9	50
Blue clay	5+	—

If log of well is not available, give name and address of driller, .....

11. Infiltration Trench: Covered or open .....

Dimensions: Length ..... ft. Minimum depth ..... ft. Maximum depth ..... ft.

Bottom width ..... ft. Discharge ..... g.p.m. Date of test .....

12. Tunnel: Type of lining .....

Dimensions: .....  
(Length, course, and cross sectional size)

Position of water bearing stratum with reference to portal of tunnel .....

Log of tunnel: (Preceding table for log of well may be used, if desired. Give footage from portal and character of materials, as pertinent.)

13. Pumping Equipment:

(a) Pump ..... *8" Deep well turbine* ..... Capacity *150* g.p.m.  
(Make, type and size)

(b) Motor ..... *7 1/2 HP electric* .....  
(Type and horsepower)

14. Location of area irrigated or to be irrigated, or place of use if for purposes other than irrigation.

Township North or South	Range E. or W. of Willamette Meridian	Section	Forty-acre Tract	Number Acres To Be Irrigated	Date of Reclamation
95	3 W	18	SW 1/4 of SW 1/4	8.8	May 1953
95	3 W	18	SE 1/4 of SW 1/4	19.7	"
95	3 W	19	NW 1/4 of NW 1/4	2.6	"
95	3 W	19	NE 1/4 of NW 1/4	15.7	"
95	3 W	18	SW 1/4 of <sup>SE</sup> SW 1/4	4	"
				<u>47.2</u>	

15. If the ground water supply is supplemental to an existing water supply, identification of any application for a permit, permit, certificate or adjudicated right to appropriate water made or held by the registrant.

Township 9.5 Range 3W, W.M.  
North

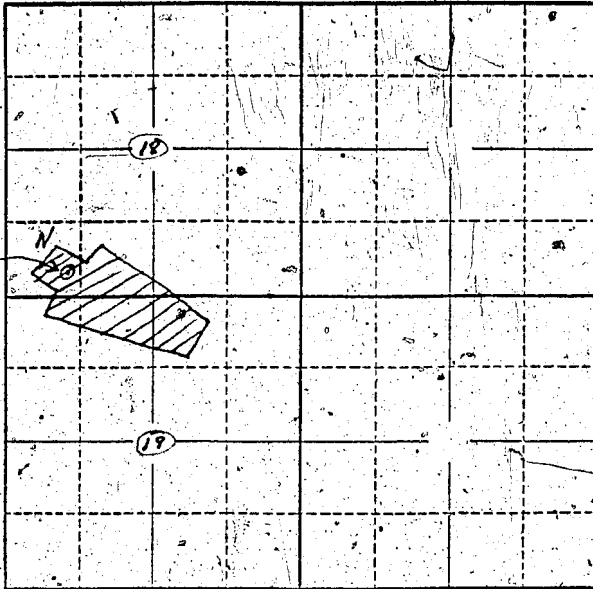

Locate well and acreage of irrigated land on plat.  
Scale: 2" = 1 Mile

STATE OF OREGON

County of MARION

ss.

I, Louise H. Johnston, being first duly sworn, do hereby certify that I have read the foregoing Registration Statement and that all of the items therein contained are true to the best of my knowledge and belief.

Louise H. Johnston  
(Signature of Registrant)

Subscribed and sworn to before me this 13th day of March, 1958

My commission expires April 3, 1961.

A. M. Rothlin  
(Notary Public for Oregon)

(SEAL)

**CERTIFICATE OF REGISTRATION**

STATE OF OREGON

County of Marion

ss.

This is to certify that the foregoing Registration Statement was received in the office of the State Engineer on the 29th day of July, 1958, at 10:40 o'clock A.M. and has been duly recorded in said office in Book No. 12 of Registration Statements on page GR 2749

Witness my hand this 25th day of May, 1959

Lawrence A. Stanley  
(State Engineer)

By \_\_\_\_\_  
(Deputy)

\$ 17.70