

Registration Statement

OF CLAIMANT OF RIGHT TO APPROPRIATE GROUND WATER

TO THE STATE ENGINEER OF OREGON:

I, Ray O. Schulz
 of 1005 W. 1st Junction City County of Lane
(Mailing address)
 State of Oregon, do hereby make application for a certificate of registration as evidence of a right to appropriate ground water.

1. Source from which water is withdrawn is Driven
(Flowing well, pump well, infiltration trench, or tunnel)

2. Location is: One mile S and W from Junction City
(Approximate distance and direction from nearest city or town)

and is more particularly described as follows:

(a) 250 ft. S. & 720 ft. W. from the NE corner of Section 6
(Give distance and bearing to corner of section or other legal subdivision)

being within NE 1/4 NE 1/4 of Sec. 6, Twp. 16 S, Rge. 4 W
(Smallest legal subdivision) (N. or S.) (E. or W.)

or (b) within limits of recorded platted property, town or city:

in Lot _____, Block _____ of _____
(Name of plat or addition)

County of _____
(If within city or town, give name)

3. Construction Work was begun on unknown; was completed on unknown
(Date) (Date)

and the ground water claimed was first used for the purposes set out below on July 1951
(Date)

since which time the water has been used Intermittently
(Continuously or Intermittently)

from July 1951 to Oct 1958
(Date) (Date)

4. Quantity of water claimed and used is 50 gallons per minute; 5 acre feet per year.

5. Purpose or Purposes for which water is used Irrigation
(Domestic, irrigation, municipal, manufacturing, industrial, etc.)

6. Description of Well: Depth 29 feet. Type Driven
(Dug or drilled)

diameter 4 inches. Elevation of ground at well site _____ feet, mean sea level.
(As near as known)

Depth to water table 19 feet.

7. Capacity of Well: _____ g.p.m. with _____ feet drawdown.

_____ g.p.m. with _____ feet drawdown.

Date of test _____

If Flowing Well: Measured discharge _____ g.p.m. on _____
(Date)

Shut-in pressure at ground surface _____ lbs. per sq. in. on _____
(Date)

Water is controlled by _____
(Cap, valve, etc.)

Township 16 S Range 4 W, W.M.
North

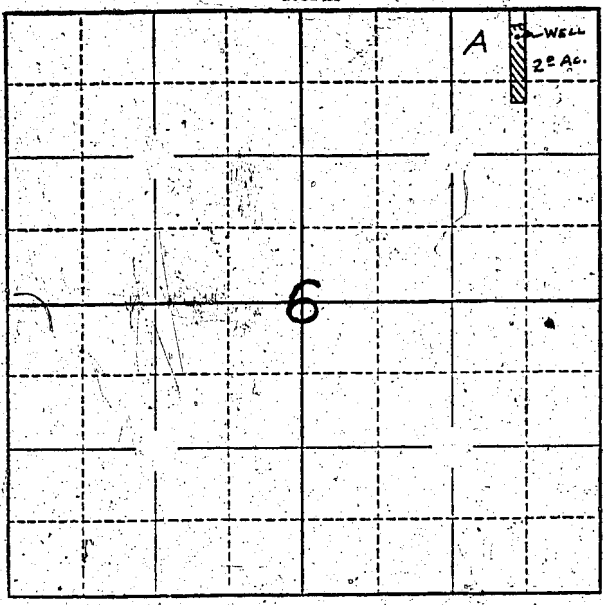

Locate well and acreage of irrigated land on plat.

Scale: $\frac{1}{4}$ - 1 Mile

STATE OF OREGON

County of here } ss.

I, Ray D. Schub, being first duly sworn, do hereby certify that I have read the foregoing Registration Statement and that all of the items therein contained are true to the best of my knowledge and belief.

Ray D. Schub
(Signature of Registrant)

Subscribed and sworn to before me this 26th day of July, 1958.

My commission expires 8-27-61

B. J. Schub
(Notary Public)

(SEAL)

CERTIFICATE OF REGISTRATION

STATE OF OREGON

County of Marion } ss.

This is to certify that the foregoing Registration Statement was received in the office of the State Engineer on the 29th day of July, 1958, at 8:00 o'clock A.M. and has been duly recorded in said office in Book No. 12 of Registration Statements on page GR-2755

Witness my hand this 25th day of May, 1959.

Lewis A. Stanley
(State Engineer)

By _____ (Deputy)

GR - 2755

#15.02