

Registration Statement

OF CLAIMANT OF RIGHT TO APPROPRIATE GROUND WATER

RECEIVED
JAN 29 1950

STATE ENGINEER
SALEM, OREGON

TO THE STATE ENGINEER OF OREGON:

I, John Thomas Miller

of P.O. Bx 198, Aurora Ore.
(Mailing address)

County of Marion

State of Oregon, do hereby make application for a certificate of registration as evidence of a right to appropriate ground water.

1. Source from which water is withdrawn is Pump Well
(Flowing well, pump well, infiltration trench, or tunnel)

2. Location is: Approximate 650 ft. NW of Aurora
(Approximate distance and direction from nearest city or town)

and is more particularly described as follows: 1200 feet north & 730 feet east from SW ^{Corner} of Section 12.

(a) (Willamette Meridian)
(Give distance and bearing to corner of section or other legal subdivision)

being within SW 1/4 of SD 14 of Sec. 12, Twp. 4 S, Rge. 1 W
(Smallest legal subdivision) (N. or S.) (E. or W.)

or (b) within limits of recorded platted property, town or city:

in Lot _____ Block _____ of _____
(Name of plat or addition)

County of Marion
(If within city or town, give name)

3. Construction Work was begun on 5-1-52; was completed on 5-10-52
(Date) (Date)

and the ground water claimed was first used for the purposes set out below on 5-15-52
(Date)

since which time the water has been used Continuously
(Continuously or intermittently)
from 1952 to 1959
(Date) (Date)

4. Quantity of water claimed and used is ### 90 gallons per minute; 5 1/2 acre feet per year.

5. Purpose or Purposes for which water is used Irrigation ~~land~~, ~~and~~ ~~for~~ ~~plants~~
(Domestic, irrigation, municipal, manufacturing, industrial, etc.)

6. Description of Well: Depth 68 feet. Type Drilled
(Dug or drilled)
diameter 10 inches. Elevation of ground at well site est. 140 feet, mean sea level.
(As near as known)

Depth to water table 20 feet.

7. Capacity of Well; 280 g.p.m. with 45 feet drawdown.
_____ g.p.m. with _____ feet drawdown.

Date of test 5-10-52

If Flowing Well: Measured discharge _____ g.p.m. on _____
(Date)

Shut-in pressure at ground surface _____ lbs. per sq. in. on _____
(Date)

Water is controlled by _____
(Cap, valve, etc.)

Township 45 Range 1W, W.M.
North

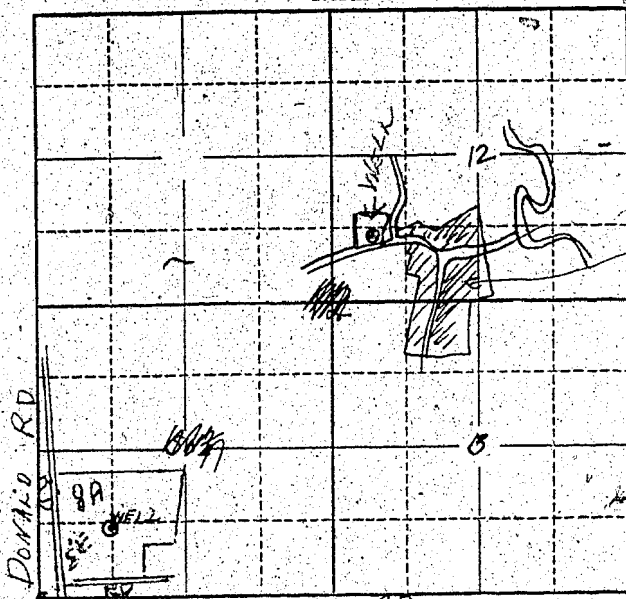

Locate well and acreage of irrigated land on plat.

Scale: 1 Mile

STATE OF OREGON

County of Marion } ss.

I, J. T. Miller, being first duly sworn, do hereby certify that I have read the foregoing Registration Statement and that all of the items therein contained are true to the best of my knowledge and belief.

J. T. Miller
(Signature of Registrant)

Subscribed and sworn to before me this 28 day of July, 1958.

My commission expires Jan. 15, 1961

Raymond J. ...
(Notary Public)

(SEAL)

CERTIFICATE OF REGISTRATION

STATE OF OREGON } ss.
County of Marion

This is to certify that the foregoing Registration Statement was received in the office of the State Engineer on the 29 day of July, 1958, at 8:00 o'clock A. M. and has been duly recorded in said office in Book No. 16 of Registration Statements on page GR-3919

Witness my hand this 15th day of February, 1960

Lewis A. Stanley
(State Engineer)

By _____ (Deputy)

#1500

GR 3919