

Registration Statement

OF CLAIMANT OF RIGHT TO APPROPRIATE GROUND WATER

TO THE STATE ENGINEER OF OREGON:

I, R.W. Berg & Ellen Berg

of Rt. #1, Box 9A County of Washington

State of Oregon, do hereby make application for a certificate of registration as evidence of a right to appropriate ground water.

1. Source from which water is withdrawn is Pump well
(Flowing well, pump well, infiltration trench, or tunnel)

2. Location is: 1 1/2 mile East Sherwood on Tualatin Road
(Approximate distance and direction from nearest city or town)

and is more particularly described as follows: 1650 feet North & 1680 feet east from SW Corner Sec. 28,

(a) 1/2 Mile N.E. of S.W. Corner Section 28.
(Give distance and bearing to corner of section or other legal subdivision)

being within NE 1/4 of SW 1/4 of Sec. 28, Twp. 2S., Rge. 1W.
(Smallest legal subdivision) (N. or S.) (E. or W.)

or (b) within limits of recorded platted property, town or city:

in Lot _____, Block _____ of _____
(Name of plat or addition)

County of _____
(If within city or town, give name)

3. Construction Work was begun on 4-7-55; was completed on 4-10-55
(Date) (Date)

and the ground water claimed was first used for the purposes set out below on 4-10-55
(Date)

since which time the water has been used Continuously
(Continuously or intermittently)

from 4-10-55 to 7-28-58
(Date) (Date)

4. Quantity of water claimed and used is 21 gallons per minute; _____ acre feet per year.

5. Purpose or Purposes for which water is used irrigation

(Domestic, irrigation, municipal, manufacturing, industrial, etc.)

6. Description of Well: Depth 80ft. feet. Type drilled
(Dug or drilled)

diameter 6 inches. Elevation of ground at well site _____ feet, mean sea level.
(As near as known)

Depth to water table 55 feet.

7. Capacity of Well: 55-60 g.p.m. with 15 feet drawdown.

_____ g.p.m. with _____ feet drawdown.

Date of test 11-20-55

If Flowing Well: Measured discharge _____ g.p.m. on _____
(Date)

Shut-in pressure at ground surface _____ lbs. per sq. in. on _____
(Date)

Water is controlled by _____
(Cap, valve, etc.)

Sec. 28

25

Township

~~26~~

Range

1W

W.M.

North

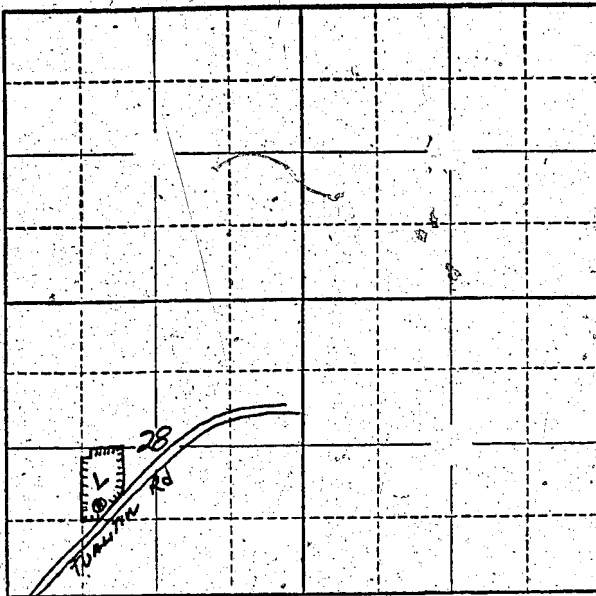

Locate well and acreage of irrigated land on plat.

Scale: 2" = 1 Mile

STATE OF OREGON

County of Washington

ss.

I, Rudolph W. Berg, being first duly sworn, do hereby certify that I have read the foregoing Registration Statement and that all of the items therein contained are true to the best of my knowledge and belief.

Rudolph W. Berg

(Signature of Registrant)

Subscribed and sworn to before me this 28 day of July, 1958

My commission expires My Commission Expires Sept. 8, 1961

William F. O'Brien

(Notary Public)

(SEAL)

CERTIFICATE OF REGISTRATION

STATE OF OREGON

County of Marion

ss.

This is to certify that the foregoing Registration Statement was received in the office of the State Engineer on the 29 day of July, 1958, at 9:00 o'clock A.M. and has been duly recorded in said office in Book No. 12 of Registration Statements on page GR-2897

Witness my hand this 25th day of May, 1959

Lewis A. Stanley

(State Engineer)

By _____ (Deputy)

\$15.00

GR - 2897