

Registration Statement

OF CLAIMANT OF RIGHT TO APPROPRIATE GROUND WATER

TO THE STATE ENGINEER OF OREGON:

I, Oscar D. Olson

of 4285 Portland Rd County of Morris

State of Oregon, do hereby make application for a certificate of registration as evidence of a right to appropriate ground water.

1. Source from which water is withdrawn is pump well
(Flowing well, pump well, infiltration trench, or tunnel)

2. Location is: 4285-Portland Rd Salem Oregon
(Approximate distance and direction from nearest city or town)

and is more particularly described as follows: 1250 feet South & 310 feet east from N 1/4 Cor. Ingr Section 12

(a) Hayesville Interchange
(Give distance and bearing to corner of section or other legal subdivision)

being within NW 1/4 of NE 1/4 of Sec. 12, Twp. 7S, Rge. 3W
(Smallest legal subdivision) (or S.) (or W.)

or (b) within limits of recorded platted property, town or city:

in Lot _____, Block _____ of _____
(Name of plat or addition)

County of _____
(If within city or town, give name)

3. Construction Work was begun on 1957; was completed on 1957
(Date) (Date)

and the ground water claimed was first used for the purposes set out below on Greenhouse 1957
(Date)

since which time the water has been used continuously
(Continuously or intermittently)

from June 1957 to present time - July 59 1958
(Date) (Date)

4. Quantity of water claimed and used is 60 gallons per minute; _____ acre feet per year.

5. Purpose or Purposes for which water is used Greenhouse watering and garden
(Domestic, irrigation, municipal, manufacturing, industrial, etc.)

6. Description of Well: Depth 68 feet. Type drilled
(Dug or drilled)

diameter 6 inches. Elevation of ground at well site level feet, mean sea level.
(As near as known)

Depth to water table 30 feet.

7. Capacity of Well: _____ g.p.m. with _____ feet drawdown.

_____ g.p.m. with _____ feet drawdown.

Date of test _____

If Flowing Well: Measured discharge _____ g.p.m. on _____
(Date)

Shut-in pressure at ground surface _____ lbs. per sq. in. on _____
(Date)

Water is controlled by _____
(Cap, valve, etc.)

8. Casing: (Give diameter, commercial specifications and depth below ground surface of each casing size.)

8 1/2" inch diameter steel casing from 0 to 65 feet
 _____ inch diameter _____ from _____ to _____ feet
 _____ inch diameter _____ from _____ to 5 feet
 _____ inch diameter _____ from _____ to _____ feet

Describe and show depth of shoe, plug, adapter, liner or other details: _____

9. Perforated Casings or Screens:

no _____ from _____ to _____
 (Number per foot and size of perforations, or describe screen)
 _____ from _____ to _____
 _____ from _____ to _____
 _____ from _____ to _____

10. Log of Well: (Describe each stratum or formation clearly, indicate if water bearing, and give thickness and depth as indicated.)

MATERIAL	Thickness (Feet)	Depth to Bottom (Feet)
<u>no record</u>		

If log of well is not available, give name and address of driller. dead.

11. Infiltration Trench: Covered or open

Dimensions: Length _____ ft. Minimum depth _____ ft. Maximum depth _____ ft.
Bottom width _____ ft. Discharge _____ g.p.m. Date of test _____

12. Tunnel: Type of lining

Dimensions: _____
(Length, course, and cross sectional size)
Position of water bearing stratum with reference to portal of tunnel _____

Log of tunnel: (Preceding table for log of well may be used, if desired. Give footage from portal and character of materials, as pertinent.)

13. Pumping Equipment:

(a) Pump Jacuzzi Turbin Capacity 60 g.p.m.
(Make, type and size)
(b) Motor 3 horse
(Type and horsepower)

14. Location of area irrigated or to be irrigated, or place of use if for purposes other than irrigation.

Township North or South	Range E. or W. of Willamette Meridian	Section	Forty-acre Tract	Number Acres To Be Irrigated	Date of Reclamation
T7S	R3W	12	NW 1/4 of NE 1/4	1.0	1927
"	"	"	SW 1/4 of NE 1/4	1.0	"
"	"	"	NE 1/4 of NW 1/4	2.0	"
				<u>4.0</u>	

15. If the ground water supply is supplemental to an existing water supply, identification of any application for a permit, permit, certificate or adjudicated right to appropriate water made or held by the registrant.

Township 75 Range 34 W.M.
North

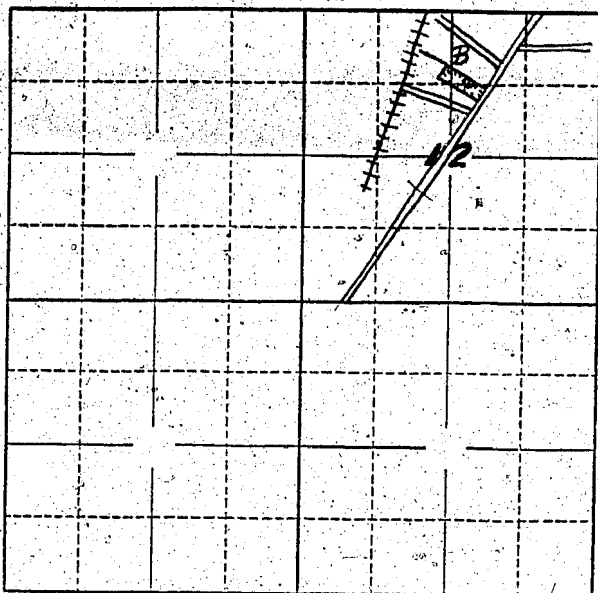

Locate well and acreage of irrigated land on plat.
Scale: 2" = 1 Mile

STATE OF OREGON

County of Marion } ss.

I, Oscar D. Olson, being first duly sworn, do hereby certify that I have read the foregoing Registration Statement and that all of the items therein contained are true to the best of my knowledge and belief.

Oscar D. Olson
(Signature of Registrant)

Subscribed and sworn to before me this 29th day of July, 1958.

My commission expires 12th June 1961 Wm. S. Bartholmes
(Notary Public)

(SEAL)

CERTIFICATE OF REGISTRATION

STATE OF OREGON

County of Marion } ss.

This is to certify that the foregoing Registration Statement was received in the office of the State Engineer on the 29th day of July, 1958, at 11:45 o'clock A. M. and has been duly recorded in said office in Book No. 16 of Registration Statements on page GR 3896

Witness my hand this 15th day of February, 1960

Lewis A. Stanley
(State Engineer)

By _____
(Deputy)

GR 3896

1500