

#101 -

Registration No. GR - 2962

Certificate No. GR 2779

Registration Statement

OF CLAIMANT OF RIGHT TO APPROPRIATE GROUND WATER

TO THE STATE ENGINEER OF OREGON:

I, Don L. Turnidge
of Rt. #1 Jefferson, County of Marion

State of Oregon do hereby make application for a certificate of registration as evidence of a right to appropriate ground water.

1. Source from which water is withdrawn is Pump Well - #101
(Flowing well, pump well, infiltration trench, or tunnel)

2. Location is: 9 mi. North Elberton
(Approximate distance and direction from nearest city or town)

and is more particularly described as follows:

(a) 960 feet east and 840 feet south from center Section 31
(Give distance and bearing to corner of section or other legal subdivision)
being within NW 1/4 of SE 1/4 of Sec. 31, Twp. 9S, Rge. 3W
(Smallest legal subdivision) (or S.) (or W.)

or (b) within limits of recorded platted property, town or city:

in Lot _____ Block _____ of _____
(Name of plat or addition)

(If within city or town, give name) County of Linn

3. Construction Work was begun on 1948; was completed on 1949
(Date) (Date)

and the ground water claimed was first used for the purposes set out below on 1949
(Date)

since which time the water has been used Continuously
(Continuously or intermittently)

from 6/49 to 7/58
(Date) (Date)

4. Quantity of water claimed and used is 500 gallons per minute; 3 acre feet per year.

5. Purpose or Purposes for which water is used irrigation

(Domestic, irrigation, municipal, manufacturing, industrial, etc.)

6. Description of Well: Depth 20 feet. Type Drilled
(Dug or drilled)

diameter 8 inches. Elevation of ground at well site 175' feet, mean sea level.
(As near as known)

Depth to water table 10' feet.

7. Capacity of Well: 500 g.p.m. with 1' feet drawdown.

1000 g.p.m. with 3' feet drawdown.

Date of test not

If Flowing Well: Measured discharge _____ g.p.m. on _____
(Date)

Shut-in pressure at ground surface _____ lbs. per sq. in. on _____
(Date)

Water is controlled by _____
(Cap, valve, etc.)

Township 9S Range 3W W.M.
North

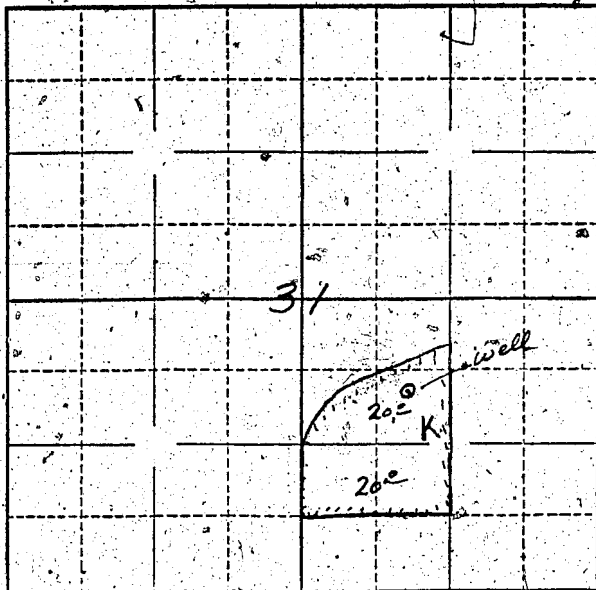

Locate well and acreage of irrigated land on plat.

Scale: $\frac{1}{4}$ inch = 1 Mile

STATE OF OREGON

County of Marion

ss.

I, Don L. Pennington, being first duly sworn, do hereby certify that I have read the foregoing Registration Statement and that all of the items therein contained are true to the best of my knowledge and belief.

Don L. Pennington
(Signature of Registrant)

Subscribed and sworn to before me this 29th day of July, 1958.

My commission expires 12th June 1964

Wm. S. Bartholomew
(Notary Public)

(SEAL)

CERTIFICATE OF REGISTRATION

STATE OF OREGON

County of Marion

ss.

This is to certify that the foregoing Registration Statement was received in the office of the State Engineer on the 29th day of July, 1958, at 9²⁰ o'clock A. M. and has been duly recorded in said office in Book No. 12 of Registration Statements on page GR-2779

Witness my hand this 25th day of May, 1959.

Lewis A. Stanley
(State Engineer)

By

(Deputy)

GR-2779