

Registration Statement

OF CLAIMANT OF RIGHT TO APPROPRIATE GROUND WATER

TO THE STATE ENGINEER OF OREGON:

I, PAT VESSELLO

of Rt # 2 Box 941 County of MULTNOMAH
(Mailing address)

State of OREGON do hereby make application for a certificate of registration as evidence of a right to appropriate ground water.

1. Source from which water is withdrawn is PUMP WELL
(Flowing well, pump well, infiltration trench, or tunnel)

2. Location is: 3 miles S.E. of Bresham
(Approximate distance and direction from nearest city or town)

and is more particularly described as follows:

(a) N 9° 00' W 1700' from SE corner Section 23- T15, R3E
(Give distance and bearing to corner of section or other legal subdivision)

being within N.E. 1/4 of S.E. 1/4 of Sec. 23, Twp. 1 S Rge. 3 E
(Smallest legal subdivision) (N. or S.) (E. or W.)

or (b) within limits of recorded platted property, town or city:

in Lot 64, Block _____ of BÖTEFUHR TRACTS
(Name of plat or addition)

County of MULTNOMAH
(If within city or town, give name)

3. Construction Work was begun on June 1952; was completed on July 1952
(Date) (Date)

and the ground water claimed was first used for the purposes set out below on 3 July 1952
(Date)

since which time the water has been used Continuously
(Continuously or intermittently)

from 3 July 1952 to Present
(Date) (Date)

4. Quantity of water claimed and used is 50 gallons per minute; 10 acre feet per year.

5. Purpose or Purposes for which water is used Irrigation
(Domestic, irrigation, municipal, manufacturing, industrial, etc.)

6. Description of Well: Depth 98 feet. Type Drilled
(Dug or drilled)

diameter 6 inches. Elevation of ground at well site 320 feet, mean sea level.
(As near as known)

Depth to water table 10 feet.

7. Capacity of Well: 100 g.p.m. with 30 feet drawdown.

_____ g.p.m. with _____ feet drawdown.

Date of test July 1952

If Flowing Well: Measured discharge _____ g.p.m. on _____
(Date)

Shut-in pressure at ground surface _____ lbs. per sq. in. on _____
(Date)

Water is controlled by _____
(Cap, valve, etc.)

8. Casing: (Give diameter, commercial specifications and depth below ground surface of each casing size.)

6 inch diameter from 1 to 98 feet
..... inch diameter from to feet
..... inch diameter from to feet
..... inch diameter from to feet

Describe and show depth of shoe, plug, adapter, liner or other details:

9. Perforated Casings or Screens:

1" Perforations for 20 Ft. from 70 to 98
(Number per foot and size of perforations, or describe screen)
..... from to
..... from to
..... from to

10. Log of Well: (Describe each stratum or formation clearly, indicate if water bearing, and give thickness and depth as indicated.)

MATERIAL	Thickness (Feet)	Depth to Bottom (Feet)

If log of well is not available, give name and address of driller: O. A. OLSON

Rt. # 1 Box 565 Gresham Oreg.

11. Infiltration Trench: Covered or open

Dimensions: Length _____ ft. Minimum depth _____ ft. Maximum depth _____ ft.

Bottom width _____ ft. Discharge _____ g.p.m. Date of test _____

12. Tunnel: Type of lining _____

Dimensions: _____
(Length, course, and cross sectional size)

Position of water bearing stratum with reference to portal of tunnel _____

Log of tunnel: (Preceding table for log of well may be used, if desired. Give footage from portal and character of materials, as pertinent.)

13. Pumping Equipment:

(a) Pump JACUZZIE 2" Capacity 50 g.p.m.
(Make, type and size)

(b) Motor 3 H.P. ROBERTS ELECTRIC
(Type and horsepower)

14. Location of area irrigated or to be irrigated, or place of use if for purposes other than irrigation.

Township North or South	Range E. or W. of Willamette Meridian	Section	Forty-acre Tract	Number Acres To Be Irrigated	Date of Reclamation
1 S	3 E	23	N.E. / S.E.	4.0	July 1952

15. If the ground water supply is supplemental to an existing water supply, identification of any application for a permit, permit, certificate or adjudicated right to appropriate water made or held by the registrant.

Township 15 Range 3E, W.M.
North

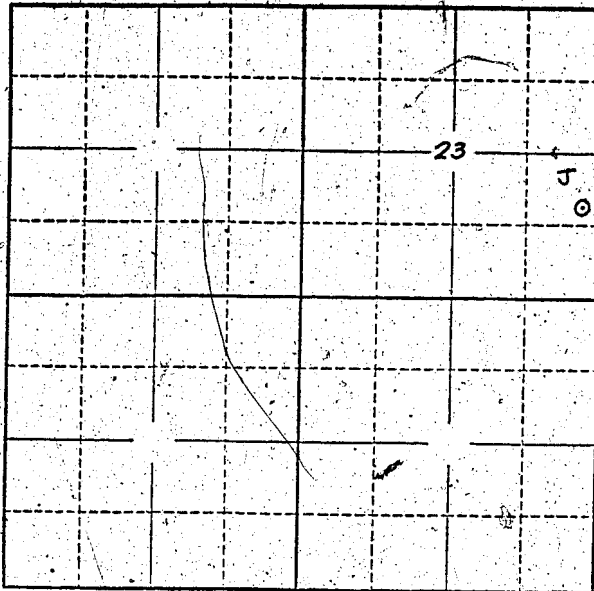

Locate well and acreage of irrigated land on plat.
Scale: 2" = 1 Mile

STATE OF OREGON

County of MULTNOMAH } ss.

I, PAT VESSELLO, being first duly sworn, do hereby certify that I have read the foregoing Registration Statement and that all of the items therein contained are true to the best of my knowledge and belief.

Pat Vesello

(Signature of Registrant)

Subscribed and sworn to before me this 28th day of July, 19 58

Amy N. Dudder

(Notary Public)

My commission expires 9/10/61

(SEAL)

CERTIFICATE OF REGISTRATION

STATE OF OREGON }
County of Marion } ss.

This is to certify that the foregoing Registration Statement was received in the office of the State Engineer on the 29th day of July, 1958, at 8:00 o'clock A. M. and has been duly recorded in said office in Book No. 12 of Registration Statements on page GR-2780

Witness my hand this 25th day of May, 19 59

Lewis A. Stanley

(State Engineer)

By _____ (Deputy)

GR - 2780

\$15.00