

Registration Statement

OF CLAIMANT OF RIGHT TO APPROPRIATE GROUND WATER

(Under Chapter 708, Oregon Laws 1955.)

TO THE STATE ENGINEER OF OREGON:

I, ROBERT H SMITH

of KERBY County of JOSEPHINE

State of OREGON, do hereby make application for a certificate of registration as evidence of a right to appropriate ground water.

1. Source from which water is withdrawn is INFILTRATION TRENCH
(Flowing well, pump well, infiltration trench, or tunnel)

2. Location is: 1/8 MILE WEST OF KERBY
(Approximate distance and direction from nearest city or town)

and is more particularly described as follows: About 200 feet east & 200 feet north from SW corner Section 4.

(a) 300 FT WEST and 200 FT NORTH of S.W. CORNER Blk 16
(Give distance and bearing to corner of section or other legal subdivision)

being within SE 1/4 S 1/4 of Sec. 4 Twp. 39 S Rge. 8 W
(Smallest legal subdivision) (or S.) (or W.)

or (b) within limits of recorded platted property, town or city:

in Lot _____ Block 16 of KERBY
(Name of plat or addition)

KERBY County of JOSEPHINE
(If within city or town, give name)

3. Construction Work was begun on 5/1/48 was completed on 9/15/48
(Date) (Date)

and the ground water claimed was first used for the purposes set out below on 5/10/48
(Date)

since which time the water has been used CONTINUOUSLY DURING IRRIGATION SEASON
(Continuously or Intermittently)

from 5/10/48 to 9/30/57
(Date) (Date)

4. Quantity of water claimed and used is 100 gallons per minute; 66 acre feet per year.

5. Purpose or Purposes for which water is used IRRIGATION

(Domestic, irrigation, municipal, manufacturing, industrial, etc.)

6. Description of Well: SUMP Depth _____ feet. Type _____
(Dug or drilled)

diameter _____ inches. Elevation of ground at well site 1300 feet, mean sea level.
(As near as known)

Depth to water table 7 feet.

7. Capacity of Well: _____ g.p.m. with _____ feet drawdown.

_____ g.p.m. with _____ feet drawdown.

Date of test _____

If Flowing Well: Measured discharge _____ g.p.m. on _____
(Date)

Shut-in pressure at ground surface _____ lbs. per sq. in. on _____
(Date)

Water is controlled by _____
(Cap, valve, etc.)

If log of well is not available, give name and address of driller.

11. Infiltration Trench: Covered or open OPEN

Dimensions: Length 10 ft. Minimum depth 8 ft. Maximum depth 10 ft.

Bottom width 8 ft. Discharge 100 g.p.m. Date of test 9/15/48

12. Tunnel: Type of lining

Dimensions: (Length, course, and cross sectional size)

Position of water bearing stratum with reference to portal of tunnel

Log of tunnel: (Preceding table for log of well may be used, if desired. Give footage from portal and character of materials, as pertinent.)

13. Pumping Equipment:

(a) Pump WEINMAN 1 1/2 G B Z Capacity 100 g.p.m.
(Make, type and size)

(b) Motor WISCONSIN 5 H.P.
(Type and horsepower)

14. Location of area irrigated or to be irrigated, or place of use if for purposes other than irrigation.

Township North or South	Range E. or W. of Willamette Meridian	Section	Forty-acre Tract	Number Acres To Be Irrigated	Date of Reclamation
<u>T39S</u>	<u>R8W</u>	<u>9</u>	<u>SE 1/4 of SW 1/4</u>	<u>8.8</u>	<u>1948</u>

The following described real property situated in Josephine County, Oregon:

Those certain parcels of land situated in Township 39 South, Range 8 West of the Willamette Meridian, described as follows:

Parcel 1: All of Block 16, Town of Kerby, as platted in deed book 2 at page 1.

Parcel 2: A part of the James Kerby D. L. C. 37 described as follows: Commencing at a point 25 feet West of the Southwest corner of Block 16 mentioned in parcel 1 above; running thence North 540 feet; thence West 490 feet to the West line of the James Kerby D. L. C.; then South 540 feet; thence East 490 feet to the point of beginning.

Parcel 3: A tract of land situated partly in Government Lot 1, Section 9, and partly in Government Lot 4, in Section 4 described as follows: Commencing at the Southwest corner of the premises described in parcel 2 above and running thence West 10 rods; thence North 13° West, 34 rods and 5 links; thence East 14 rods and 10 links to the Northwest corner of said tract above described; thence South 540 feet to the point of beginning.

LESS & EXCEPT, All of land in Lots 1 to 8 in Block 16 above.

15. If the ground water supply is supplemental to an existing water supply, identification of any application for a permit, permit, certificate or adjudicated right to appropriate water made or held by the registrant.

Township 39S Range 8W W.M.
North

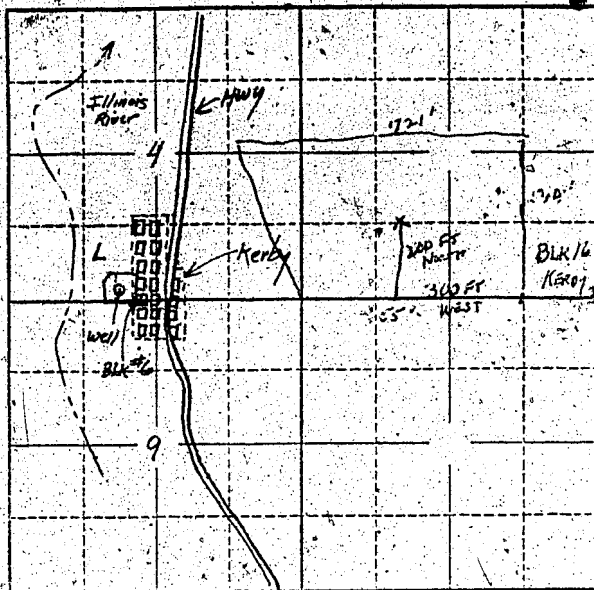

Locate well and acreage of irrigated land on plat.
Scale: 2" = 1 Mile

STATE OF OREGON

County of Wasco

ss.

I, Robert H. Smith, being first duly sworn, do hereby certify that I have read the foregoing Registration Statement and that all of the items therein contained are true to the best of my knowledge and belief.

Robert H. Smith
(Signature of Registrant)

Subscribed and sworn to before me this 17 day of July, 1958

My commission expires

Laurence Cook
(Notary Public)

(SEAL)

CERTIFICATE OF REGISTRATION

STATE OF OREGON

County of Marion

ss.

This is to certify that the foregoing Registration Statement was received in the office of the State Engineer on the 29 day of July, 1958, at -8:00 o'clock A. M. and has been duly recorded in said office in Book No. 16 of Registration Statements on page GR-3888.

~~xx Construction shall be completed by 10 and the water completely applied to beneficial use by 10. xx~~

Witness my hand this 15th day of February, 1960

Lewis A. Stanley
(State Engineer)

By

(Deputy)

\$15.00

GR-3888