

Registration Statement

OF CLAIMANT OF RIGHT TO APPROPRIATE GROUND WATER

TO THE STATE ENGINEER OF OREGON:

I, Merle Simmonds
of Route 3, Box 349-C, Medford, County of Jackson
(Mailing address)
State of Oregon, do hereby make application for a certificate of registration as evidence
of a right to appropriate ground water.

1. Source from which water is withdrawn is Sump (infiltration trench)
(Flowing well, pump well, infiltration trench, or tunnel)

2. Location is: just north of city limits of Phoenix, Oregon
(Approximate distance and direction from nearest city or town)

and is more particularly described as follows:

(a) 1260' South and 390' East from the SE corner DIC #11
(Give distance and bearing to corner of section or other legal subdivision)

being within SW 1/4 SE 1/4 of Sec. 9, Twp. 38 S., Rge. 1 W.
(Smallest legal subdivision) (N. or S.) (E. or W.)

or (b) within limits of recorded platted property, town or city:

in Lot _____, Block _____ of _____
(Name of plat or addition)

County of _____
(If within city or town, give name)

3. Construction Work was begun on Nov. 9, 1954 was completed on Nov. 9, 1954
(Date) (Date)

and the ground water claimed was first used for the purposes set out below on April 1955
(Date)

since which time the water has been used continuously
(Continuously or intermittently)

from April 1955 to present
(Date) (Date)

4. Quantity of water claimed and used is 40 gallons per minute; 18 acre
feet per year.

5. Purpose or Purposes for which water is used irrigation

(Domestic, irrigation, municipal, manufacturing, industrial, etc.)

6. Description of Well: Depth 12 feet. Type Dug
(Dug or drilled)

diameter 20' x 40' inches. Elevation of ground at well site 1515 feet, mean sea level.
(As near as known)

Depth to water table 2.5 feet.

7. Capacity of Well: _____ g.p.m. with _____ feet drawdown.

_____ g.p.m. with _____ feet drawdown.

Date of test none

If Flowing Well: Measured discharge _____ g.p.m. on _____
(Date)

Shut-in pressure at ground surface _____ lbs. per sq. in. on _____
(Date)

Water is controlled by _____
(Cap, valve, etc.)

Township 38 S. Range 1 W., W.M.
North

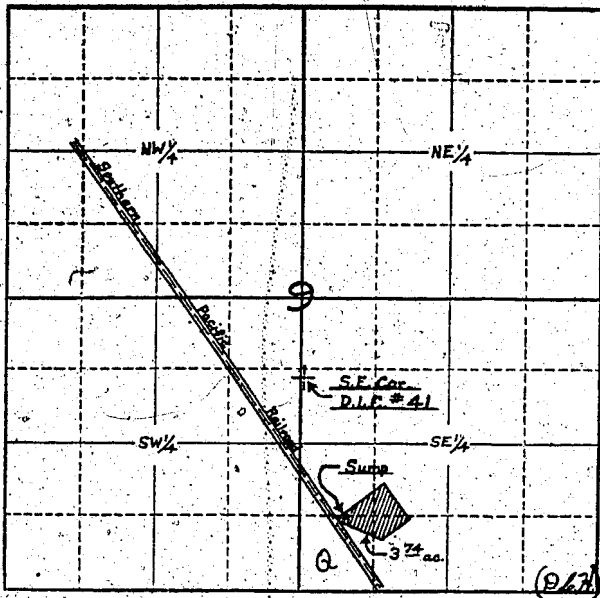

Locate well and acreage of irrigated land on plat.

Scale: 4" = 1 Mile

STATE OF OREGON

County of Jackson } ss.

I, Merle Simmonds, being first duly sworn, do hereby certify that I have read the foregoing Registration Statement and that all of the items therein contained are true to the best of my knowledge and belief.

Merle Simmonds
(Signature of Registrant)

Subscribed and sworn to before me this 28th day of July, 1958.

My commission expires August 25, 1958

W. H. ...
(Notary Public)

(SEAL)

CERTIFICATE OF REGISTRATION

STATE OF OREGON

County of Marion } ss.

This is to certify that the foregoing Registration Statement was received in the office of the State Engineer on the 29th day of July, 1958, at 8.00 o'clock A.M. and has been duly recorded in said office in Book No. 12 of Registration Statements on page GR-2783

Witness my hand this 25th day of May, 1959.

Clara A. Stanley
(State Engineer)

By _____ (Deputy)

GR - 2783

\$15.00