

# Registration Statement

## OF CLAIMANT OF RIGHT TO APPROPRIATE GROUND WATER

TO THE STATE ENGINEER OF OREGON:

I, GREENEYER NURSERY  
of 125 E. JERSEY, GLADSTONE County of CLACKAMAS  
(Mailing address)  
State of OREGON, do hereby make application for a certificate of registration as evidence of a right to appropriate ground water.

1. Source from which water is withdrawn is Pump Well  
(Flowing well, pump well, infiltration trench, or tunnel)
2. Location is: 2.5 Miles E of Melvankie  
(Approximate distance and direction from nearest city or town)

and is more particularly described as follows:

(a) S 30° W, 4175 FROM NE CORNER OF SEC. 5,  
(Give distance and bearing, to corner of section or other legal subdivision)  
being within NW 1/4 SE 1/4 of Sec. 5, Twp. 25, Rge. 2E  
(Smallest legal subdivision) (N. or S.) (E. or W.)

or (b) within limits of recorded platted property, town or city:  
in Lot \_\_\_\_\_, Block \_\_\_\_\_ of \_\_\_\_\_  
(Name of plat or addition)  
County of \_\_\_\_\_  
(If within city or town, give name)

3. Construction Work was begun on Mar. or Apr. 1954, was completed on 7 Apr. 1954  
(Date) (Date)  
and the ground water claimed was first used for the purposes set out below on May 1954  
(Date)  
since which time the water has been used intermittently  
(Continuously or Intermittently)  
from May 1954 to July 1958 (during summer months--mostly)  
(Date) (Date)

4. Quantity of water claimed and used is 40 gallons per minute; \_\_\_\_\_ acre feet per year.

5. Purpose or Purposes for which water is used Irrigation of private nursery.  
(Domestic, irrigation, municipal, manufacturing, industrial, etc.)

6. Description of Well: Depth 145 feet. Type Drilled  
(Dug or drilled)  
diameter 6 inches. Elevation of ground at well site 120 feet, mean sea level.  
(As near as known)  
Depth to water table 80 feet.

7. Capacity of Well: ? g.p.m. with ? feet drawdown.  
\_\_\_\_\_ g.p.m. with \_\_\_\_\_ feet drawdown.

Date of test \_\_\_\_\_  
If Flowing Well: Measured discharge \_\_\_\_\_ g.p.m. on \_\_\_\_\_  
(Date)  
Shut-in pressure at ground surface \_\_\_\_\_ lbs. per sq. in. on \_\_\_\_\_  
(Date)  
Water is controlled by \_\_\_\_\_  
(Cap, valve, etc.)





Township 25 Range 2E, W.M.  
North

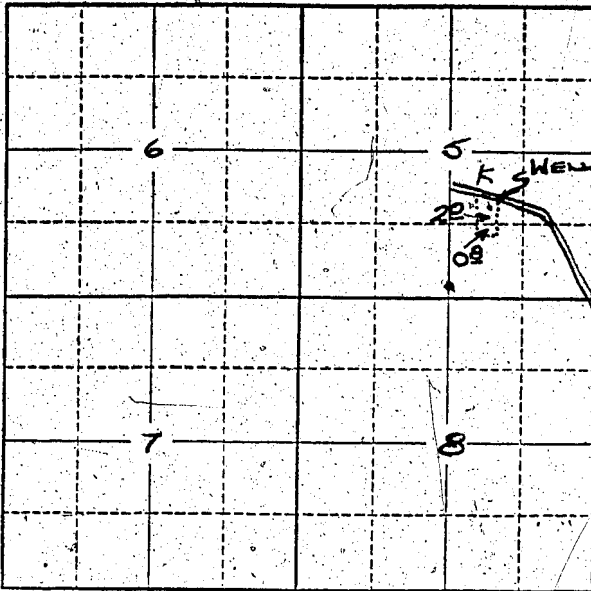

Locate well and acreage of irrigated land on plat.  
Scale: 2" = 1 Mile

STATE OF OREGON

County of Clackamas } ss.

I, Alvin L. Parker, one of the partners of Green Nursery, being first duly sworn, do hereby certify that I have read the foregoing Registration Statement and that all of the items therein contained are true to the best of my knowledge and belief.

Alvin L. Parker  
(Signature of Registrant)

Subscribed and sworn to before me this 28<sup>th</sup> day of July, 1958

My commission expires Jan. 9, 1962 Allen E. Miller  
(Notary Public for Oregon)

(SEAL)

**CERTIFICATE OF REGISTRATION**

STATE OF OREGON } ss.  
County of Marion

This is to certify that the foregoing Registration Statement was received in the office of the State Engineer on the 29 day of July, 1958, at 8:00 o'clock A. M. and has been duly recorded in said office in Book No. 12 of Registration Statements on page GR-2785

Witness my hand this 25<sup>th</sup> day of May, 1959

Clara A. Stanley  
(State Engineer)

By \_\_\_\_\_  
(Deputy)

GR-2785

#15.00