

Registration Statement CERTIFICATE NO. GR 2896

OF CLAIMANT OF RIGHT TO APPROPRIATE GROUND WATER

(Under Chapter 708, Oregon Laws 1955.)

TO THE STATE ENGINEER OF OREGON:

I, Gilbert Simmons

of Rt 2 Eugene Box 400 County of Lane

State of Oregon, do hereby make application for a certificate of registration as evidence of a right to appropriate ground water.

1. Source from which water is withdrawn is Pump Well
(Flowing well, pump well, infiltration trench, or tunnel)

2. Location is: one Mile NW of Coburg, Oregon
(Approximate distance and direction from nearest city or town)

and is more particularly described as follows:

(a) 1480' N then 510' W of S.E. corner of Section 30
NE 1/4 of SE 1/4
(Give distance and bearing to corner of section or other legal subdivision)

being within Ferguson Land Claim #57 of Sec. 30, Twp. 16S, Rge. 3W
(Smallest legal subdivision) (N. or S.) (E. or W.)

or (b) within limits of recorded platted property, town or city:

in Lot _____, Block _____ of _____
(Name of plat or addition)

County of _____
(If within city or town, give name)

3. Construction Work was begun on 1935; was completed on 1935
(Date) (Date)

and the ground water claimed was first used for the purposes set out below on 1935
(Date)

since which time the water has been used Intermittently
(Continuously or Intermittently)

from June to Oct each year
(Date) (Date)

4. Quantity of water claimed and used is 280 gallons per minute; 30 acre feet per year.

5. Purpose or Purposes for which water is used Irrigation

(Domestic, irrigation, municipal, manufacturing, industrial, etc.)

6. Description of Well: Depth 12 feet. Type Dug & filled
(Dug or drilled)

diameter 40 inches. Elevation of ground at well site 400 feet, mean sea level.
(As near as known)

Depth to water table 6 feet.

7. Capacity of Well: 280 g.p.m. with 3 feet drawdown.

_____ g.p.m. with _____ feet drawdown.

Date of test July 1957

If Flowing Well: Measured discharge _____ g.p.m. on _____
(Date)

Shut-in pressure at ground surface _____ lbs. per sq. in. on _____
(Date)

Water is controlled by _____
(Cap, valve, etc.)

Township 16 S Range 3 W W.M.
North

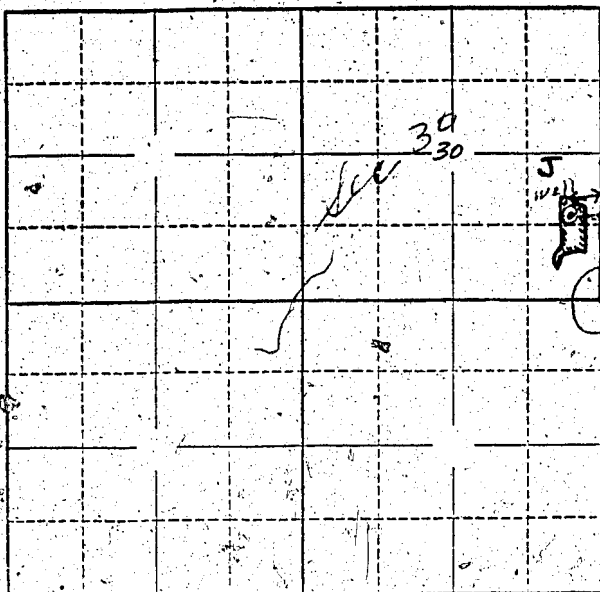

Locate well and acreage of irrigated land on plat.
Scale: 2" = 1 Mile

STATE OF OREGON }
County of Clatsop } ss.

I, Ernest S. ..., being first duly sworn, do hereby certify that I have read the foregoing Registration Statement and that all of the items therein contained are true to the best of my knowledge and belief.

Subscribed and sworn to before me this 16th day of July, 1958.
My commission expires 18, 19, 1958.
(Signature of Registrant)
(Notary Public)

(SEAL)

CERTIFICATE OF REGISTRATION

STATE OF OREGON }
County of Marion } ss.

This is to certify that the foregoing Registration Statement was received in the office of the State Engineer on the 29th day of July, 1958, at 8:00 o'clock A.M. and has been duly recorded in said office in Book No. 12 of Registration Statements on page GR-2896

~~Construction shall be completed by 1959 and the order completely complied to beneficial use by 1959~~

Witness my hand this 25th day of May, 1959.

Lucretia A. Stanley
(State Engineer)

By _____ (Deputy)

GR-2896

1522