

# Registration Statement

## OF CLAIMANT OF RIGHT TO APPROPRIATE GROUND WATER

TO THE STATE ENGINEER OF OREGON:

I, G. Palmer Byrkit  
of 16710 S.W. Hart Rd. Beaverton County of Washington  
(Mailing address)  
State of Oregon, do hereby make application for a certificate of registration as evidence of a right to appropriate ground water.

1. Source from which water is withdrawn is pump well  
(Flowing well, pump well, infiltration trench, or tunnel)

2. Location is: 3 1/2 mi. So. West of Beaverton Business Center  
(Approximate distance and direction from nearest city or town)

and is more particularly described as follows: Known as Lot 15 Aldrich Acreage

(a) East 660 feet of the South 1320 ft in the  
(Give distance and bearing to corner of section or other legal subdivision)  
being within S. E. 1/4 of SE 1/4 of Sec. 19, Twp. 1 S, Rge. 1 W  
(Smallest legal subdivision) (T. or S.) (R. or W.)

or (b) within limits of recorded platted property, town or city:

in Lot \_\_\_\_\_, Block \_\_\_\_\_ of \_\_\_\_\_  
(Name of plat or addition)

County of \_\_\_\_\_  
(If within city or town, give name)

3. Construction Work was begun on Nov. 6 1952; was completed on Jan 15 1953  
(Date) (Date)

and the ground water claimed was first used for the purposes set out below on Approx April '53  
(Date)

since which time the water has been used Continuously  
(Continual or intermittently)

from April 54 to Present  
(Date) (Date)

4. Quantity of water claimed and used is 12 gallons per minute; \_\_\_\_\_ acre feet per year.

5. Purpose or Purposes for which water is used ~~\_\_\_\_\_~~ Irrigation  
(Domestic, irrigation, municipal, manufacturing, industrial, etc.)

6. Description of Well: Depth 380 feet. Type Drilled  
(Dug or drilled)

diameter 6" I.D. inches. Elevation of ground at well site 350' feet, mean sea level.  
(As near as known)

Depth to water table 120 Static Level feet.

7. Capacity of Well: 12 g.p.m. with 40 feet drawdown.

\_\_\_\_\_ g.p.m. with \_\_\_\_\_ feet drawdown.

Date of test 12-23-57

If Flowing Well: Measured discharge \_\_\_\_\_ g.p.m. on \_\_\_\_\_  
(Date)

Shut-in pressure at ground surface \_\_\_\_\_ lbs. per sq. in. on \_\_\_\_\_  
(Date)

Water is controlled by \_\_\_\_\_  
(Cap, valve, etc.)

8. Casing: (Give diameter, commercial specifications and depth below ground surface of each casing size.)

6 inch diameter I.D. from ground level 296 feet  
Pre screen Cemented off from 296 to 340 feet  
 inch diameter from to feet  
 inch diameter from to feet

Describe and show depth of shoe, plug, adapter, liner or other details:

none

9. Perforated Casings or Screens:

(Number per foot and size of perforations, or describe screen)  
 from to  
 from to  
 from to  
 from to

10. Log of Well: (Describe each stratum or formation clearly, indicate if water bearing, and give thickness and depth as indicated.)

MATERIAL	Thickness (Feet)	Depth to Bottom (Feet)
<del>0-180 ft</del> Red & Yellow Clay	180 ft	
Rock	180 ft to 195 ft	
Red & Yellow Clay	195 ft to 295 ft	
Rock	295 ft to 340 ft	
Acid water was entering the well between 296 ft. & 340 ft. This water was shut off by cementing off under pressure & redrilling.		

If log of well is not available, give name and address of driller: You have on file

Log of well Dated Dec 24 57 signed by Edward Johnson  
Drilling Co Aloha Ore

11. Infiltration Trench: Covered or open .....  
Dimensions: Length ..... ft. Minimum depth ..... ft. Maximum depth ..... ft.

Bottom width ..... ft. Discharge ..... g.p.m. Date of test .....

12. Tunnel: Type of lining .....

Dimensions: .....  
(Length, course, and cross sectional size)

Position of water bearing stratum with reference to portal of tunnel .....

Log of tunnel: (Preceding table for log of well may be used, if desired. Give footage from portal and character of materials, as pertinent.)

13. Pumping Equipment: Head 340

(a) Pump Pacific Beresford Submers Capacity 11 g.p.m.  
(Make, type and size)

(b) Motor B.H.P. 2 - R.P.M. 3600 V 220 A. 11.4 Ph 1  
(Type and horsepower) Con 75 M.F.

14. Location of area irrigated or to be irrigated, or place of use if for purposes other than irrigation.

Township North or South	Range E. or W. of Willamette Meridian	Section	Forty-acre Tract	Number Acres To Be Irrigated	Date of Reclamation
			Lot 15, Aldrich Acreage also described as East 660ft of the South 1320 ft. in the E. Corner of Sec. 19, Twn 1 R 1 W W.M.		
T 15	R 1 W	19	SE 1/4 SE 1/4	3 acres to be irrigated	1952

15. If the ground water supply is supplemental to an existing water supply, identification of any application for a permit, permit, certificate or adjudicated right to appropriate water made or held by the registrant.

Township 15 Range 1 W, W.M.  
North

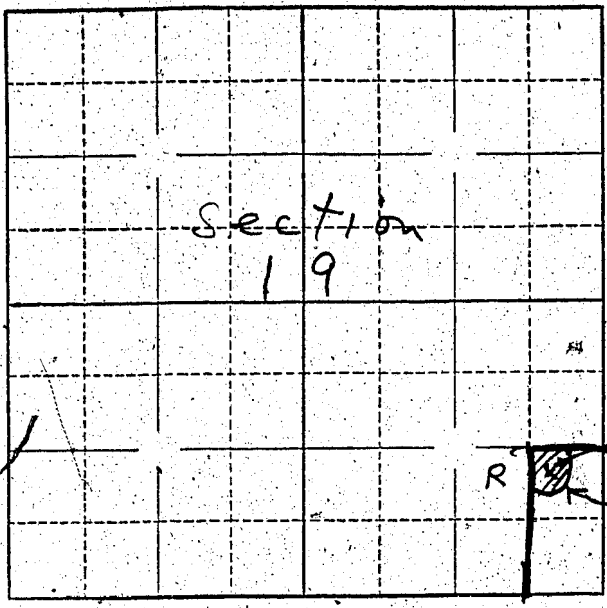

Locate well and acreage of irrigated land on plat.  
Scale: ~~1/4~~ - 1 Mile  
4"

STATE OF OREGON }  
County of Washington } ss.

I, G. Palmer Byrkit, being first duly sworn, do hereby certify that I have read the foregoing Registration Statement and that all of the items therein contained are true to the best of my knowledge and belief.

G. Palmer Byrkit  
(Signature of Registrant)

Subscribed and sworn to before me this 26 day of July, 19 58

My commission expires 12-20-58

[Signature]  
(Notary Public)

(SEAL)

**CERTIFICATE OF REGISTRATION**

STATE OF OREGON }  
County of Marion } ss.

This is to certify that the foregoing Registration Statement was received in the office of the State Engineer on the 29 day of July, 19 58, at 11:15 o'clock A. M. and has been duly recorded in said office in Book No. 12 of Registration Statements on page GR-2814

Witness my hand this 25<sup>th</sup> day of May, 19 59

Lewis A. Stanley  
(State Engineer)

By \_\_\_\_\_ (Deputy)

#1500

GR - 2814