

Registration Statement

OF CLAIMANT OF RIGHT TO APPROPRIATE GROUND WATER

TO THE STATE ENGINEER OF OREGON:

I, Vernon W. Schuld dba Bell Sand & Gravel Co.

of 6435 SE Johnson Creek Blvd Portland 6, County of Clackamas
(Mailing address)

State of Oregon, do hereby make application for a certificate of registration as evidence of a right to appropriate ground water.

1. Source from which water is withdrawn is Pump well
(Flowing well, pump well, infiltration trench, or tunnel)

2. Location is: 3 miles NE of Milwaukie, Oregon
(Approximate distance and direction from nearest city or town)

and is more particularly described as follows: 900 feet east and 1210 feet north from W 1/4 corner

(a) Hector Campbell DLC 41
(Give distance and bearing to corner of section or other legal subdivision)

being within Schulds Addition of Sec 29, Twp. 5, Rge. 2E
(Smallest legal subdivision) (N. or S.) (E. or W.)

or (b) within limits of recorded platted property, town or city:

in Lot _____, Block _____ of _____
(Name of plat or addition)

(If within city or town, give name)

County of _____

3. Construction Work was begun on Oct 7, 1937; was completed on Oct 20, 1937
(Date) (Date)

and the ground water claimed was first used for the purposes set out below on Nov 1937
(Date)

since which time the water has been used Continuously
(Continuously or intermittently)

from Nov 1937 to Oct 1957
(Date) (Date)

4. Quantity of water claimed and used is 350 gallons per minute; _____
feet per year. acres

5. Purpose or Purposes for which water is used Sand and gravel plant - Industrial

(Domestic, irrigation, municipal, manufacturing, industrial, etc.)

6. Description of Well: Depth 147 feet. Type Drilled
(Dug or drilled)

diameter 10" inches. Elevation of ground at well site 125' feet, mean sea level.
(As near as known)

Depth to water table 35 feet.

7. Capacity of Well: 275 g.p.m. with 57 feet drawdown.

195 g.p.m. with 45 feet drawdown.

Date of test Oct 19, 1937

If Flowing Well: Measured discharge _____ g.p.m. on _____
(Date)

Shut-in pressure at ground surface _____ lbs. per sq. in. on _____
(Date)

Water is controlled by _____
(Cap, valve, etc.)

8. Casing: (Give diameter, commercial specifications and depth below ground surface of each casing size.)

10" inch diameter Steel casing from 0 to 147⁴ feet
 inch diameter from to feet
 inch diameter from to feet
 inch diameter from to feet

Describe and show depth of shoe, plug, adapter, liner or other details:

Forged Shoe

9. Perforated Casings or Screens:

40 per foot ~~3/8x1/4~~ 3/8x1/4 8 rows from 130' to 143'
 (Number per foot and size of perforations, or describe screen)
 from to
 from to
 from to

10. Log of Well: (Describe each stratum or formation clearly, indicate if water bearing, and give thickness and depth as indicated.)

MATERIAL	Thickness (Feet)	Depth to Bottom (Feet)
Sand	11	121/2
Boulders and clay	12 1/2	16
Sand	16	20
Coarse sand and gravel	20	38
Fine sand	38	43
Some water and coarse sand	43	69
Yellow clay	69	72
Blue clay	72	78
Some gravel and water	78	85
Yellow clay and gravel	85	95
Cemented gravel	95	110
Some sand and gravel and water	110	118
Solid gravel	118	129
Loose gravel and water	129	147

If log of well is not available, give name and address of driller.

11. Infiltration Trench: Covered or open

Dimensions: Length ft. Minimum depth ft. Maximum depth ft.

Bottom width ft. Discharge g.p.m./ Date of test

12. Tunnel: Type of lining

Dimensions:
(Length, course, and cross sectional size)

Position of water bearing stratum with reference to portal of tunnel

Log of tunnel: (Preceding table for log of well may be used, if desired. Give footage from portal and character of materials, as pertinent.)

13. Pumping Equipment:

(a) Pump Sterling DW Capacity 350 g.p.m.
(Make, type and size)

(b) Motor Elec 440 volt 10HP
(Type and horsepower)

14. Location of area irrigated or to be irrigated, or place of use if for purposes other than irrigation.

Township North or South	Range E. or W. of Willamette Meridian	Section	Forty-acre Tract	Number Acres To Be Irrigated	Date of Reclamation
1 S	2E	29	NW ¹ / ₄ of NW ¹ / ₄ Lot #33 - Not for irrigation	Industrial	1937
"	"	"	SW ¹ / ₄ of NW ¹ / ₄	Industrial	"
Begin at a point that is 33.55 chains West of NE corner of Hector Campbell DLC #41. Thence South 563.32 feet m/l to point. Thence East 100 feet m/l to well.					

15. If the ground water supply is supplemental to an existing water supply, identification of any application for a permit, permit, certificate or adjudicated right to appropriate water made or held by the registrant.

Township 15 Range 2 E, W.M.

~~N. Line~~ Hector North CAMPBELL DLE

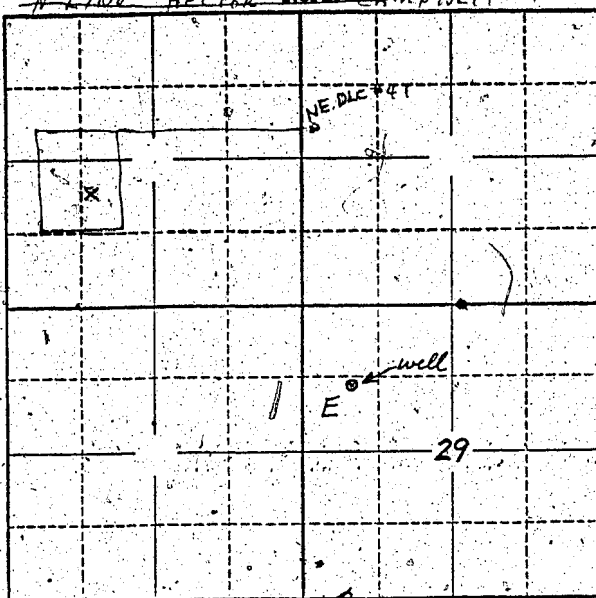

Locate well and acreage of irrigated land on plat.

Scale: 2" = 1 Mile

STATE OF OREGON

County of Clackamas

ss.

I, VERNON W. SCHULD, being first duly sworn, do hereby certify that I have read the foregoing Registration Statement and that all of the items therein contained are true to the best of my knowledge and belief.

Vernon W. Schuld
(Signature of Registrant)

Subscribed and sworn to before me this 28th day of July, 1958.

My commission expires December 7th, 1962

Harvey C. Ayers
(Notary Public)

(SEAL)

CERTIFICATE OF REGISTRATION

STATE OF OREGON

County of Marion

ss.

This is to certify that the foregoing Registration Statement was received in the office of the State Engineer on the 29 day of July, 1958, at 11:15 o'clock A. M. and has been duly recorded in said office in Book No. 12 of Registration Statements on page GR 2815

Witness my hand this 25th day of May, 1959.

Lewis A. Stanley
(State Engineer)

By _____
(Deputy)

GR 2815

20.00