

# Registration Statement

## OF CLAIMANT OF RIGHT TO APPROPRIATE GROUND WATER

(Under Chapter 708, Oregon Laws 1955.)

### TO THE STATE ENGINEER OF OREGON:

I, Louis Reding  
of Route 1, Box 382 in Tillamook County of Tillamook

State of Oregon do hereby make application for a certificate of registration as evidence of a right to appropriate ground water.

1. Source from which water is withdrawn is Pump well  
(Flowing well, pump well, infiltration trench, or tunnel)

2. Location is: About 3 miles SE of Tillamook  
(Approximate distance and direction from nearest city or town)

and is more particularly described as follows:

(a) 792.48 feet distant on a bearing of N. 81°57' W. from the SE cor of Jas Quick D.L.C  
(Give distance and bearing to corner of section or other legal subdivision)

being within NE 1/4 SE 1/4 of Sec. 32, Twp. 1 S., Rge. 9 W.  
(Smallest legal subdivision) (N. or S.) (E. or W.)

or (b) within limits of recorded platted property, town or city:

in Lot \_\_\_\_\_, Block \_\_\_\_\_ of \_\_\_\_\_  
(Name of plat or addition)

County of \_\_\_\_\_  
(If within city or town, give name)

3. Construction Work was begun on June, 1949; was completed on June, 1949  
(Date) (Date)

and the ground water claimed was first used for the purposes set out below on July 6, 1949  
(Date)

since which time the water has been used intermittently  
(Continuously or intermittently)

from 1949 to \_\_\_\_\_ date \_\_\_\_\_  
(Date) (Date)

4. Quantity of water claimed and used is 250 gallons per minute; \_\_\_\_\_ acre feet per year.

5. Purpose or Purposes for which water is used Irrigation  
(Domestic, irrigation, municipal, manufacturing, industrial, etc.)

6. Description of Well: Depth 28 feet. Type drilled  
(Dug or drilled)

diameter 8 inches. Elevation of ground at well site 29 feet (minus) feet, mean sea level.  
(As near as known)

Depth to water table \_\_\_\_\_ feet. variable, 0 depth winter, 4-6 feet summer

7. Capacity of Well: \_\_\_\_\_ g.p.m. with \_\_\_\_\_ feet drawdown.

unknown \_\_\_\_\_ g.p.m. with \_\_\_\_\_ feet drawdown.

Date of test not tested

If Flowing Well: Measured discharge \_\_\_\_\_ g.p.m. on \_\_\_\_\_  
(Date)

Shut-in pressure at ground surface \_\_\_\_\_ lbs. per sq. in. on \_\_\_\_\_  
(Date)

Water is controlled by \_\_\_\_\_  
(Cap, valve, etc.)





Township 1 S. Range 9 W. W.M.  
North

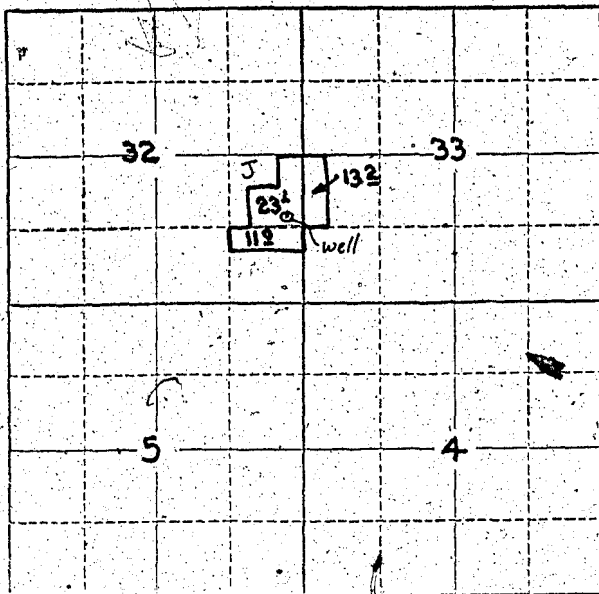

Locate well and acreage of irrigated land on plat.  
Scale: 2" = 1 Mile

STATE OF OREGON

County of Tillamook

ss.

I, Louis Reding, being first duly sworn, do hereby certify that I have read the foregoing Registration Statement and that all of the items therein contained are true to the best of my knowledge and belief.

*Louis Reding*  
(Signature of Registrant)

Subscribed and sworn to before me this 25th day of July, 1958

My commission expires Oct. 17, 1961

*Walter S. ...*  
(Notary Public)

(SEAL)

**CERTIFICATE OF REGISTRATION**

STATE OF OREGON

County of Marion

ss.

This is to certify that the foregoing Registration Statement was received in the office of the State Engineer on the 29th day of July, 1958, at 3:20 o'clock A.M. and has been duly recorded in said office in Book No. 12 of Registration Statements on page GR-2817

~~Construction shall be completed by 1959 and the state completely complied with the provisions of the act of 1958.~~

Witness my hand this 25th day of May, 1959

*Lewis A. Stanley*  
(State Engineer)

By \_\_\_\_\_ (Deputy)

GR-2817

# 17.20