

Registration Statement

OF CLAIMANT OF RIGHT TO APPROPRIATE GROUND WATER

TO THE STATE ENGINEER OF OREGON:

I, Daniel P + Jane E Schmidt
of Rt. 2 Box 398, Troutdale County of Multnomah
(Mailing address)

State of Oregon, do hereby make application for a certificate of registration as evidence of a right to appropriate ground water.

1. Source from which water is withdrawn is Pump Well
(Flowing well, pump well, infiltration trench, or tunnel)

2. Location is: 3 mi. West of Fairview - on Sandy Blvd.
(Approximate distance and direction from nearest city or town)

and is more particularly described as follows:

(a) S. 31° 00' W N.W. Cor. Sec 29
(Give distance and bearing to corner of section or other legal subdivision)

being within SW 1/4 NW 1/4 of Sec. 29, Twp. 17, Rge. 3E
(Smallest legal subdivision) (N. or S.) (E. or W.)

or (b) within limits of recorded platted property, town or city:

in Lot _____, Block _____ of _____
(Name of plat or addition)

County of Multnomah
(If within city or town, give name)

3. Construction Work was begun on Oct. 1950 was completed on Jan 1957
(Date) (Date)

and the ground water claimed was first used for the purposes set out below on June 1957
(Date)

since which time the water has been used Intermittent
(Continuously or Intermittently)

from May to Sept.
(Date) (Date)

4. Quantity of water claimed and used is 150 gallons per minute; 43 acre feet per year.

5. Purpose or Purposes for which water is used _____

Irrigation
(Domestic, irrigation, municipal, manufacturing, industrial, etc.)

6. Description of Well: Depth 198 feet. Type Drilled
(Dug or drilled)

diameter 8 inches. Elevation of ground at well site 95 feet, mean sea level.
(As near as known)

Depth to water table 60 feet.

7. Capacity of Well: 150 g.p.m. with 15 feet drawdown.

_____ g.p.m. with _____ feet drawdown.

Date of test Jan 1957

If Flowing Well: Measured discharge _____ g.p.m. on _____
(Date)

Shut-in pressure at ground surface _____ lbs. per sq. in. on _____
(Date)

Water is controlled by _____
(Cap, valve, etc.)

8. Casing: (Give diameter, commercial specifications and depth below ground surface of each casing size.)

8 inch diameter Iron from 1 to 190 feet
..... inch diameter from to feet
..... inch diameter from to feet
..... inch diameter from to feet

Describe and show depth of shoe, plug, adapter, liner or other details:

.....

9. Perforated Casings or Screens:

Unknown from to
(Number per foot and size of perforations, or describe screen)
..... from to
..... from to
..... from to

10. Log of Well: (Describe each stratum or formation clearly, indicate if water bearing, and give thickness and depth as indicated.)

MATERIAL	Thickness (Feet)	Depth to Bottom (Feet)
<u>Unknown</u>		

If log of well is not available, give name and address of driller.

Bottner

11544 NE Gibson

11. Infiltration Trench: Covered or open

Dimensions: Length ft. Minimum depth ft. Maximum depth ft.

Bottom width ft. Discharge g.p.m. Date of test

12. Tunnel: Type of lining

Dimensions: (Length, course, and cross sectional size)

Position of water bearing stratum with reference to portal of tunnel

Log of tunnel: (Preceding table for log of well may be used, if desired. Give footage from portal and character of materials, as pertinent.)

13. Pumping Equipment:

(a) Pump Trainparks-Morse Capacity 150 g.p.m. (Make, type and size)

(b) Motor 15 hp - Electric (Type and horsepower)

14. Location of area irrigated or to be irrigated, or place of use if for purposes other than irrigation.

Table with 6 columns: Township North or South, Range E. or W. of Willamette Meridian, Section, Forty-acre Tract, Number Acres To Be Irrigated, Date of Reclamation. Includes handwritten entries for sections 29, tracts NW 1/4 and SW 1/4 NW 1/4, and dates June 1951.

15. If the ground water supply is supplemental to an existing water supply, identification of any application for a permit, permit, certificate or adjudicated right to appropriate water made or held by the registrant.

Township 1N Range 3E W.M.
North

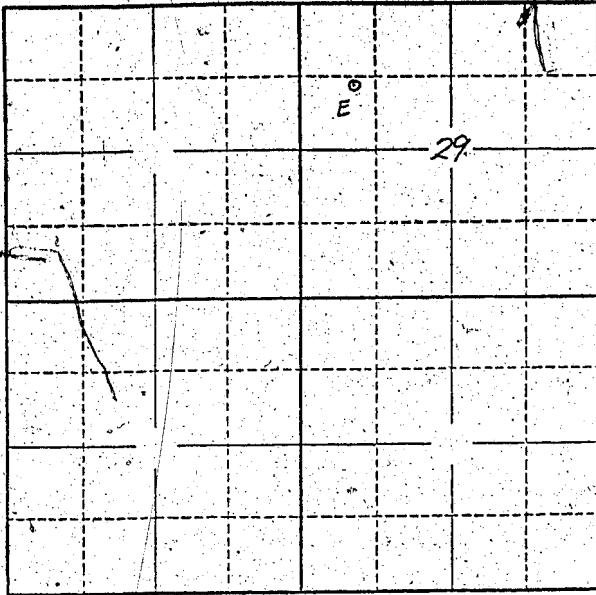

Locate well and acreage of irrigated land on plat.
Scale: 2" = 1 Mile

STATE OF OREGON

County of Multnomah } ss.

I, Daniel P. Schmidt, being first duly sworn, do hereby certify that I have read the foregoing Registration Statement and that all of the items therein contained are true to the best of my knowledge and belief.

Dan Schmidt
(Signature of Registrant)

Subscribed and sworn to before me this 28th day of July, 1958

My commission expires Mar. 2, 1959

Conrad Lehl
(Notary Public)

(SEAL)

CERTIFICATE OF REGISTRATION

STATE OF OREGON

County of Marion } ss.

This is to certify that the foregoing Registration Statement was received in the office of the State Engineer on the 29th day of July, 1958, at 8:00 o'clock A. M. and has been duly recorded in said office in Book No. 12 of Registration Statements on page GR 2823

Witness my hand this 25th day of May, 1959

Lewis A. Stanley
(State Engineer)

By _____ (Deputy)

#1500

GR - 2823