

RECEIVED  
JUL 30 1958  
STATE ENGINEER  
SALEM, OREGON

Registration No. GR. 3057

Certificate No. GR. 3790

# Registration Statement

## OF CLAIMANT OF RIGHT TO APPROPRIATE GROUND WATER

TO THE STATE ENGINEER OF OREGON:

I, WIEDEMANN BROS.

of WILSONVILLE County of CLATSOP

State of OREGON, do hereby make application for a certificate of registration as evidence of a right to appropriate ground water.

1. Source from which water is withdrawn is Pump Well  
(Flowing well, pump well, infiltration trench, or tunnel)
2. Location is: 3/4 MI. WEST OF WILSONVILLE  
(Approximate distance and direction from nearest city or town)

and is more particularly described as follows:

(a) N 12° E, 380 FEET FROM SW COR. OF SEC. 14  
(Give distance and bearing to corner of section or other legal subdivision)

being within SW 1/4 SW 1/4 of Sec. 14, Twp. 35, Rge. 1W  
(Smallest legal subdivision) (N. or S.) (E. or W.)

or (b) within limits of recorded platted property, town or city:

in Lot \_\_\_\_\_, Block \_\_\_\_\_ of \_\_\_\_\_  
(Name of plat or addition)

County of \_\_\_\_\_  
(If within city or town, give name)

3. Construction Work was begun on 1915-2; was completed on 1915-2  
(Date) (Date)

and the ground water claimed was first used for the purposes set out below on 1915  
(Date)

since which time the water has been used Continuously  
(Continuously or Intermittently)

from 1915 to 1958  
(Date) (Date)

4. Quantity of water claimed and used is 17 gallons per minute; \_\_\_\_\_ acre  
feet per year.

5. Purpose or Purposes for which water is used Irrigating Commercial Crop  
(Floral) in a greenhouse.  
(Domestic, irrigation, municipal, manufacturing, industrial, etc.)

6. Description of Well: Depth 30 feet. Type Dug  
(Dug or drilled)

diameter 30 in inches. Elevation of ground at well site Approx. 125 feet, mean sea level.  
(As near as known)

Depth to water table 36 feet.

7. Capacity of Well: \_\_\_\_\_ g.p.m. with \_\_\_\_\_ feet drawdown. Not Known  
\_\_\_\_\_ g.p.m. with \_\_\_\_\_ feet drawdown.

Date of test \_\_\_\_\_

If Flowing Well: Measured discharge Not Applicable g.p.m. on \_\_\_\_\_  
(Date)

Shut-in pressure at ground surface \_\_\_\_\_ lbs. per sq. in. on \_\_\_\_\_  
(Date)

Water is controlled by \_\_\_\_\_  
(Cap, valve, etc.)

8. Casing: (Give diameter, commercial specifications and depth below ground surface of each casing size.)

..... inch diameter *Not Applicable* from ..... to ..... feet  
 ..... inch diameter " " from ..... to ..... feet  
 ..... inch diameter " " from ..... to ..... feet  
 ..... inch diameter " " from ..... to ..... feet

Describe and show depth of shoe, plug, adapter, liner or other details: .....

9. Perforated Casings or Screens

..... *Not Applicable* from ..... to .....  
(Number per foot and size of openings, or describe screen)  
 ..... from ..... to .....  
 ..... from ..... to .....  
 ..... from ..... to .....

10. Log of Well: (Describe each stratum or formation clearly, indicate if water bearing, and give thickness and depth as indicated.)

*Not Known*

MATERIAL	Thickness (Feet)	Depth to Bottom (Feet)

If log of well is not available, give name and address of driller. ....

11. Infiltration Trench: Covered or open *Not Applicable*  
Dimensions: Length ..... ft. Minimum depth ..... ft. Maximum depth ..... ft.

Bottom width ..... ft. Discharge ..... g.p.m. Date of test .....

12. Tunnel: Type of lining *Not Applicable*

Dimensions: .....  
(Length, course, and cross sectional size)

Position of water bearing stratum with reference to portal of tunnel .....

Log of tunnel: (Preceding table for log of well may be used, if desired. Give footage from portal and character of materials, as pertinent.)

13. Pumping Equipment:

(a) Pump *Cook-Jet-3/4 horse* Capacity *20* g.p.m.  
(Make, type and size)

(b) Motor *Electric 3/4 horse*  
(Type and horsepower)

14. Location of area irrigated or to be irrigated, or place of use if for purposes other than irrigation.

Township North or South	Range E. or W. of Willamette Meridian	Section	Forty-acre Tract	Number Acres To Be Irrigated	Date of Reclamation
3S	1W	14	SW <sup>1</sup> / <sub>4</sub> SW <sup>1</sup> / <sub>4</sub>	1.0	1915

15. If the ground water supply is supplemental to an existing water supply, identification of any application for a permit, permit, certificate or adjudicated right to appropriate water made or held by the registrant.

*None*

Township 35 Range 14 W.M. North

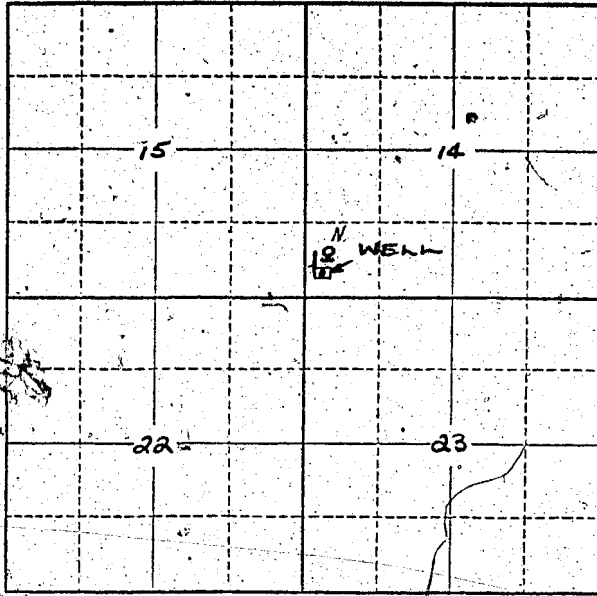

Locate well and acreage of irrigated land on plat. Scale: 2" = 1 Mile

STATE OF OREGON

County of Lackiam } ss.

I, Robert Wiedemann, being first duly sworn, do hereby certify that I have read the foregoing Registration Statement and that all of the items therein contained are true to the best of my knowledge and belief.

Robert Wiedemann (Signature of Registrant)

Subscribed and sworn to before me this 28 day of July, 1958.

My commission expires \_\_\_\_\_  
(Notary Public)

(SEAL)

CERTIFICATE OF REGISTRATION

STATE OF OREGON

County of Marion } ss.

This is to certify that the foregoing Registration Statement was received in the office of the State Engineer on the 30th day of \_\_\_\_\_, 1958, at 8:00 o'clock A. M. and has been duly recorded in said office in Book No. 16 of Registration Statements on page 62 3790

Witness my hand this 20th day of November, 1959

Lewis A. Stanley (State Engineer)

By \_\_\_\_\_ (Deputy)

GR 3790

#15.00