

RECEIVED  
JUL 30 1958

STATE ENGINEER

REGISTRATION NO. GR-3078

Registration Statement

CERTIFICATE NO. GR-3940

RECEIVED  
JAN 20 1959  
STATE ENGINEER

OF CLAIMANT OF RIGHT TO APPROPRIATE GROUND WATER

(Under Chapter 708, Oregon Laws 1955.)

TO THE STATE ENGINEER OF OREGON:

I, E. D. Harrison

of 1201 country club Rd Eugene County of Lane

State of Oregon, do hereby make application for a certificate of registration as evidence of a right to appropriate ground water.

1. Source from which water is withdrawn is dug well  
(Flowing well, pump well, infiltration trench, or tunnel)

2. Location is: 1/4 mile north west from Ferry street bridge  
(Approximate distance and direction from nearest city or town)

and is more particularly described as follows:

(a) beginning at south west corner of section 19-800ft East  
(Give distance and bearing to corner of section or other legal subdivision) then 75ft north

being within Sub 1/4 of S 1/4 of Sec. 19, Twp. 17S, Rge. R3W  
(Smallest legal subdivision) (N. or S.) (E. or W.)

or (b) within limits of recorded platted property, town or city:

in Lot \_\_\_\_\_, Block \_\_\_\_\_ of \_\_\_\_\_  
(Name of plat or addition)

County of Lane  
(If within city or town, give name)

3. Construction Work was begun on April 1930; was completed on May 1930  
(Date) (Date)

and the ground water claimed was first used for the purposes set out below on June 1930  
(Date)

since which time the water has been used intermittently  
(Continuously or intermittently)

from May to October of each year  
(Date) (Date)

4. Quantity of water claimed and used is 200 gallons per minute; ? acre feet per year.

5. Purpose or Purposes for which water is used \_\_\_\_\_

Irrigation of field crop and orchard  
(Domestic, irrigation, municipal, manufacturing, industrial, etc.)

6. Description of Well: Depth 12ft 7in feet. Type dug  
(Dug or drilled)

diameter 5ft + 3ft inches. Elevation of ground at well site near 400ft feet, mean sea level.  
(As near as known)

Depth to water table 32 inches feet. drawdown 12 inches as of July 25-1958

7. Capacity of Well: \_\_\_\_\_ g.p.m. with \_\_\_\_\_ feet drawdown.  
\_\_\_\_\_ g.p.m. with \_\_\_\_\_ feet drawdown.

Date of test \_\_\_\_\_

If Flowing Well: Measured discharge \_\_\_\_\_ g.p.m. on \_\_\_\_\_  
(Date)

Shut-in pressure at ground surface \_\_\_\_\_ lbs. per sq. in. on \_\_\_\_\_  
(Date)

Water is controlled by \_\_\_\_\_  
(Cap. valve, etc.)

From the bottom of the well there is a boiler casing 6ft in diameter 5ft in diameter 6 inches thick around open well. Farm contains about 25 acres mostly irrigated.





Township 179 Range R-3W W.M.  
North

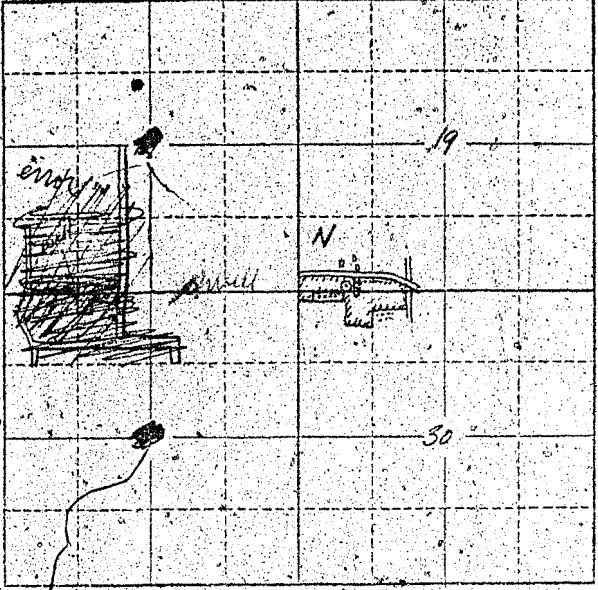

Locate well and acreage of irrigated land on plat.  
Scale: 2" = 1 Mile

STATE OF OREGON  
County of Lane ss.

I, E D Harrison, being first duly sworn, do hereby certify that I have read the foregoing Registration Statement and that all of the items therein contained are true to the best of my knowledge and belief.

E D Harrison  
(Signature of Registrant)

Subscribed and sworn to before me this 27th day of July, 1958.

My commission expires \_\_\_\_\_  
NOTARY PUBLIC FOR OREGON  
My Commission Expires Oct. 16, 1959

Robert G. Jansen  
(Notary Public)

(SEAL)

CERTIFICATE OF REGISTRATION

STATE OF OREGON  
County of Marion ss.

This is to certify that the foregoing Registration Statement was received in the office of the State Engineer on the 30th day of July, 1958, at 8:00 o'clock A. M. and has been duly recorded in said office in Book No. 16 of Registration Statements on page GR-3910

~~Construction of the canal by the State Engineer and the contractor shall be completed on or before the 30th day of July, 1958.~~

Witness my hand this 15th day of February, 1960

William A. [unclear]  
(State Engineer)

\$15.00

By \_\_\_\_\_  
(Deputy)

GR-3910