

RECEIVED
JUL 30 1958

Registration No. GR. - [REDACTED]

Certificate No. GR. - 2907

STATE ENGINEER
SALES OFFICE

Registration Statement

OF CLAIMANT OF RIGHT TO APPROPRIATE GROUND WATER

TO THE STATE ENGINEER OF OREGON:

I, ROBERT B. EVANS

of 22935 S.W. JOHNSON COURT BEAVERTON County of WASHINGTON
(Mailing address)

State of OREGON do hereby make application for a certificate of registration as evidence of a right to appropriate ground water.

1. Source from which water is withdrawn is PUMP WELL
(Flowing well, pump well, infiltration trench, or tunnel)

2. Location is: 2 MILES WEST OF ALDHA
(Approximate distance and direction from nearest city or town)

and is more particularly described as follows: 1220 ft. north of 650 feet west from E 1/4 corner Sect. 10.

(a) FROM N.E. CORNER - 3/8 MILES SOUTH - 16° 31' W.
(Give distance and bearing to corner of section or other legal subdivision)

being within BROCKWAY GARDENS of Sec. 10, Twp. 15 Rge. 2 W
(Smallest legal subdivision) (E. or S.) (E. or W.)

or (b) within limits of recorded platted property, town or city:

in Lot 5, Block _____ of BROCKWAY GARDENS
(Name of plat or addition)

County of WASHINGTON
(If within city or town, give name)

3. Construction Work was begun on PRIOR TO 1953; was completed on MARCH 12, 1953
(Date) (Date)

and the ground water claimed was first used for the purposes set out below on MAY 1953
(Date)

since which time the water has been used INTERMITTENTLY
(Continuously or intermittently)

from MAY 1953 to JULY 1958
(Date) (Date)

4. Quantity of water claimed and used is 7 1/2 gallons per minute; 1 1/2 acre feet per year.

5. Purpose or Purposes for which water is used _____

IRRIGATION
(Domestic, irrigation, municipal, manufacturing, industrial, etc.)

6. Description of Well: Depth 52 feet. Type DRIKLED
(Dug or drilled)

diameter 4 inches. Elevation of ground at well site 204 feet, mean sea level.
(As near as known)

Depth to water table 18 feet.

7. Capacity of Well: 7 1/2 g.p.m. with 2 1/4 feet drawdown.

2.11 g.p.m. with 6 feet drawdown.

Date of test JULY 7, 1958

If Flowing Well: Measured discharge _____ g.p.m. on _____
(Date)

Shut-in pressure at ground surface _____ lbs. per sq. in. on _____
(Date)

Water is controlled by _____
(Cap, valve, etc.)

Township 15 Range 2W W.M.
North

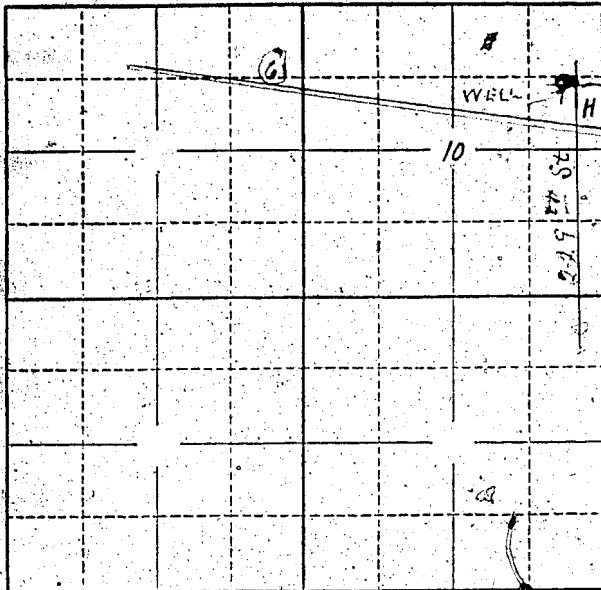

Locate well and acreage of irrigated land on plat.
Scale: 2" = 1 Mile

STATE OF OREGON }
County of WASHINGTON } ss.

I, Robert B. Evans, being first duly sworn, do hereby certify that I have read the foregoing Registration Statement and that all of the items therein contained are true to the best of my knowledge and belief.

Robert B. Evans
(Signature of Registrant)

Subscribed and sworn to before me this 29th day of July, 1958

My commission expires January 30, 1962
(Notary Public) for Oregon

(SEAL)

CERTIFICATE OF REGISTRATION

STATE OF OREGON }
County of Marion } ss.

This is to certify that the foregoing Registration Statement was received in the office of the State Engineer on the 30th day of July, 1958, at 2:00 o'clock P. M. and has been duly recorded in said office in Book No. 12 of Registration Statements on page GR-2907

Witness my hand this 25th day of May, 1959

(State Engineer)

By _____
(Deputy)

GR - 2907

\$15.00