

Registration Statement

OF CLAIMANT OF RIGHT TO APPROPRIATE GROUND WATER

(Under Chapter 708, Oregon Laws 1955.)

TO THE STATE ENGINEER OF OREGON:

I, Mrs. Joe F. Mahony
of P.R. #1 Box 2 S.1 Garma County of Marion
State of Ore, do hereby make application for a certificate of registration as evidence
of a right to appropriate ground water.

1. Source from which water is withdrawn is Pump Well
(Flowing well, pump well, infiltration trench, or tunnel)

2. Location is: 4 1/2 Miles S. ST. Paul
(Approximate distance and direction from nearest city or town)

and is more particularly described as follows:

(a) 5 1022.32 FT W 3052.60 FT From 1/4 Sec. Cor. Between 11 & 12
(Give distance and bearing to corner of section or other legal subdivision)

being within NE 1/4 of SW 1/4 of Sec. 11, Twp. 5 S, Rge. 3 W
(Smallest legal subdivision) (N. or S.) (E. or W.)

or (b) within limits of recorded platted property, town or city:

in Lot _____, Block _____ of _____
(Name of plat or addition)

County of _____
(If within city or town, give name)

3. Construction Work was begun on May 12, 1953; was completed on July 15, 1953
(Date) (Date)

and the ground water claimed was first used for the purposes set out below on May 23, 1953
(Date)

since which time the water has been used Intermittently
(Continuously or intermittently)

from 1953 to Oct 1957
(Date) (Date)

4. Quantity of water claimed and used is 600 gallons per minute; _____ acre
feet per year.

5. Purpose or Purposes for which water is used irrigation

(Domestic, irrigation, municipal, manufacturing, industrial, etc.)

6. Description of Well: Depth 31 feet. Type Drilled
(Dug or drilled)

diameter 10 inches. Elevation of ground at well site 40 feet, mean sea level.
(As near as known)

Depth to water table 659 feet.

7. Capacity of Well: 600 g.p.m. with 4 feet drawdown.

_____ g.p.m. with _____ feet drawdown.

Date of test Untested

If Flowing Well: Measured discharge _____ g.p.m. on _____
(Date)

Shut-in pressure at ground surface _____ lbs. per sq. in. on _____
(Date)

Water is controlled by _____
(Cap, valve, etc.)

8. Casing: (Give diameter, commercial specifications and depth below ground surface of each casing size.)

10 inch diameter from 1.5 to 30.5 feet
 inch diameter from to feet
 inch diameter from to feet
 inch diameter from to feet

Describe and show depth of shoe, plug, adapter, liner or other details:

9. Perforated Casings or Screens:

12 - 3/8" x 15" from 12 to 30
(Number per foot and size of perforations, or describe screen)
 from to
 from to
 from to

10. Log of Well: (Describe each stratum or formation clearly, indicate if water bearing, and give thickness and depth as indicated.)

MATERIAL	Thickness (Feet)	Depth to Bottom (Feet)
Sandy loam	12	12
Sand	2	14
Gravel	18.5	30.5

If log of well is not available, give name and address of driller. W. H. ... The Driller ...

Ray Perkins

11. Infiltration Trench: Covered or open
 Dimensions: Length ft. Minimum depth ft. Maximum depth ft.
 Bottom width ft. Discharge g.p.m. Date of test

12. Tunnel: Type of lining
 Dimensions:
(Length, course, and cross sectional size)
 Position of water-bearing stratum with reference to portal of tunnel

Log of tunnel: (Preceding table for log of well may be used; if desired. Give footage from portal and character of materials, as pertinent.)

13. Pumping Equipment:
 (a) Pump 2oulds Centrifugal 11.3X4 Capacity 600 g.p.m.
(Make, type and size)
 (b) Motor Electric 30 HP
(Type and horsepower)

14. Location of area irrigated or to be irrigated, or place of use if for purposes other than irrigation.

Township North or South	Range E. or W. of Willamette Meridian	Section	Forty-acre Tract	Number Acres To Be Irrigated	Date of Reclamation
5S	3W	11	LOT 8 SW 1/4 NE 1/4		0.5 1963
"	"	"	SW NE		1.7 "
"	"	"	SE NW		10.1 "
"	"	"	NE SW		21.1 "
"	"	"	SE SW		27.4 "
"	"	"	LOT 9 NW SE		0.4 "
"	"	"	NW SE		0.3 "
"	"	"	NW SW		5.1 "
"	"	"	SW SW		3.6 "
"	"	"	LOT 6 NE SW		15.6 "
"	"	"	LOT 5 SW NW		2.7 "
					<u>88.5 Ac</u> "

15. If the ground water supply is supplemental to an existing water supply, identification of any application for a permit, permit, certificate or adjudicated right to appropriate water made or held by the registrant.

Township 55 Range 3 W, W.M.
North

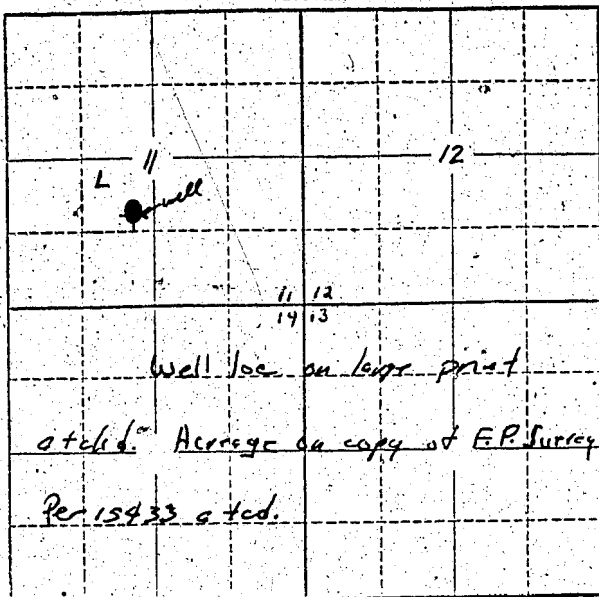

Locate well and acreage of irrigated land on plat.
Scale: 2" = 1 Mile

STATE OF OREGON

County of Marion } ss.

I, Mrs. Jas. F. Mahony, being first duly sworn, do hereby certify that I have read the foregoing Registration Statement and that all of the items therein contained are true to the best of my knowledge and belief.

Mrs. Jas. F. Mahony
(Signature of Registrant)

Subscribed and sworn to before me this 30th day of July, 1958.

My commission expires Sept. 8, 1960

Chas. L. Wheeler
(Notary Public)

(SEAL)

CERTIFICATE OF REGISTRATION

STATE OF OREGON

County of Marion } ss.

This is to certify that the foregoing Registration Statement was received in the office of the State Engineer on the 30th day of July, 1958, at 10⁰⁰ o'clock A.M. and has been duly recorded in said office in Book No. 12 of Registration Statements on page GR 2913

~~xx Construction shall be completed by 12 and the water completed, supplied to 12 for use by 12 xx~~

Witness my hand this 25th day of May, 1959

Laura A. Stanley
(State Engineer)

By _____ (Deputy)

#2385

GR-2913