

# Registration Statement

## OF CLAIMANT OF RIGHT TO APPROPRIATE GROUND WATER

TO THE STATE ENGINEER OF OREGON:

I, M. W. Lebbex

of Box 93A, Route 1, Beaverton County of Washington

State of Oregon, do hereby make application for a certificate of registration as evidence of a right to appropriate ground water.

1. Source from which water is withdrawn is Pump Well  
(Flowing well, pump well, infiltration trench, or tunnel)

2. Location is: 8 miles S.W. of Beaverton  
(Approximate distance and direction from nearest city or town)

and is more particularly described as follows:

(a) 890 feet East of 400 feet North from SW corner Section 1  
(Give distance and bearing to corner of section or other legal subdivision)

being within SW 1/4 of SW 1/4 of Sec. 1, Twp. 2S Rge. 2W  
(Smallest legal subdivision) (N. or S.) (E. or W.)

or (b) within limits of recorded platted property, town or city:

in Lot \_\_\_\_\_, Block \_\_\_\_\_ of \_\_\_\_\_  
(Name of plat or addition)

County of \_\_\_\_\_  
(If within city or town, give name)

3. Construction Work was begun on 1948; was completed on 1952  
(Date) (Date)

and the ground water claimed was first used for the purposes set out below on 1949  
(Date)

since which time the water has been used Continuously in the summer months  
(Continuously or intermittently)

from 1949 to The Present Date  
(Date) (Date)

4. Quantity of water claimed and used is 10 gallons per minute; \_\_\_\_\_ acre feet per year.

5. Purpose or Purposes for which water is used Domestic & Irrigation  
(Domestic, irrigation, municipal, manufacturing, industrial, etc.)

6. Description of Well: Depth 117 feet. Type Drilled  
(Dug or drilled)

diameter 6 inches. Elevation of ground at well site 100 feet, mean sea level.  
(As near as known)

Depth to water table app. 60 feet.

7. Capacity of Well: \_\_\_\_\_ g.p.m. with \_\_\_\_\_ feet drawdown.

\_\_\_\_\_ g.p.m. with \_\_\_\_\_ feet drawdown.

Date of test No Test

If Flowing Well: Measured discharge \_\_\_\_\_ g.p.m. on \_\_\_\_\_  
(Date)

Shut-in pressure at ground surface \_\_\_\_\_ lbs. per sq. in. on \_\_\_\_\_  
(Date)

Water is controlled by \_\_\_\_\_  
(Cap, valve, etc.)





Township 25 Range 2W, W.M.  
North

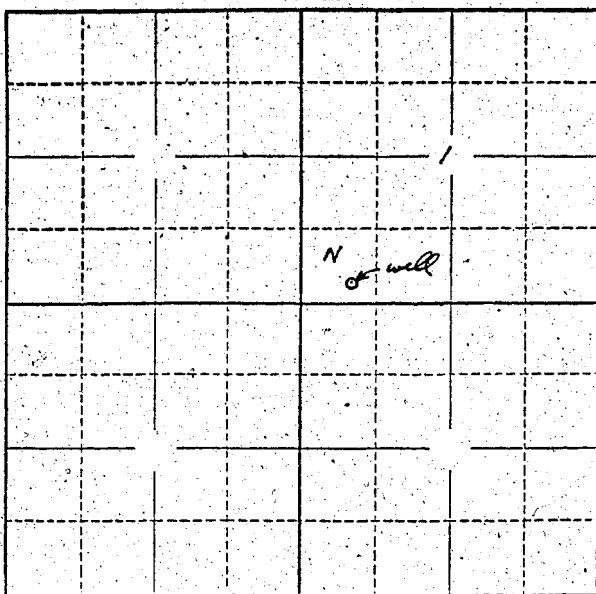

Locate well and acreage of irrigated land on plat.  
Scale: 2" = 1 Mile

STATE OF OREGON

County of MULTNOMAH } ss.

I, M. W. WEBBER, being first duly sworn, do hereby certify that I have read the foregoing Registration Statement and that all of the items therein contained are true to the best of my knowledge and belief.

M. W. Webber  
(Signature of Registrant)

Subscribed and sworn to before me this 28<sup>th</sup> day of July, 1958

My commission expires 11-25-58

[Signature]  
(Notary Public)

(SEAL)

NOTARY PUBLIC FOR OREGON  
My Commission Expires Nov. 25, 1958

**CERTIFICATE OF REGISTRATION**

STATE OF OREGON } ss.  
County of Marion

This is to certify that the foregoing Registration Statement was received in the office of the State Engineer on the 30<sup>th</sup> day of July, 1958, at 2:00 o'clock A. M. and has been duly recorded in said office in Book No. 12 of Registration Statements on page GR-2930.

Witness my hand this 25<sup>th</sup> day of May, 1959

[Signature]  
(State Engineer)

By \_\_\_\_\_  
(Deputy)

\$15.00

GR-2930