

# Registration Statement

## OF CLAIMANT OF RIGHT TO APPROPRIATE GROUND WATER

### TO THE STATE ENGINEER OF OREGON:

I, D. E. Bullis

of 3650 Philomath Road, Corvallis, Oregon County of Benton  
(Mailing address)

State of Oregon do hereby make application for a certificate of registration as evidence of a right to appropriate ground water.

1. Source from which water is withdrawn is pump well  
(Flowing well, pump well, infiltration trench, or tunnel)

2. Location is: 1-1/2 miles southwest of Corvallis  
(Approximate distance and direction from nearest city or town)

and is more particularly described as follows: 2360 east & 210 feet north from center of Section 4.

(a) SE 1/4 of NE 1/4, Sec. 4, Twp. 12 S, R5W  
(Give distance and bearing to corner of section or other legal subdivision)

being within SE 1/4 of NE 1/4 of Sec. 4, Twp. 12 S, Rge. R5W  
(Smallest legal subdivision) (N. or S.) (E. or W.)

or (b) within limits of recorded platted property, town or city:

in Lot \_\_\_\_\_, Block \_\_\_\_\_ of \_\_\_\_\_  
(Name of plat or addition)

County of \_\_\_\_\_  
(If within city or town, give name)

3. Construction Work was begun on Oct., 1950; was completed on May, 1951  
(Date) (Date)

and the ground water claimed was first used for the purposes set out below on May, 1951  
(Date)

since which time the water has been used intermittently  
(Continuously or intermittently)

from May 1951 to present  
(Date) (Date)

4. Quantity of water claimed and used is 25 gallons per minute; 3 acre feet per year.

5. Purpose or Purposes for which water is used Irrigation and domestic  
(Domestic, irrigation, municipal, manufacturing, industrial, etc.)

6. Description of Well: Depth 55 feet. Type drilled  
(Dug or drilled)

diameter 6 inches. Elevation of ground at well site 275 feet, mean sea level.  
(As near as known)

Depth to water table 17 feet.

7. Capacity of Well: 40 g.p.m. with no feet drawdown.

\_\_\_\_\_ g.p.m. with \_\_\_\_\_ feet drawdown.

Date of test Oct., 1950 (test by driller)

If Flowing Well: Measured discharge \_\_\_\_\_ g.p.m. on \_\_\_\_\_  
(Date)

Shut-in pressure at ground surface \_\_\_\_\_ lbs. per sq. in. on \_\_\_\_\_  
(Date)

Water is controlled by \_\_\_\_\_  
(Cap, valve, etc.)

8. Casing: (Give diameter, commercial specifications and depth below ground surface of each casing size.)

6 inch diameter from surface to 17 feet  
inch diameter from to feet  
inch diameter from to feet  
inch diameter from to feet

Describe and show depth of shoe, plug, adapter, liner or other details:

9. Perforated Casings or Screens:

none from to  
(Number per foot and size of perforations, or describe screen)  
from to  
from to  
from to

10. Log of Well: (Describe each stratum or formation clearly, indicate if water bearing, and give thickness and depth as indicated.) not available

MATERIAL	Thickness (Feet)	Depth to Bottom (Feet)

If log of well is not available, give name and address of driller. .... Frank Skillings, Rt. 1, Corvallis

Oregon

11. Infiltration Trench: Covered or open ..... none

Dimensions: Length ..... ft. Minimum depth ..... ft. Maximum depth ..... ft.

Bottom width ..... ft. Discharge ..... g.p.m. Date of test .....

12. Tunnel: Type of lining ..... none

Dimensions: .....  
(Length, course, and cross sectional size)

Position of water bearing stratum with reference to portal of tunnel .....

Log of tunnel: (Preceding table for log of well may be used, if desired. Give footage from portal and character of materials, as pertinent.)

13. Pumping Equipment:

(a) Pump Fairbanks-Morse jet Capacity 25 g.p.m.

(Make, type and size)

(b) Motor 2 horsepower 220 volt electric

(Type and horsepower)

14. Location of area irrigated or to be irrigated, or place of use if for purposes other than irrigation.

Township North or South	Range E. or W. of Willamette Meridian	Section	Forty-acre Tract	Number Acres To Be Irrigated	Date of Reclamation
128	5W	4	SE 1/4 of NE 1/4	3	May 1951

15. If the ground water supply is supplemental to an existing water supply, identification of any application for a permit, permit, certificate or adjudicated right to appropriate water made or held by the registrant.

not supplemental

Township 12<sup>8</sup> Range 5W, W.M.  
North

Well is Located:

151 feet south and 105 feet west of 1" pipe at NE corner of land deeded to A. G. Linn by Benton County which corner is 840' S 89°57' W along claim line and 76.32' S parallel to the E line from the NE corner of Prior Scott D.L.C. #44, T. 25.R. 5W. Benton County, Oregon. One inch pipe and well marked in red on attached map

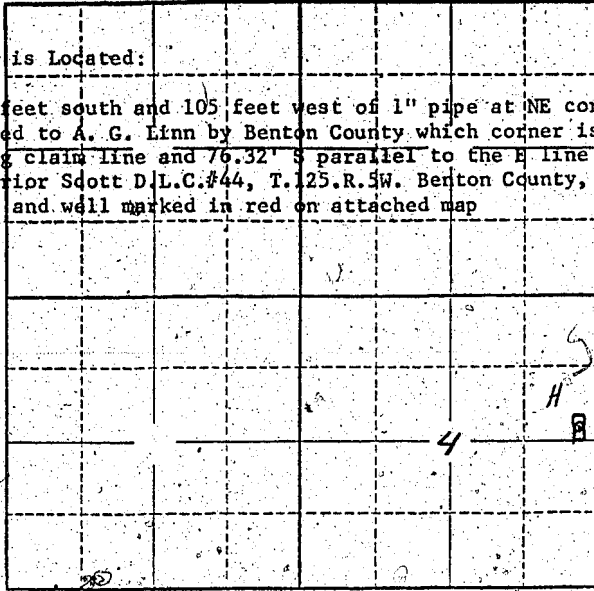

Locate well and acreage of irrigated land on plat.

Scale: 2" = 1 Mile

STATE OF OREGON

County of Benton

ss.

I, D. E. Bullis, being first duly sworn, do hereby certify that I have read the foregoing Registration Statement and that all of the items therein contained are true to the best of my knowledge and belief.

*D. E. Bullis*  
(Signature of Registrant)

Subscribed and sworn to before me this 28<sup>th</sup> day of July, 1958.

NOTARY PUBLIC FOR OREGON

My commission expires My Commission Expires Aug. 21, 1960

*W. M. Sauer*  
(Notary Public)

(SEAL)

CERTIFICATE OF REGISTRATION

STATE OF OREGON

County of Marion

ss.

This is to certify that the foregoing Registration Statement was received in the office of the State Engineer on the 30<sup>th</sup> day of July, 1958, at 8:00 o'clock P.M. and has been duly recorded in said office in Book No. 12 of Registration Statements on page GR-2938

Witness my hand this 25<sup>th</sup> day of May, 1959

*Laura A. Stanley*  
(State Engineer)

By \_\_\_\_\_ (Deputy)

GR-2938

\$15.00