

Registration Statement

OF CLAIMANT OF RIGHT TO APPROPRIATE GROUND WATER

TO THE STATE ENGINEER OF OREGON:

I, Kenneth Asbury
of RT #1 Box 442 St Helens County of Columbia
(Mailing address)

State of Oregon, do hereby make application for a certificate of registration as evidence of a right to appropriate ground water.

1. Source from which water is withdrawn is Pump well
(Flowing well, pump well, infiltration trench, or tunnel)

2. Location is: Three miles west of St Helens
(Approximate distance and direction from nearest city or town)

and is more particularly described as follows: 2040 feet west & 1160 feet North from SE Corner Section 1

(a) 1/2 mile N 3/8 mile west of SE corner of Sec 1
(Give distance and bearing to corner of section or other legal subdivision)

being within N 1/2 of SW 1/4 of SE 1/4 of Sec 1, Twp. 4 N, Rge. R W
(Smallest legal subdivision) (N. or S.) (E. or W.)

or (b) within limits of recorded platted property, town or city:

in Lot _____, Block _____ of _____
(Name of plat or addition)

County of Columbia
(If within city or town, give name)

3. Construction Work was begun on Jan 1 1954; was completed on Jan 25 1954
(Date) (Date)

and the ground water claimed was first used for the purposes set out below on Aug 1 1954
(Date)

since which time the water has been used Continuously for domestic use, irrigation & livestock
(Continuously or intermittently) for irrigation

from Aug 1 1954 to July 25 1958
(Date) (Date)

4. Quantity of water claimed and used is 42 gallons per minute; _____ acre feet per year.

5. Purpose or Purposes for which water is used irrigation
(Domestic, irrigation, municipal, manufacturing, industrial, etc.)

6. Description of Well: Depth 270 feet. Type Drilled
(Dug or drilled)

diameter 6 inches. Elevation of ground at well site 200' feet, mean sea level.
(As near as known)

Depth to water table 150' feet.

7. Capacity of Well: 42 g.p.m. with 90 feet drawdown. completed
_____ g.p.m. with _____ feet drawdown.

Date of test July 12 1954

If Flowing Well: Measured discharge _____ g.p.m. on _____
(Date)

Shut-in pressure at ground surface _____ lbs. per sq. in. on _____
(Date)

Water is controlled by _____
(Cap. valve, etc.)

8. Casing: (Give diameter, commercial specifications and depth below ground surface of each casing size.)

6 inch diameter from 0 to 207 feet
inch diameter from to feet
inch diameter from to feet
inch diameter from to feet

Describe and show depth of shoe, plug, adapter, liner or other details:

9. Perforated Casings or Screens:

from to
(Number per foot and size of perforations, or describe screen)
from to
from to
from to

10. Log of Well: (Describe each stratum or formation clearly, indicate if water bearing, and give thickness and depth as indicated.)

MATERIAL	Thickness (Feet)	Depth to Bottom (Feet)
Clay	207	207
Solid Rock	63	270

If log of well is not available, give name and address of driller. *Guy Luttril*

St Helen, Ore

11. Infiltration Trench: Covered or open

Dimensions: Length ft. Minimum depth ft. Maximum depth ft.
Bottom width ft. Discharge g.p.m. Date of test

12. Tunnel: Type of lining

Dimensions:
(Length, course, and cross sectional size)
Position of water bearing stratum with reference to portal of tunnel

Log of tunnel: (Preceding table for log of well may be used, if desired. Give footage from portal and character of materials, as pertinent.)

13. Pumping Equipment:

(a) Pump *Sumo - Submersible - 7 1/2 HP* Capacity *75* g.p.m.
(Make, type and size)
(b) Motor *Electric Motor*
(Type and horsepower)

14. Location of area irrigated or to be irrigated, or place of use if for purposes other than irrigation.

Township North or South	Range East or West of Williams Meridian	Section	Forty-acre Tract	Number Acres To Be Irrigated	Date of Reclamation
<i>4 N</i>	<i>2 W</i>	<i>1</i>	<i>N 1/2 SW of SE</i>	<i>20</i>	<i>1954</i>

15. If the ground water supply is supplemental to an existing water supply, identification of any application for a permit, permit, certificate or adjudicated right to appropriate water made or held by the registrant.

Township 4 N Range 2 W W.M. sect 1
North

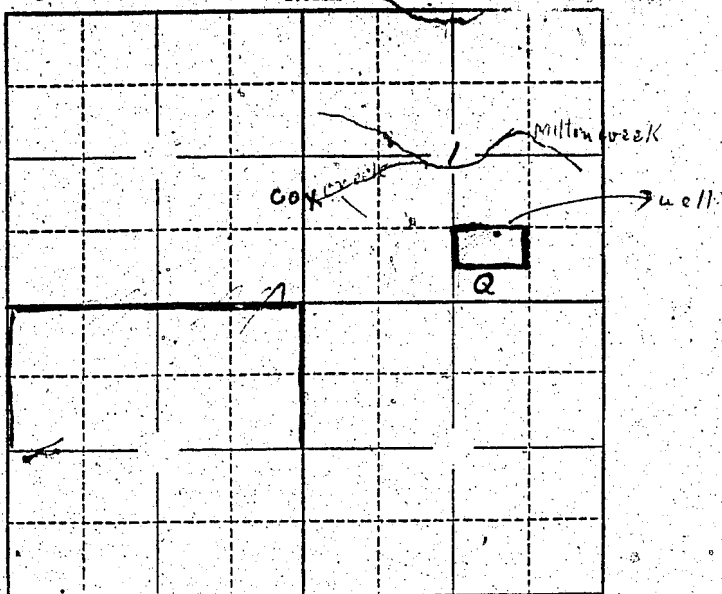

Locate well and acreage of irrigated land on plat.
Scale: 2" = 1 Mile

STATE OF OREGON }
County of Columbia } ss.

I, Kenneth Asbury, being first duly sworn, do hereby certify that I have read the foregoing Registration Statement and that all of the items therein contained are true to the best of my knowledge and belief.

Kenneth Asbury
(Signature of Registrant)

Subscribed and sworn to before me this 28th day of July, 1958

My commission expires Nov. 11, 1960
Marie Stalder Poff
(Notary Public)

(SEAL)

CERTIFICATE OF REGISTRATION

STATE OF OREGON }
County of Marion } ss.

This is to certify that the foregoing Registration Statement was received in the office of the State Engineer on the 20th day of July, 1958, at 8:00 o'clock A.M. and has been duly recorded in said office in Book No. 12 of Registration Statements on page GR 2940

Witness my hand this 25th day of May, 1959
Laura A. Stanley
(State Engineer)

By _____
(Deputy)

\$15.00