

Registration Statement

OF CLAIMANT OF RIGHT TO APPROPRIATE GROUND WATER

TO THE STATE ENGINEER OF OREGON:

I, J. Henry Peden and Cora Peden, husband and wife
 of 1190 Shady Lane, Salem County of Marion
(Mailing address)
 State of Oregon, do hereby make application for a certificate of registration as evidence
 of a right to appropriate ground water.

1. Source from which water is withdrawn is Pump Well
(Flowing well, pump well, infiltration trench, or tunnel)

2. Location is: 1/2 mile North of Salem City Limits
(Approximate distance and direction from nearest city or town)

and more particularly described as follows:

(a) About 2390 feet west & 710 feet north from E. y. corner Section 11
(Give distance and bearing to corner of section or other legal subdivision)

being within Hicks-Jones Addition of Sec. 11, Twp. 7 S., Rge. 3 W.
(Smallest legal subdivision) (N. or S.) (E. or W.)

or (b) within limits of recorded platted property, town or city:

in Lot 18, Block 3 of Hicks-Jones addition
(Name of plat or addition)

County of Marion
(If within city or town, give name)

3. Construction Work was begun on 1950; was completed on 1950
(Date) (Date)

and the ground water claimed was first used for the purposes set out below on 1950
(Date)

since which time the water has been used continuously
(Continuously or intermittently)

from 1950 to 1958
(Date) (Date)

4. Quantity of water claimed and used is 20 gallons per minute; 0 acre
 feet per year.

5. Purpose or Purposes for which water is used Irrigation of crops
(Domestic, irrigation, municipal, manufacturing, industrial, etc.)

6. Description of Well: Depth 20 feet feet. Type Driven
(Dug or drilled)

diameter 2" inches. Elevation of ground at well site _____ feet, mean sea level.
(As near as known)

Depth to water table 11 feet feet.

7. Capacity of Well: 20 g.p.m. with 8 feet drawdown.

_____ g.p.m. with _____ feet drawdown.

Date of test 1958

If Flowing Well: Measured discharge 20 g.p.m. on June 1958
(Date)

Shut-in pressure at ground surface _____ lbs. per sq. in. on _____
(Date)

Water is controlled by Pump - valve
(Cap, valve, etc.)

8. Casing: (Give diameter, commercial specifications and depth below ground surface of each casing size.)

2" inch diameter from ^{ground level} to 20 feet
 inch diameter from to feet
 inch diameter from to feet
 inch diameter from to feet

Describe and show depth of shoe, plug, adapter, liner or other details: end of pipe perforated or blown off

9. Perforated Casings or Screens:

(Number per foot and size of perforations, or describe screen) from 12 to 20 ft.
 from to
 from to
 from to

10. Log of Well: (Describe each stratum or formation clearly, indicate if water bearing, and give thickness and depth as indicated.)

MATERIAL	Thickness (Feet)	Depth to Bottom (Feet)
Soil 10 ft, gravel and sand 10 feet		

If log of well is not available, give name and address of driller.

11. Infiltration Trench: Covered or open

Dimensions: Length ft. Minimum depth ft. Maximum depth ft.

Bottom width ft. Discharge g.p.m. Date of test

12. Tunnel: Type of lining

Dimensions: (Length, course, and cross sectional size)

Position of water bearing stratum with reference to portal of tunnel

Log of tunnel: (Preceding table for log of well may be used, if desired. Give footage from portal and character of materials, as pertinent.)

13. Pumping Equipment:

(a) Pump Universal Capacity 20 g.p.m. (Make, type and size)

(b) Motor unknown (Type and horsepower)

14. Location of area irrigated or to be irrigated, or place of use if for purposes other than irrigation.

Township North or South	Range E. or W. of Willamette Meridian	Section	Forty-acre Tract	Number Acres To Be Irrigated	Date of Reclamation
7 South	3 West	11	N.W. 1/4	1 1/2	unknown 1950

15. If the ground water supply is supplemental to an existing water supply, identification of any application for a permit, permit, certificate or adjudicated right to appropriate water made or held by the registrant.

Township 75 Range 3W W.M.
North

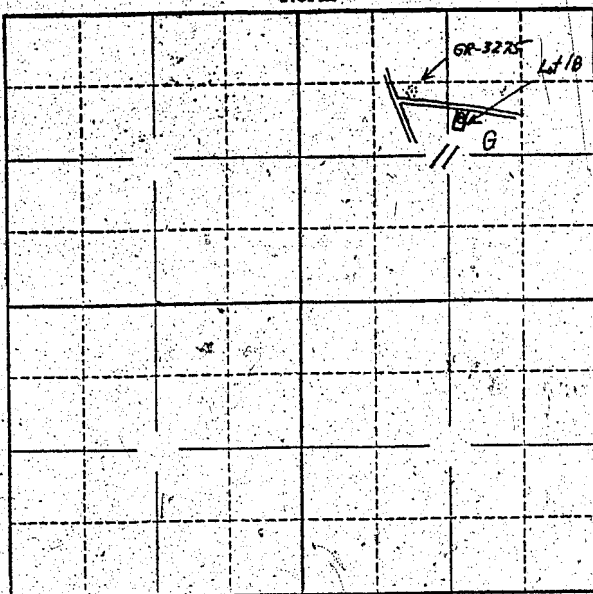

Locate well and acreage of irrigated land on plat.
Scale: 2" = 1 Mile

STATE OF OREGON

County of Marion } ss.

I, J. Henry Peden and Cora Peden, his wife, being first duly sworn, do hereby certify that I have read the foregoing Registration Statement and that all of the items therein contained are true to the best of my knowledge and belief.

J. Henry Peden + Cora Peden
(Signature of Registrant)

Subscribed and sworn to before me this 29th day of July, 1958

My commission expires Oct. 23, 1960

B. M. Mason
(Notary Public)

(SEAL)

CERTIFICATE OF REGISTRATION

STATE OF OREGON

County of Marion } ss.

This is to certify that the foregoing Registration Statement was received in the office of the State Engineer on the 30 day of July, 1958, at 8:00 o'clock A.M. and has been duly recorded in said office in Book No. 16 of Registration Statements on page GR 3891

Witness my hand this 15th day of February, 1960

Lewis A. Stanley
(State Engineer)

By _____ (Deputy)

\$1500.