

# Registration Statement

## OF CLAIMANT OF RIGHT TO APPROPRIATE GROUND WATER

TO THE STATE ENGINEER OF OREGON:

I, Jon Zybach + Lyla J Zybach  
of 344 N. 36 Springfield County of Lane  
(Mailing address)

State of Oregon do hereby make application for a certificate of registration as evidence of a right to appropriate ground water.

1. Source from which water is withdrawn is Pump Well  
(Flowing well, pump well, infiltration trench, or tunnel)

2. Location is: South of Jasper  
(Approximate distance and direction from nearest city or town)

and is more particularly described as follows:

(a) 316.7 ft east  
(Give distance and bearing to corner of section or other legal subdivision)

being within SE 1/4 of Sec. 26, Twp. 15 S, Rge. 3 W  
(Smallest legal subdivision) (of or S.) (of or W.)

or (b) within limits of recorded platted property, town or city:

in Lot \_\_\_\_\_ Block \_\_\_\_\_ of \_\_\_\_\_  
(Name of plat or addition)

County of \_\_\_\_\_  
(If within city or town, give name)

3. Construction Work was begun on Aug. 1953; was completed on Aug. 1953  
(Date) (Date)

and the ground water claimed was first used for the purposes set out below on Aug. 1953  
(Date)

since which time the water has been used intermittently  
(Continuously or intermittently)

from May to October  
(Date) (Date)

4. Quantity of water claimed and used is 8 1/2 gallons per minute; 1/4 acre feet per year.

5. Purpose or Purposes for which water is used irrigation  
(Domestic, irrigation, municipal, manufacturing, industrial, etc.)

6. Description of Well: Depth 26 feet. Type Drilled  
(Dug or drilled)

diameter 5 inches. Elevation of ground at well site 511 feet, mean sea level.  
(As near as known)

Depth to water table 15 feet.

7. Capacity of Well: 22 1/2 g.p.m. with 1 feet drawdown.

\_\_\_\_\_ g.p.m. with \_\_\_\_\_ feet drawdown.

Date of test Aug 1953

If Flowing Well: Measured discharge \_\_\_\_\_ g.p.m. on \_\_\_\_\_  
(Date)

Shut-in pressure at ground surface \_\_\_\_\_ lbs. per sq. in. on \_\_\_\_\_  
(Date)

Water is controlled by \_\_\_\_\_  
(Cap, valve, etc.)

8. Casing: (Give diameter, commercial specifications and depth below ground surface of each casing size.)

5" inch diameter ..... from top to 7 feet  
 ..... inch diameter ..... from ..... to ..... feet  
 ..... inch diameter ..... from ..... to ..... feet  
 ..... inch diameter ..... from ..... to ..... feet

Describe and show depth of shoe, plug, adapter, liner or other details:  
 .....  
 .....

9. Perforated Casings or Screens:

NONE ..... from ..... to .....  
 (Number per foot and size of perforations, or describe screen)  
 ..... from ..... to .....  
 ..... from ..... to .....  
 ..... from ..... to .....

10. Log of Well: (Describe each stratum or formation clearly, indicate if water bearing, and give thickness and depth as indicated.)

MATERIAL	Thickness (Feet)	Depth to Bottom (Feet)
Sand & Gravel	17 feet	17
Basalt Lava	79	79

If log of well is not available, give name and address of driller. Kenns Well Drilling

Rt 2 Box 774 Creswell, Oregon

11. Infiltration Trench: Covered or open  
Dimensions: Length ..... ft. Minimum depth ..... ft. Maximum depth ..... ft.  
Bottom width ..... ft. Discharge ..... g.p.m. Date of test .....

12. Tunnel: Type of lining .....  
Dimensions: .....  
(Length, course, and cross sectional size)  
Position of water bearing stratum with reference to portal of tunnel .....

Log of tunnel: (Preceding table for log of well may be used, if desired. Give footage from portal and character of materials, as pertinent.)

13. Pumping Equipment:  
(a) Pump In process of changing equipment capacity 85 g.p.m.  
(Make, type and size)  
(b) Motor 2 horse power Sundman  
(Type and horsepower)

14. Location of area irrigated or to be irrigated, or place of use if for purposes other than irrigation

Township North or South	Range E. or W. of Willamette Meridian	Section	Forty-acre Tract	Number Acres To Be Irrigated	Date of Reclamation
<u>18S</u>	<u>21W</u>	<u>26</u>	<u>SE 1/4 NW 1/4</u>	<u>5.0 Ac</u>	<u>1953</u>

15. If the ground water supply is supplemental to an existing water supply, identification of any application for a permit, permit, certificate or adjudicated right to appropriate water made or held by the registrant.

Township 18.5 Range 2W W.M.  
North

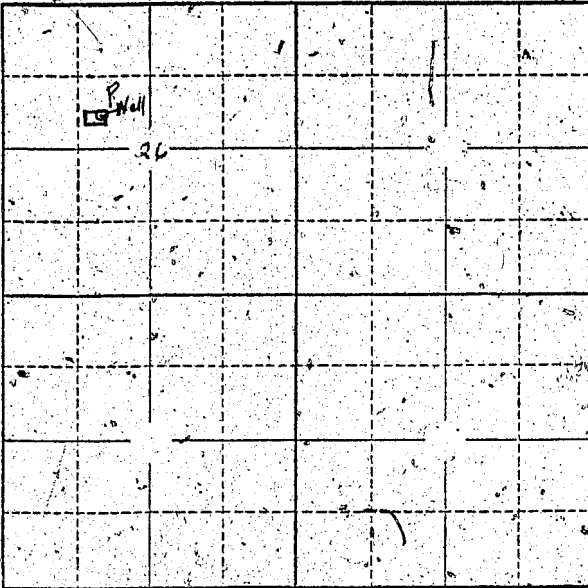

Locate well and acreage of irrigated land on plat.  
Scale: 2" = 1 Mile

STATE OF OREGON

County of Polk } ss.

I, Sylvia J. Zylack, being first duly sworn, do hereby certify that I have read the foregoing Registration Statement and that all of the items therein contained are true to the best of my knowledge and belief.

Sylvia J. Zylack  
(Signature of Registrant)

Subscribed and sworn to before me this 26 day of July, 1958

My commission expires 6-16-60 Winston J. Allen  
(Notary Public)

(SEAL)

**CERTIFICATE OF REGISTRATION**

STATE OF OREGON

County of Marion } ss.

This is to certify that the foregoing Registration Statement was received in the office of the State Engineer on the 30 day of July, 1958, at 8:00 o'clock A. M. and has been duly recorded in said office in Book No. 16 of Registration Statements on page GR-3855

Witness my hand this 28<sup>th</sup> day of December, 1959

Stuart A. Stanley  
(State Engineer)

By \_\_\_\_\_ (Deputy)

GR. 3855

#1500