

RECEIVED  
DEC 20 1953  
STATE ENGINEER  
SALVON ORSON

# Registration Statement

REGISTRATION NO. GR-319  
CERTIFICATE NO. GR-301

## OF CLAIMANT OF RIGHT TO APPROPRIATE GROUND WATER

(Under Chapter 703, Oregon Laws 1955.)

TO THE STATE ENGINEER OF OREGON:

I, Merle Hentze

of Rt 2 Junction City County of Lane

State of Oregon, do hereby make application for a certificate of registration as evidence of a right to appropriate ground water.

1. Source from which water is withdrawn is Pump Well #1  
(Flowing well, pump well, infiltration trench, or tunnel)

2. Location is: 2.5 Miles East of Junction City  
(Approximate distance and direction from nearest city or town)

and is more particularly described as follows:

(a) 1758' N 27° W from SE corner of Sec 33  
(Give distance and bearing to corner of section or other legal subdivision)

being within NE 1/4 SE 1/4 of Sec. 33, Twp. 15 S, Rge. 4 W  
(Smallest legal subdivision) (N. or S.) (E. or W.)

or (b) within limits of recorded platted property, town or city:

in Lot \_\_\_\_\_, Block \_\_\_\_\_ of \_\_\_\_\_  
(Name of plat or addition)

County of \_\_\_\_\_  
(If within city or town, give name)

3. Construction Work was begun on May 15, 1947; was completed on May 16, 1947  
(Date) (Date)

and the ground water claimed was first used for the purposes set out below on June 1, 1947  
(Date)

since which time the water has been used continuously  
(Continuously or intermittently)

from June 1, 1947 to Oct 1, 1956  
(Date) (Date)

4. Quantity of water claimed and used is 216 gallons per minute; \_\_\_\_\_ acre feet per year.

5. Purpose or Purposes for which water is used Irrigation

(Domestic, irrigation; municipal, manufacturing, industrial, etc.)

6. Description of Well: Depth 27 feet. Type Driven  
(Dug or drilled)

diameter 4 inches. Elevation of ground at well site \_\_\_\_\_ feet, mean sea level.  
(As near as known)

Depth to water table 10 feet.

7. Capacity of Well: 500 g.p.m. with \_\_\_\_\_ feet drawdown.

\_\_\_\_\_ g.p.m. with \_\_\_\_\_ feet drawdown.

Date of test July 47

If Flowing Well: Measured discharge \_\_\_\_\_ g.p.m. on \_\_\_\_\_  
(Date)

Shut-in pressure at ground surface \_\_\_\_\_ lbs. per sq. in. on \_\_\_\_\_  
(Date)

Water is controlled by \_\_\_\_\_  
(Cap, valve, etc.)

8. Casing: (Give diameter, commercial specifications and depth below ground surface of each casing size.)

4 inch diameter *Black iron casing* from 0 to 27 feet  
inch diameter from to feet  
inch diameter from to feet  
inch diameter from to feet

Describe and show depth of shoe, plug, adapter, liner or other details:

9. Perforated Casings or Screens:

8 - 3/4" Holes from 29' to 27'  
(Number per foot and size of perforations, or describe screen)  
from to  
from to  
from to

10. Log of Well: (Describe each stratum or formation clearly, indicate if water bearing, and give thickness and depth as indicated.)

MATERIAL	Thickness (Feet)	Depth to Bottom (Feet)
<i>No Record</i>		

If log of well is not available, give name and address of driller. \_\_\_\_\_

11. Infiltration Trench: Covered or open \_\_\_\_\_

Dimensions: Length \_\_\_\_\_ ft. Minimum depth \_\_\_\_\_ ft. Maximum depth \_\_\_\_\_ ft.

Bottom width \_\_\_\_\_ ft. Discharge \_\_\_\_\_ g.p.m. Date of test \_\_\_\_\_

12. Tunnel: Type of lining \_\_\_\_\_

Dimensions: \_\_\_\_\_  
(Length, course, and cross sectional size)

Position of water bearing stratum with reference to portal of tunnel \_\_\_\_\_

<sup>a</sup> Log of tunnel: (Preceding table for log of well may be used, if desired. Give footage from portal and character of materials, as pertinent.)

13. Pumping Equipment:

(a) Pump 1000331-Centrifugal-4" intake, 3" discharge Capacity 200-250 g.p.m.  
(Make, type and size)

(b) Motor Electric 7 1/2 HP  
(Type and horsepower)

14. Location of area irrigated or to be irrigated, or place of use if for purposes other than irrigation.

Township North or South	Range E. or W. of Willamette Meridian	Section	Forty-acre Tract	Number Acres To Be Irrigated	Date of Reclamation
15 S	4 W	33	NE 1/4 SE 1/4	5.5 A	June 1947

15. If the ground water supply is supplemental to an existing water supply, identification of any application for a permit, permit, certificate or adjudicated right to appropriate water made or held by the registrant.  
\_\_\_\_\_  
\_\_\_\_\_

Township 15S Range 4W, W.M.  
North

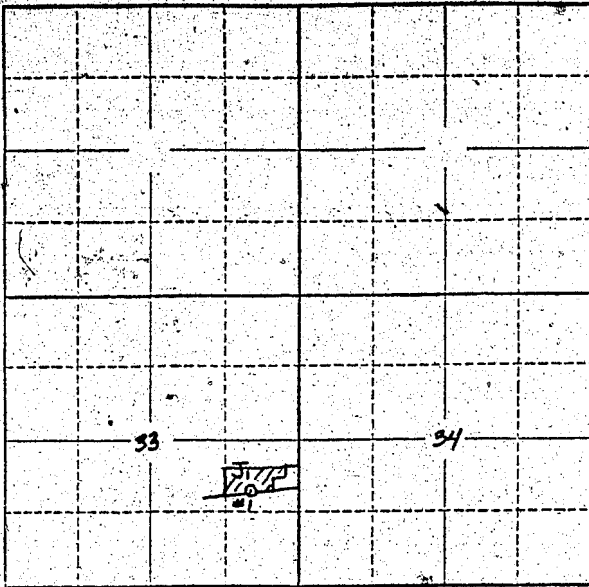

Locate well and acreage of irrigated land on plat.  
Scale: 2" = 1 Mile

STATE OF OREGON }  
County of Linn } ss.

I, Merle Hentze, being first duly sworn, do hereby certify that I have read the foregoing Registration Statement and that all of the items therein contained are true to the best of my knowledge and belief.

Merle Hentze  
(Signature of Registrant)

Subscribed and sworn to before me this 18th day of December, 1956  
My commission expires April 11, 1960  
Telma Steinhilber  
(Notary Public)

(SEAL)

SEE PAGE GR-301-K FOR  
CERTIFICATE OF REGISTRATION

STATE OF OREGON }  
County of Marion } ss.

This is to certify that the foregoing Registration Statement was received in the office of the State Engineer on the 18 day of December 1956 at 10 o'clock AM and has been duly recorded in said office in Book No. 1000 of Registration Statements on page 1000.  
Construction shall be completed by 1958 and the water completely applied to beneficial use by 1958.

Witness my hand this ..... day of ....., 19.....  
.....  
(State Engineer)  
By .....  
(Deputy)

RECEIVED  
DEC 21 1956  
STATE ENGINEER

# Registration Statement

REGISTRATION NO. GR-319

CERTIFICATE NO. GR-301

## OF CLAIMANT OF RIGHT TO APPROPRIATE GROUND WATER

(Under Chapter 708, Oregon Laws 1955.)

TO THE STATE ENGINEER OF OREGON:

I, Merle Hentze

of RT2 Junction City County of Lane

State of Oregon, do hereby make application for a certificate of registration as evidence of a right to appropriate ground water.

1. Source from which water is withdrawn is Pump Well # 2  
(Flowing well, pump well, infiltration trench, or tunnel)

2. Location is: 2.5 Miles East of Junction City  
(Approximate distance and direction from nearest city or town)

and is more particularly described as follows:

(a) 1683' N 21° E from SE corner of Sec. 33  
(Give distance and bearing to corner of section or other legal subdivision)

being within NW 1/4 SW 1/4 of Sec. 34, Twp. 15 S, Rge. 4 W  
(Smallest legal subdivision) (N. or S.) (E. or W.)

or (b) within limits of recorded platted property, town or city:

in Lot \_\_\_\_\_, Block \_\_\_\_\_ of \_\_\_\_\_  
(Name of plat or addition)

County of \_\_\_\_\_  
(If within city or town, give name)

3. Construction Work was begun on May 16, 1947; was completed on May 18, 1947  
(Date) (Date)

and the ground water claimed was first used for the purposes set out below on June 1, 1947  
(Date)

since which time the water has been used Continuously  
(Continuously or intermittently)

from June 1, 1947 to Oct 1, 1956  
(Date) (Date)

4. Quantity of water claimed and used is 216 gallons per minute; \_\_\_\_\_ acre feet per year.

5. Purpose or Purposes for which water is used Irrigation

(Domestic, irrigation, municipal, manufacturing, industrial, etc.)

6. Description of Well: Depth 20 feet. Type Driven  
(Dug or drilled)

diameter 4 inches. Elevation of ground at well site \_\_\_\_\_ feet, mean sea level.  
(As near as known)

Depth to water table 10 feet.

7. Capacity of Well: \_\_\_\_\_ g.p.m. with \_\_\_\_\_ feet drawdown.

\_\_\_\_\_ g.p.m. with \_\_\_\_\_ feet drawdown.

Date of test None

If Flowing Well: Measured discharge \_\_\_\_\_ g.p.m. on \_\_\_\_\_  
(Date)

Shut-in pressure at ground surface \_\_\_\_\_ lbs. per sq. in. on \_\_\_\_\_  
(Date)

Water is controlled by \_\_\_\_\_  
(Cap, valve, etc.)

GR-301 D

8. Casing: (Give diameter, commercial specifications and depth below ground surface of each casing size.)

4 inch diameter *Black Iron casing* from 0 to 20 feet  
 ..... inch diameter ..... from ..... to ..... feet  
 ..... inch diameter ..... from ..... to ..... feet  
 ..... inch diameter ..... from ..... to ..... feet

Describe and show depth of shoe, plug, adapter, liner or other details: .....

9. Perforated Casings or Screens:

8 - 3/4" Holes from 17' to 20'  
(Number per foot and size of perforations, or describe screen)  
 ..... from ..... to .....  
 ..... from ..... to .....  
 ..... from ..... to .....

10. Log of Well: (Describe each stratum or formation clearly, indicate if water bearing, and give thickness and depth as indicated.)

MATERIAL	Thickness (Feet)	Depth to Bottom (Feet)

GR-301 E

If log of well is not available, give name and address of driller. ....

11. Infiltration Trench: Covered or open .....

Dimensions: Length ..... ft. Minimum depth ..... ft. Maximum depth ..... ft.

Bottom width ..... ft. Discharge ..... g.p.m. Date of test .....

12. Tunnel: Type of lining .....

Dimensions: .....  
(Length, course, and cross sectional size)

Position of water bearing stratum with reference to portal of tunnel .....

Log of tunnel: (Preceding table for log of well may be used, if desired. Give footage from portal and character of materials, as pertinent.)

13. Pumping Equipment:

(a) Pump Cavazzi - Centrifugal - 4" intake - 3" discharge Capacity 200-250 g.p.m.  
(Make, type and size)

(b) Motor Electric 7 1/2 HP  
(Type and horsepower)

14. Location of area irrigated or to be irrigated, or place of use if for purposes other than irrigation.

Township North or South	Range E. or W. of Willamette Meridian	Section	Forty-acre Tract	Number Acres To Be Irrigated	Date of Reclamation
15 S	4 W	34	NR 1/4 SW 1/4	15.33 A	June 1947
15 S	4 W	34	NE 1/4 SW 1/4	7.5 A	" "

15. If the ground water supply is supplemental to an existing water supply, identification of any application for a permit, permit, certificate or adjudicated right to appropriate water made or held by the registrant.

Township 15S Range 4W, W.M.  
North

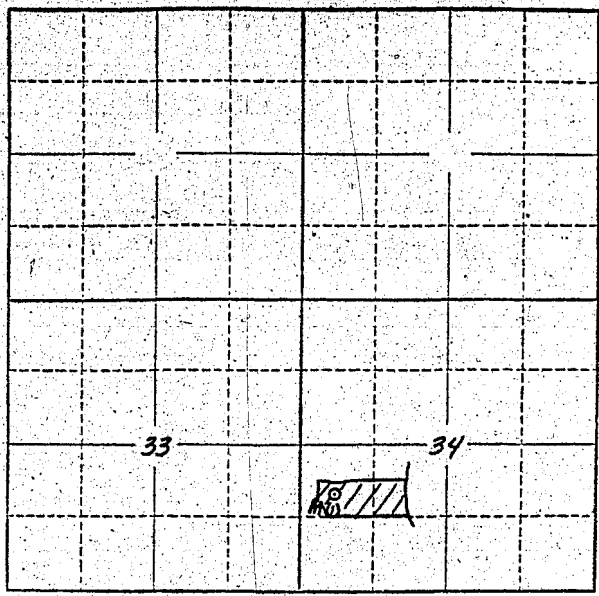

Locate well and acreage of irrigated land on plat.  
Scale: 2" = 1 Mile

STATE OF OREGON }  
County of Linn } ss.

I, Mark Hentze, being first duly sworn, do hereby certify that I have read the foregoing Registration Statement and that all of the items therein contained are true to the best of my knowledge and belief.

Mark Hentze  
(Signature of Registrant)

Subscribed and sworn to before me this 18<sup>th</sup> day of December, 19 56

My commission expires April 11, 1960

Felma Shubert  
(Notary Public)

(SEAL)

SEE PAGE GR-301-K FOR  
CERTIFICATE OF REGISTRATION

STATE OF OREGON }  
County of Marion } ss.

~~This is to certify that the foregoing Registration Statement was received in the office of the State Engineer on the x-x-x day of x-x-x-x-x-x-x-x-x-x 10 x-x-x-x-x-x-x-x-x-x and has been duly recorded in said office in Book No. x-x-x-x-x-x-x-x-x-x of Registration State records on page x-x-x-x-x-x-x-x-x-x Construction whether completed by x-x-x-x-x-x-x-x-x-x 10 x-x-x and the water completely applied to beneficial use by x-x-x-x-x-x-x-x-x-x 10 x-x-x.~~

Witness my hand this ..... day of ..... 19.....

.....  
(State Engineer)  
By .....  
(Deputy)



RECEIVED  
DEC 20 1956  
STATE ENGINEER  
SALEM, OREGON

# Registration Statement

REGISTRATION NO. GR-319  
CERTIFICATE NO. GR-301

## OF CLAIMANT OF RIGHT TO APPROPRIATE GROUND WATER (Under Chapter 768, Oregon Laws 1955.)

TO THE STATE ENGINEER OF OREGON:

I, Merle Hentze  
of Rt 2 Junction City County of Lane

State of Oregon, do hereby make application for a certificate of registration as evidence of a right to appropriate ground water:

1. Source from which water is withdrawn is Pump Well # 3  
(Flowing well, pump well, infiltration trench, or tunnel)
2. Location is: 2.5 Miles East of Junction City  
(Approximate distance and direction from nearest city or town)

and is more particularly described as follows:

(a) 2095.5' N 39° E from SF corner of Sec 33  
(Give distance and bearing to corner of section or other legal subdivision)  
being within NW 1/4 SW 1/4 of Sec. 34, Twp. 15 S, Rge. 4 W  
(Smallest legal subdivision) (N. or S.) (E. or W.)

or (b) within limits of recorded platted property, town or city:  
in Lot \_\_\_\_\_, Block \_\_\_\_\_ of \_\_\_\_\_  
(Name of plat or addition)

County of \_\_\_\_\_  
(If within city or town, give name)

3. Construction Work was begun on July 1, 1953; was completed on July 6, 1953  
(Date) (Date)  
and the ground water claimed was first used for the purposes set out below on July 6, 1953  
(Date)  
since which time the water has been used Continuously  
(Continuously or intermittently)  
from July 6, 1953 to Oct. 1, 1956  
(Date) (Date)

4. Quantity of water claimed and used is 2,216 gallons per minute; \_\_\_\_\_ acre feet per year.

5. Purpose or Purposes for which water is used Irrigation  
(Domestic, irrigation, municipal, manufacturing, industrial, etc.)

6. Description of Well: Depth 34 feet. Type Driven  
(Dug or drilled)  
diameter 4 inches. Elevation of ground at well site \_\_\_\_\_ feet, mean sea level.  
(As near as known)  
Depth to water table 12 feet.

7. Capacity of Well: \_\_\_\_\_ g.p.m. with \_\_\_\_\_ feet drawdown.  
\_\_\_\_\_ g.p.m. with \_\_\_\_\_ feet drawdown.

Date of test None

If Flowing Well: Measured discharge \_\_\_\_\_ g.p.m. on \_\_\_\_\_  
(Date)

Shut-in pressure at ground surface \_\_\_\_\_ lbs. per sq. in. on \_\_\_\_\_  
(Date)

Water is controlled by \_\_\_\_\_  
(Cap, valve, etc.)

GR-301 H

8. Casing: (Give diameter, commercial specifications and depth below ground surface of each casing size.)

4 inch diameter *Black iron casing* from 0 to 34 feet  
 inch diameter from to feet  
 inch diameter from to feet  
 inch diameter from to feet

Describe and show depth of shoe, plug, adapter, liner or other details:

9. Perforated Casings or Screens:

8 - 1/4" X 3' slots from 31' to 34'  
(Number per foot and size of perforations, or describe screen)  
 from to  
 from to  
 from to

10. Log of Well: (Describe each stratum or formation clearly, indicate if water bearing, and give thickness and depth as indicated.)

MATERIAL	Thickness (Feet)	Depth to Bottom (Feet)

If log of well is not available, give name and address of driller. ....

11. Infiltration Trench: Covered or open .....

Dimensions: Length ..... ft. Minimum depth ..... ft. Maximum depth ..... ft.

Bottom width ..... ft. Discharge ..... g.p.m. Date of test .....

12. Tunnel: Type of lining .....

Dimensions: .....  
(Length, course, and cross sectional size)

Position of water bearing stratum with reference to portal of tunnel .....

Log of tunnel: (Preceding table for log of well may be used, if desired. Give footage from portal and character of materials, as pertinent.)

13. Pumping Equipment:

(a) Pump Jacuzzi - Centrifugal - 4" intake 3" discharge Capacity 200-250 g.p.m.  
(Make, type and size)

(b) Motor Electric 7 1/2 HP  
(Type and horsepower)

14. Location of area irrigated or to be irrigated, or place of use if for purposes other than irrigation.

Township North or South	Range E. or W. of Willamette Meridian	Section	Forty-acre Tract	Number Acres To Be Irrigated	Date of Reclamation
15 S	4 W	34	NW 1/4 SW 1/4	15.33 A	June 1953
15 S	4 W	34	NE 1/4 SW 1/4	7.5 A	" "
				<u>22.83</u>	

15. If the ground water supply is supplemental to an existing water supply, identification of any application for a permit, permit, certificate or adjudicated right to appropriate water made or held by the registrant.

Township 15.5 Range 4W W.M.  
North

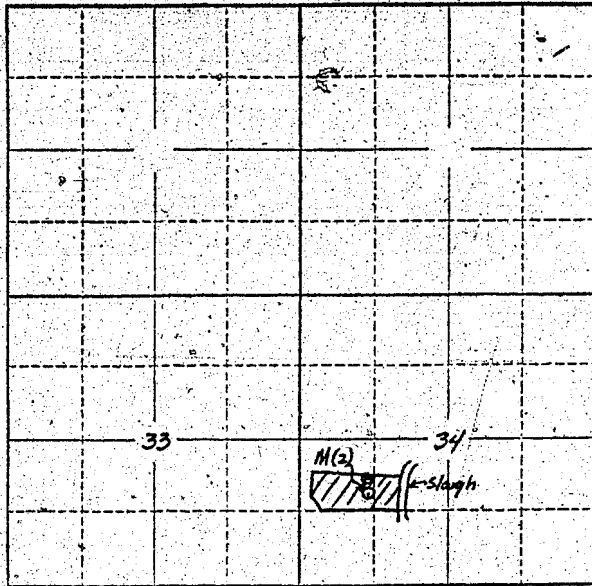

Locate well and acreage of irrigated land on plat.  
Scale: 2" — 1 Mile

STATE OF OREGON

County of Lane } ss.

I, Merle Hentze, being first duly sworn, do hereby certify that I have read the foregoing Registration Statement and that all of the items therein contained are true to the best of my knowledge and belief.

Merle Hentze  
(Signature of Registrant)

Subscribed and sworn to before me this 18th day of December 1956

My commission expires April 11, 1960

Lelona Stuebath  
(Notary Public)

(SEAL)

CERTIFICATE OF REGISTRATION

STATE OF OREGON } ss.  
County of Marion

This is to certify that the foregoing Registration Statement, was received in the office of the State Engineer on the 20th day of December, 1956, at 8 o'clock A.M. and has been duly recorded in said office in Book No. 2 of Registration Statements on page GR-301-K.

~~Construction shall be completed by~~ ~~and the water completely applied to~~ ~~be applied to~~

Witness my hand this 25th day of February, 1957.

Lewis A. Stanley  
(State Engineer)

\$ 15.00

By \_\_\_\_\_ (Deputy)

GR-301K