

Registration Statement

OF CLAIMANT OF RIGHT TO APPROPRIATE GROUND WATER

TO THE STATE ENGINEER OF OREGON:

I, William H. Koellmann
of Route 4, Box 566 Salem County of Marion
(Mailing address)
State of Oregon, do hereby make application for a certificate of registration as evidence of a right to appropriate ground water.

1. Source from which water is withdrawn is pump well
(Flowing well, pump well, infiltration trench, or tunnel)

2. Location is: seven miles south of Salem
(Approximate distance and direction from nearest city or town)

and is more particularly described as follows:

(a) 145 feet Sp. and 75 feet West of NE corner of Lot 9,
(Give distance and bearing to corner of section or other legal subdivision)
being within Sunny Side Fruit Farms #13 of Sec. 27, Twp. 8 South, Rge. 3 West
(Smallest legal subdivision) (N. or S.) (E. or W.)

or (b) within limits of recorded platted property, town or city: _____

in Lot _____, Block _____ of Sunny Side Fruit Farms #13
(Name of plat or addition)

County of Marion
(If within city or town, give name)

3. Construction Work was begun on June, 1953; was completed on June, 1953
(Date) (Date)

and the ground water claimed was first used for the purposes set out below on June, 1953
(Date)

since which time the water has been used intermittently
(Continuously or intermittently)

from June 1st to August 30
(Date) (Date)

4. Quantity of water claimed and used is ten gallons per minute; _____ acre feet per year.

5. Purpose or Purposes for which water is used irrigation

(Domestic, irrigation, municipal, manufacturing, industrial, etc.)

6. Description of Well: Depth sixty feet. Type drilled
(Dug or drilled)

diameter six inches. Elevation of ground at well site approx 575 feet, mean sea level.
(As near as known)

Depth to water table seventeen feet.

7. Capacity of Well: _____ g.p.m. with _____ feet drawdown.

_____ g.p.m. with _____ feet drawdown.

Date of test _____

If Flowing Well: Measured discharge _____ g.p.m. on _____
(Date)

Shut-in pressure at ground surface _____ lbs. per sq. in. on _____
(Date)

Water is controlled by _____
(Cap, valve, etc.)

Township 3 S. Range 3 W. W.M.
North

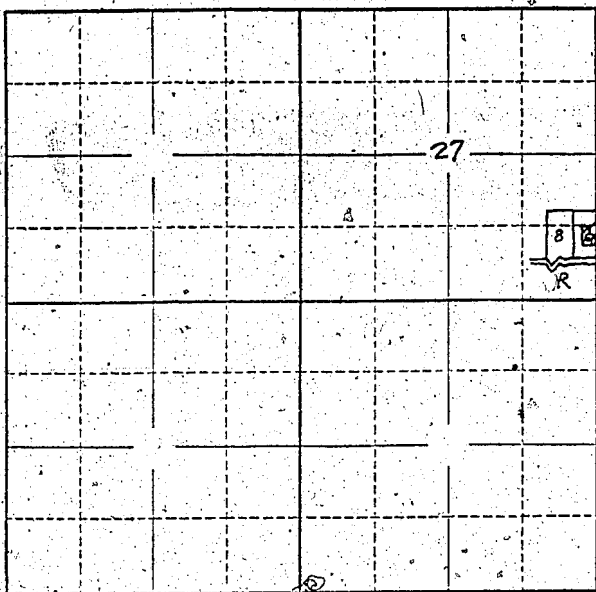

Locate well and acreage of irrigated land on plat.
Scale: 2" = 1 Mile

STATE OF OREGON

County of Marion } ss.

I, William H. Koellmann, being first duly sworn, do hereby certify that I have read the foregoing Registration Statement and that all of the items therein contained are true to the best of my knowledge and belief.

William H. Koellmann
(Signature of Registrant)

Subscribed and sworn to before me this 30th day of July, 1958.

My commission expires Sept. 8, 1960
Chas. L. Shale
(Notary Public)

(SEAL)

CERTIFICATE OF REGISTRATION

STATE OF OREGON

County of Marion } ss.

This is to certify that the foregoing Registration Statement was received in the office of the State Engineer on the 30th day of July, 1958, at 2:00 o'clock P. M. and has been duly recorded in said office in Book No. 13 of Registration Statements on page GR-3028.

Witness my hand this 8th day of June, 1959.

Wm. A. Stanley
(State Engineer)

\$15.00

By _____ (Deputy)