

Registration Statement

OF CLAIMANT OF RIGHT TO APPROPRIATE GROUND WATER

TO THE STATE ENGINEER OF OREGON:

I, Billy J. Towery
of Route 1 Box 379 Salem County of Polk
(Mailing address)

State of Oregon, do hereby make application for a certificate of registration as evidence of a right to appropriate ground water.

1. Source from which water is withdrawn is pump well #1
(Flowing well, pump well, infiltration trench, or tunnel)
2. Location is: 3 mi North of W. Salem
(Approximate distance and direction from nearest city or town)

and is more particularly described as follows:

(a) 150' E and 250' S of the S 1/4 corner of Sec. 4 T7S R3W
(Give distance and bearing to corner of section or other legal subdivision)
being within NW 1/4 of NE 1/4 of Sec. 9, Twp. 7S, Rge. 3W
(Smallest legal subdivision) (N. or S.) (E. or W.)

or (b) within limits of recorded platted property, town or city:

in Lot _____, Block _____ of _____
(Name of plat or addition)
County of Polk
(If within city or town, give name)

3. Construction Work was begun on Sept 1953, was completed on Sept 1953
(Date) (Date)
and the ground water claimed was first used for the purposes set out below on May 1954
(Date)
since which time the water has been used throughout the growing season
(Continuously or intermittently)
from Spring to Fall
(Date) (Date)

4. Quantity of water claimed and used is 700 gallons per minute; 164 acre feet per year.

5. Purpose or Purposes for which water is used irrigation
(Domestic, irrigation, municipal, manufacturing, industrial, etc.)

6. Description of Well: Depth 26 feet. Type drilled
(Dug or drilled)
diameter 8 inches. Elevation of ground at well site 145 feet, mean sea level.
(As near as known)
Depth to water table 6 feet.

7. Capacity of Well: 700 g.p.m. with 10 feet drawdown.
_____ g.p.m. with _____ feet drawdown.

Date of test Sept 1953

If Flowing Well: Measured discharge _____ g.p.m. on _____
(Date)

Shut-in pressure at ground surface _____ lbs. per sq. in. on _____
(Date)

Water is controlled by _____
(Cap, valve, etc.)

8. Casing: (Give diameter, commercial specifications and depth below ground surface of each casing size.)

8 inch diameter *steel well casing* from 0 to 26 feet
 inch diameter from to feet
 inch diameter from to feet
 inch diameter from to feet

Describe and show depth of shoe, plug, adapter, liner or other details:

9. Perforated Casings or Screens:

3 per ft. 1/2" x 6" slots from 10' to 26'
 (Number per foot, and size of perforations, or describe screen)
 from to
 from to
 from to

10. Log of Well: (Describe each stratum or formation clearly, indicate if water bearing, and give thickness and depth as indicated.)

MATERIAL	Thickness (Feet)	Depth to Bottom (Feet)
<i>sand and gravel</i>	<i>6'</i>	<i>6'</i>
<i>Water gravel</i>	<i>20'</i>	<i>26'</i>

If log of well is not available, give name and address of driller. Marion West
Market Street; Salem, Oregon

11. **Infiltration Trench:** Covered or open
 Dimensions: Length ft. Minimum depth ft. Maximum depth ft.
 Bottom width ft. Discharge g.p.m. Date of test

12. **Tunnel:** Type of lining
 Dimensions:
(Length, course, and cross sectional size)
 Position of water bearing stratum with reference to portal of tunnel

Log of tunnel: (Preceding table for log of well may be used, if desired. Give footage from portal and character of materials, as pertinent.)

13. **Pumping Equipment:**
 (a) Pump Wcin man Centrifugal 4" Capacity 700 g.p.m.
(Make, type and size)
 (b) Motor 40 hp 3 ϕ 480 V
(Type and horsepower)

14. Location of area irrigated or to be irrigated, or place of use if for purposes other than irrigation.

Township North or South	Range E. or W. of Willamette Meridian	Section	Forty-acre Tract	Number Acres To Be Irrigated	Date of Reclamation
7S	3W	9	NW $\frac{1}{4}$ & NE $\frac{1}{4}$	27.1	May 1954
7S	3W	9	SW $\frac{1}{4}$ & NE $\frac{1}{4}$	14.0	"
7S	3W	9	NE $\frac{1}{4}$ of NE $\frac{1}{4}$	9.1	"
7S	3W	9	SE $\frac{1}{4}$ of NE $\frac{1}{4}$	15.4	"
				<u>65.6</u>	

15. If the ground water supply is supplemental to an existing water supply, identification of any application for a permit, permit, certificate or adjudicated right to appropriate water made or held by the registrant.
None

Township 75 Range 3W, W.M.

North

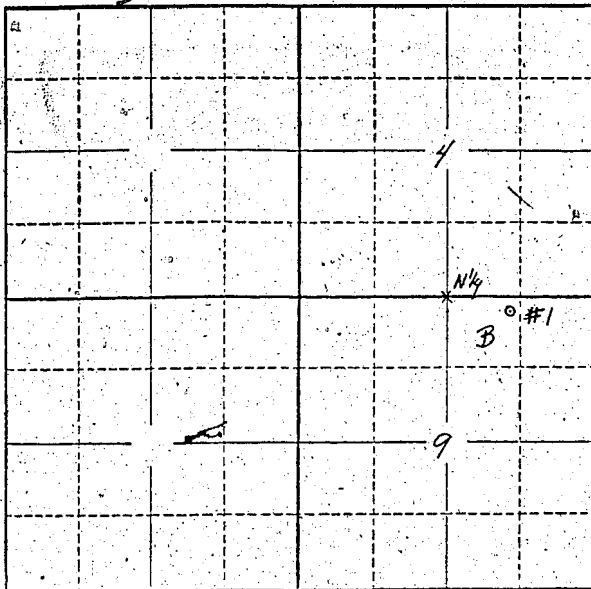

Locate well and acreage of irrigated land on plat.

Scale: 2" = 1 Mile

STATE OF OREGON

County of Talbot } ss.

I, Billy J. Towery being first duly sworn, do hereby certify that I have read the foregoing Registration Statement and that all of the items therein contained are true to the best of my knowledge and belief.

Billy J. Towery
(Signature of Registrant)

Subscribed and sworn to before me this 31st day of February, 1958

My commission expires July 16, 1961

Stephen Y. Hart
(Notary Public)

(SEAL)

CERTIFICATE OF REGISTRATION

STATE OF OREGON

County of Marion } ss.

This is to certify that the foregoing Registration Statement was received in the office of the State Engineer on the 31st day of July, 1958, at 2⁰⁰ o'clock P. M. and has been duly recorded in said office in Book No. 13 of Registration Statements on page GR-3030

Witness my hand this 8th day of June, 1959

Walter A. Stanley
(State Engineer)

By _____ (Deputy)

20-40