

Registration Statement

OF CLAIMANT OF RIGHT TO APPROPRIATE GROUND WATER

8

TO THE STATE ENGINEER OF OREGON:

I, Robert J. Pitto

of Independence County of Polk

State of Oregon, do hereby make application for a certificate of registration as evidence of a right to appropriate ground water.

1. Source from which water is withdrawn is Pump well
(Flowing well, pump well, infiltration trench, or tunnel)

2. Location is: 4 miles south of Independence
(Approximate distance and direction from nearest city or town)

and is more particularly described as follows:

(a) approx 1200 feet west 12700 ft south of section corner
(Give distance and bearing to corner of section or other legal subdivision)
being within SE 1/4 of NE 1/4 of sec 11 of Sec. 11, Twp. 7 S, Rge. 4 W
(Smallest legal subdivision) (N. or S.) (E. or W.)

or (b) within limits of recorded platted property, town or city:

in Lot _____ Block _____ of _____
(Name of plat or addition)

County of Polk
(If within city or town, give name)

3. Construction Work was begun on before 1935; was completed on same
(Date) (Date)

and the ground water claimed was first used for the purposes set out below on before 1935
(Date)

since which time the water has been used intermittently
(Continuously or intermittently)

from before 1935 to present
(Date) (Date)

4. Quantity of water claimed and used is 200 - 900 gallons per minute; _____ acre feet per year.

5. Purpose or Purposes for which water is used irrigation
(Domestic, irrigation, municipal, manufacturing, industrial, etc.)

6. Description of Well: Depth approx 30 feet. Type drilled
(Dug or drilled)

diameter 10 inches. Elevation of ground at well site 190 feet, mean sea level.
(As near as known)

Depth to water table 15-18 feet.

7. Capacity of Well: not known g.p.m. with not known feet drawdown.

_____ g.p.m. with _____ feet drawdown.

Date of test _____

If Flowing Well: Measured discharge _____ g.p.m. on _____
(Date)

Shut-in pressure at ground surface _____ lbs. per sq. in. on _____
(Date)

Water is controlled by _____
(Cap, valve, etc.)

If log of well is not available, give name and address of driller.

11. Infiltration Trench: Covered or open

Dimensions: Length ft. Minimum depth ft. Maximum depth ft.

Bottom width ft. Discharge g.p.m. Date of test

12. Tunnel: Type of lining

Dimensions:
(Length, course, and cross sectional size)

Position of water bearing stratum with reference to portal of tunnel

Log of tunnel: (Preceding table for log of well may be used, if desired. Give footage from portal and character of materials, as pertinent.)

13. Pumping Equipment:

(a) Pump Capacity 700 - 900 g.p.m.

(b) Motor 10 - 50 HP electric
(Type and horsepower)

14. Location of area irrigated or to be irrigated, or place of use if for purposes other than irrigation.

Township North or South	Range E. or W. of Willamette Meridian	Section	Forty-acre Tract	Number Acres To Be Irrigated	Date of Reclamation
9S	4W	11			
9S	4W	11	NE 1/4 of NW 1/4	40	Before 1935
9S	4W	11	SE 1/4 of NW 1/4	17	"
9S	4W	11	NW 1/4 of NE 1/4	40	"
9S	4W	11	SW 1/4 of NE 1/4	13.7	"
9S	4W	11	SW 1/4 NE 1/4	3 ac	Before 1935
"	"	"	SE 1/4 NE 1/4	3 ac	" "
				<u>6.0</u>	" "

15. If the ground water supply is supplemental to an existing water supply, identification of any application for a permit, permit, certificate or adjudicated right to appropriate water made or held by the registrant.

Registration no D.P. 65

GR. 56
3041

Township 9 S Range 4 W, W.M.
North

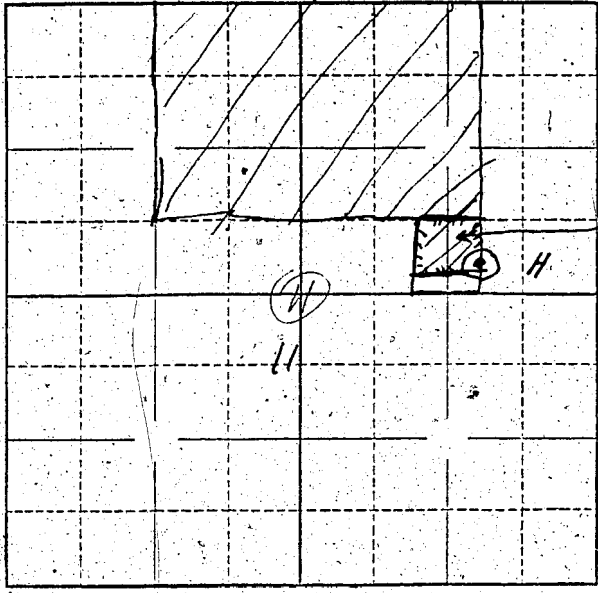

Locate well and acreage of irrigated land on plat.

Scale: 2" = 1 Mile

STATE OF OREGON

County of Marion } ss.

I, Bob Pitts, being first duly sworn, do hereby certify that I have read the foregoing Registration Statement and that all of the items therein contained are true to the best of my knowledge and belief.

Bob Pitts
(Signature of Registrant)

Subscribed and sworn to before me this 30th day of July, 1958

My commission expires 12th June 1961 Wm. S. Bartholomew
(Notary Public)

(SEAL)

CERTIFICATE OF REGISTRATION

STATE OF OREGON

County of Marion } ss.

This is to certify that the foregoing Registration Statement was received in the office of the State Engineer on the 31st day of July, 1958, at 3:00 o'clock P. M. and has been duly recorded in said office in Book No. 13 of Registration Statements on page GR-3041

Witness my hand this 8th day of June, 1959

Henry G. Stanley
(State Engineer)

By _____ (Deputy)

GR - 3041

\$15.00