

Registration Statement

OF CLAIMANT OF RIGHT TO APPROPRIATE GROUND WATER

TO THE STATE ENGINEER OF OREGON:

I, Roy S. Aschfeld
of 1566 Silverton Rd County of Marion
(Mailing address)

State of Ore, do hereby make application for a certificate of registration as evidence of a right to appropriate ground water.

1. Source from which water is withdrawn is Pump Well
(Flowing well, pump well, infiltration trench, tunnel)

2. Location is: 5 miles NE of Salem Ore
(Approximate distance and direction from nearest city or town)
and is more particularly described as follows: From SW cor Howell Plg 97.5' E, thence 1/4 55° W 760' thence 55° E, 101' to well

(a) A Part of Cyrus Pitney D. F. C.
(Give distance and bearing of corner of section or other legal subdivision)
being within 9 acres of Sec. 9, Twp. 7-S, Rge. 2 W
(Smallest legal subdivision) NWNE (N. or S.) (E. or W.)

or (b) within limits of recorded platted property, town or city: Marion NWNE

in Lot _____, Block _____ of _____
(Name of plat or addition)

County of _____
(If within city or town, give name)

3. Construction Work was begun on Mar 10 - 49, was completed on Mar 16 - 49
(Date) (Date)

and the ground water claimed was first used for the purposes set out below on Mar 18 - 49
(Date)

since which time the water has been used Continuously
(Continuously or intermittently)

from Mar 18 - 49 to now
(Date) (Date)

4. Quantity of water claimed and used is 65 gallons per minute; _____ acre feet per year.

5. Purpose or Purposes for which water is used irrigation of about 5 acres
(Domestic, irrigation, municipal, manufacturing, industrial, etc.)

6. Description of Well: Depth 81 feet. Type Drilled
(Dug or drilled)

diameter 6 inches. Elevation of ground at well site 198 feet at Gordon Rd to Silverton Rd feet, mean sea level.
(As near as known)

Depth to water table 28 feet.

7. Capacity of Well: 65 g.p.m. with 50 feet drawdown.

_____ g.p.m. with _____ feet drawdown.

Date of test at time well was drilled

If Flowing Well: Measured discharge _____ g.p.m. on _____
(Date)

Shut-in pressure at ground surface _____ lbs. per sq. in. on _____
(Date)

Water is controlled by _____
(Cap, valve, etc.)

8. Casing: (Give diameter, commercial specifications and depth below ground surface of each casing size.)

6" inch diameter *all way down* from to feet
 inch diameter from to feet
 inch diameter from to feet
 inch diameter from to feet

Describe and show depth of shoe, plug, adapter, liner or other details:
6" casing all way down

9. Perforated Casings or Screens:

(Number per foot and size of perforations, or describe screen) from to
 from to
 from to
 from to

10. Log of Well: (Describe each stratum or formation clearly, indicate if water bearing, and give thickness and depth as indicated.)

MATERIAL	Thickness (Feet)	Depth to Bottom (Feet)
<i>No log was kept that I know of.</i>		
<i>I do know they hit a lime rock & slate at 60 feet then sand 10' & then gravel that is where they stopped</i>		

If log of well is not available, give name and address of driller.

W. K. ...

11. Infiltration Trench: Covered or open

Dimensions: Length Minimum depth ft. Maximum depth ft.
Bottom width ft: Discharge g.p.m. Date of test

12. Tunnel: Type of lining

Dimensions: (Length, course, and cross sectional size)
Position of water bearing stratum with reference to portal of tunnel

Log of tunnel: (Preceding table for log of well may be used, if desired. Give footage from portal and character of materials, as pertinent.)

13. Pumping Equipment:

(a) Pump *2 Horse Jet Jazzer* Capacity *7.5* g.p.m.
(Make, type and size)

(b) Motor *2 Horse Jet*
(Type and horsepower)

14. Location of area irrigated or to be irrigated, or place of use if for purposes other than irrigation.

Township North or South	Range E. or W. of Willamette Meridian	Section	Forty-acre Tract	Number Acres To Be Irrigated	Date of Reclamation
7S	2W	9	NE $\frac{1}{4}$ of NW $\frac{1}{4}$	1.0	<i>Have used since 1949 it for 10 years</i>
"	"	"	NW $\frac{1}{4}$ of NE $\frac{1}{4}$	4.0	
				<i>5.0 Total</i>	
<i>From my N.E. corner down center of Sheraton Salem Road 366 ft then to left in a South West direction then left 10 feet in a Southeast Direction to well</i>					

15. If the ground water supply is supplemental to an existing water supply, identification of any application for a permit, permit, certificate or adjudicated right to appropriate water made or held by the registrant.

Township 7S Range 2W W.M.

North

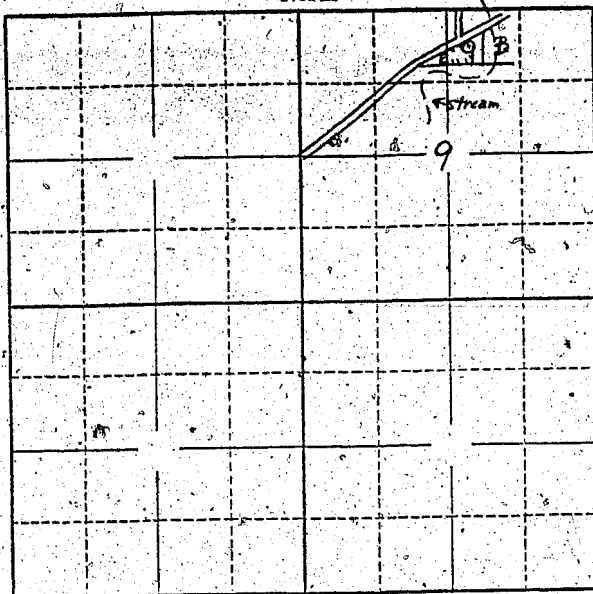

Locate well and acreage of irrigated land on plat.

Scale: 2" = 1 Mile

STATE OF OREGON

County of Marion

ss.

I, Ray S. Seafield, being first duly sworn, do hereby certify that I have read the foregoing Registration Statement and that all of the items therein contained are true to the best of my knowledge and belief.

Ray S. Seafield
(Signature of Registrant)

Subscribed and sworn to before me this 29 day of July, 1958

My commission expires

MY COMMISSION EXPIRES MAR. 2, 1962

Grant B. Wilson
(Notary Public)

(SEAL)

CERTIFICATE OF REGISTRATION

STATE OF OREGON

County of Marion

ss.

This is to certify that the foregoing Registration Statement was received in the office of the State Engineer on the 31st day of July, 1958, at 10:00 o'clock A. M. and has been duly recorded in said office in Book No. 16 of Registration Statements on page GR-3894

Witness my hand this 15th day of February, 1960

Lawrence A. Stanley
(State Engineer)

By

(Deputy)

\$15.00

GR 3894