

Registration Statement

OF CLAIMANT OF RIGHT TO APPROPRIATE GROUND WATER

(Under Chapter 703, Oregon Laws 1955.)

TO THE STATE ENGINEER OF OREGON:

I, John Jeffery 5220 Hayeville Drive
Salem, Oregon
County of Marion
State of Oregon, do hereby make application for a certificate of registration as evidence
of a right to appropriate ground water.

1. Source from which water is withdrawn is Pump Well
(Flowing well, pump well, infiltration trench, or tunnel)
2. Location is: 5 miles NE & East of Salem
(Approximate distance and direction from nearest city or town)

and is more particularly described as follows:

- (a) 2800 ft East & 3200 S of N.W. Corner of Sec 5.
(Give distance and bearing to corner of section or other legal subdivision)
- being within NE & SW 1/4 of Sec. 5, Twp. 7 S, Rge. 2 W
(Smallest legal subdivision) (N. or S.) (E. or W.)
- or (b) within limits of recorded platted property, town or city:

in Lot _____, Block _____ of _____
(Name of plat or addition)

County of _____
(If within city or town, give name)

3. Construction Work was begun on July 1950; was completed on July 1950
(Date) (Date)
- and the ground water claimed was first used for the purposes set out below on June 1951
(Date)
- since which time the water has been used Continuously for irrigation each year
(Continuously or intermittently)
- from May to Oct
(Date) (Date)

4. Quantity of water claimed and used is 500 gallons per minute; 60 acre
feet per year.

5. Purpose or Purposes for which water is used Irrigation of land
(Domestic, irrigation, municipal, manufacturing, industrial, etc.)

6. Description of Well: Depth 73 feet. Type Drilled
(Dug or drilled)

diameter 8 inches. Elevation of ground at well site 182 feet, mean sea level.
(As near as known)

Depth to water table 50 feet.

7. Capacity of Well: 550 g.p.m. with 25 feet drawdown.
g.p.m. with _____ feet drawdown.

Date of test _____

If Flowing Well: Measured discharge _____ g.p.m. on _____ (Date)

Shut-in pressure at ground surface _____ lbs. per sq. in. on _____ (Date)

Water is controlled by _____ (Cap, valve, etc.)

8. Casing: (Give diameter, commercial specifications and depth below ground surface of each casing size.)

8 1/4 inch diameter from *top* to *70* feet
 inch diameter from to feet
 inch diameter from to feet
 inch diameter from to feet

Describe and show depth of shoe, plug, adapter, liner or other details:

.....

.....

9. Perforated Casings or Screens:

Perforated from *50'* to *70'*
 (Number per foot and size of perforations, or describe screen)
 from to
 from to
 from to

10. Log of Well: (Describe each stratum or formation clearly, indicate if water bearing, and give thickness and depth as indicated.)

MATERIAL	Thickness (Feet)	Depth to Bottom (Feet)
<i>unknown</i>		

If log of well is not available, give name and address of driller.

11. Infiltration Trench; Covered or open

Dimensions: Length ft. Minimum depth ft. Maximum depth ft.

Bottom width ft. Discharge g.p.m. Date of test

12. Tunnel: Type of lining

Dimensions:
(Length, course, and cross sectional size)

Position of water bearing stratum with reference to portal of tunnel

Log of tunnel: (Preceding table for log of well may be used, if desired. Give footage from portal and character of materials, as pertinent.)

13. Pumping Equipment:

(a) Pump Berkley Capacity 550 g.p.m.
(Make, type and size)

(b) Motor 3 phase 15 H.P.
(Type and horsepower)

14. Location of area irrigated or to be irrigated, or place of use if for purposes other than irrigation.

Township North or South	Range E. or W. of Willamette Meridian	Section	Forty-acre Tract	Number Acres To Be Irrigated	Date of Reclamation
T7S	R2W	5	NE 1/4 SW 1/4	25	1951
			SE 1/4 SW 1/4	24	1951
				<u>49</u>	

15. If the ground water supply is supplemental to an existing water supply, identification of any application for a permit, permit, certificate or adjudicated right to appropriate water made or held by the registrant.

Township 7S Range 2W, W.M.
North

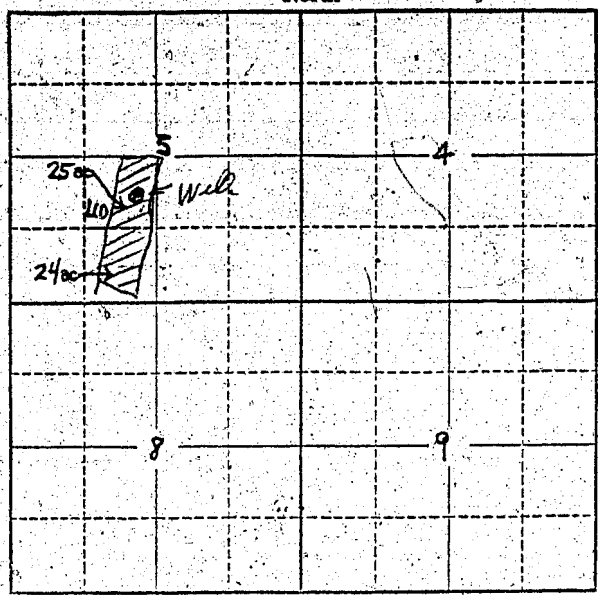

Locate well and acreage of irrigated land on plat.
Scale: 2" = 1 Mile

STATE OF OREGON
County of Marion } ss.

I, John Jeffery, being first duly sworn, do hereby certify that I have read the foregoing Registration Statement and that all of the items therein contained are true to the best of my knowledge and belief.

John Jeffery
(Signature of Registrant)

Subscribed and sworn to before me this 8th day of January, 1957

My commission expires 9/27/58

Jeanne Bayler
(Notary Public)

(SEAL)

CERTIFICATE OF REGISTRATION

STATE OF OREGON
County of Marion } ss.

This is to certify that the foregoing Registration Statement was received in the office of the State Engineer on the 8th day of January, 1957, at 8 o'clock A.M. and has been duly recorded in said office in Book No. 2 of Registration Statements on page GR-311 C.

~~Construction shall be completed by X-X-X-X-X-X-X-X-X-X-19-X-X and the water completely applied to beneficial uses by X-X-X-X-X-X-X-X-X-X-19-X-X.~~

Witness my hand this 14th day of March, 1957

Lawrence A. Stanley
(State Engineer)

\$17.85

By _____ (Deputy)