

# Registration Statement

## OF CLAIMANT OF RIGHT TO APPROPRIATE GROUND WATER



TO THE STATE ENGINEER OF OREGON:

I, Edw. L. McCloud  
of 1985 Claxter Road, Salem, Oreg. County of Marion  
(Mailing address)

State of Oregon, do hereby make application for a certificate of registration as evidence of a right to appropriate ground water.

1. Source from which water is withdrawn is pump well  
(Flowing well, pump well, infiltration trench, or tunnel)

2. Location is: 2 miles north of Salem  
(Approximate distance and direction from nearest city or town)

and is more particularly described as follows: 1800 feet east & 610 feet north from SW corner Section 1

(a) 235 ft. NE of intersection of Claxter Road and Ridge Drive  
(Give distance and bearing to corner of section or other legal subdivision)

being within SE 1/4 of SW 1/4 of Sec. 1, Twp. 7 S, Rge. 3 W  
(Smallest legal subdivision) (N. or S.) (E. or W.)

or (b) within limits of recorded platted property, town or city: \_\_\_\_\_

in Lot \_\_\_\_\_, Block \_\_\_\_\_ of \_\_\_\_\_  
(Name of plat or addition)

County of \_\_\_\_\_  
(If within city or town, give name)

3. Construction Work was begun on Aug. 1949; was completed on Aug. 1949  
(Date) (Date)

and the ground water claimed was first used for the purposes set out below on June 1950  
(Date)

since which time the water has been used intermittently  
(Continuously or Intermittently)

from June 1950 to July 1950  
(Date) (Date)

4. Quantity of water claimed and used is 60 gallons per minute; 3 acre feet per year.

5. Purpose or Purposes for which water is used irrigation  
(Domestic, irrigation, municipal, manufacturing, industrial, etc.)

6. Description of Well: Depth 55 feet. Type drilled  
(Dug or drilled)

diameter 6 inches. Elevation of ground at well site 200 feet, mean sea level.  
(As near as known)

Depth to water table 30 feet.

7. Capacity of Well: 45 g.p.m. with no measurable feet drawdown.  
not tested g.p.m. with \_\_\_\_\_ feet drawdown.

Date of test Aug. 1949 - by driller

If Flowing Well: Measured discharge \_\_\_\_\_ g.p.m. on \_\_\_\_\_  
(Date)

Shut-in pressure at ground surface \_\_\_\_\_ lbs. per sq. in. on \_\_\_\_\_  
(Date)

Water is controlled by \_\_\_\_\_  
(Cap, valve, etc.)





Township 7 S Range 3 W W.M.  
North

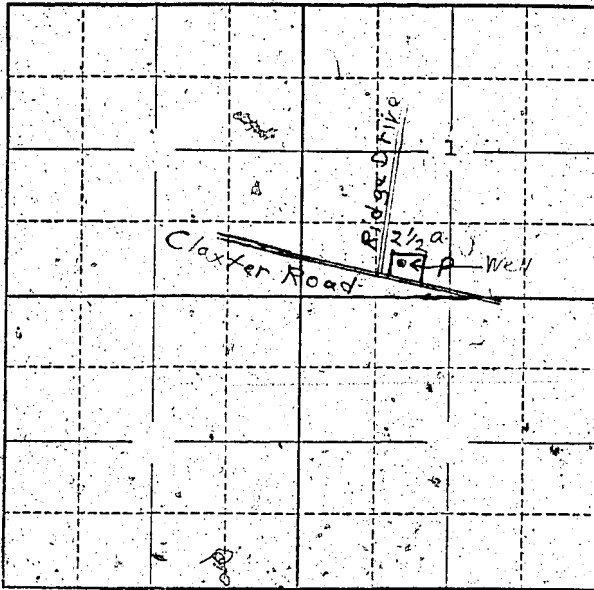

Locate well and acreage of irrigated land on plat.  
Scale: 2" = 1 Mile

STATE OF OREGON

County of Marion } ss.

I, \_\_\_\_\_, being first duly sworn, do hereby certify that I have read the foregoing Registration Statement and that all of the items therein contained are true to the best of my knowledge and belief.

*Edw. L. McCloud*  
(Signature of Registrant)

Subscribed and sworn to before me this 31 day of July, 1958.

My commission expires Nov 30, 1958

*Blanche Nichol*  
(Notary Public)

(SEAL)

CERTIFICATE OF REGISTRATION

STATE OF OREGON

County of Marion } ss.

This is to certify that the foregoing Registration Statement was received in the office of the State Engineer on the 31st day of July, 1958, at 11:00 o'clock A.M. and has been duly recorded in said office in Book No. 13 of Registration Statements on page GR-3073

Witness my hand this 8th day of June, 1959

\$15.00

*Laura A. Stanley*  
(State Engineer)

By \_\_\_\_\_ (Deputy)