

Registration Statement

OF CLAIMANT OF RIGHT TO APPROPRIATE GROUND WATER

TO THE STATE ENGINEER OF OREGON:

I, Clarence E. Waldahl
of 695 River Loop 2 (Mailing address) County of Lane

State of Ore., do hereby make application for a certificate of registration as evidence of a right to appropriate ground water.

- 1. Source from which water is withdrawn is pumping well (Flowing well, pump well, infiltration trench, or tunnel)
- 2. Location is: 7 miles north of Eugene (Approximate distance and direction from nearest city or town)

and is more particularly described as follows: 840 feet east & 100 feet north from W 1/4 corner Section 7

(a) beginning at point 30 ft N & 24.95 chains N 89° 53' E of N.W. corner of B.W. Poindexter Land Claim No. 57 (Give distance and bearing to corner of section or other legal subdivision)
being within SW 1/4 NW 1/4 (Smallest legal subdivision) of Sec. 1, Twp. 17 S, Rge. R 4 W (N. or S.) (E. or W.)

or (b) within limits of recorded platted property, town or city: Eugene
in Lot _____, Block _____ of Willamette Meridian (Name of plat or addition)
County of Lane (If within city or town, give name)

3. Construction Work was begun on 7 1950 (Date); was completed on 1959 (Date)

and the ground water claimed was first used for the purposes set out below on summer 49 or 50 (Date)
since which time the water has been used summer only (Continuously or intermittently)
from 1950 (Date) to 1957 (Date)

4. Quantity of water claimed and used is 15 gallons per minute; _____ acre feet per year.

5. Purpose or Purposes for which water is used to irrigate pasture and garden (Domestic, irrigation, municipal, manufacturing, industrial, etc.)

6. Description of Well: Depth 15 feet. Type hand drilled (Dug or drilled)
diameter 2 inches. Elevation of ground at well site _____ feet, mean sea level. (As near as known)
Depth to water table 7 feet.

7. Capacity of Well: _____ g.p.m. with _____ feet drawdown.
_____ g.p.m. with _____ feet drawdown.

Date of test no test

If Flowing Well: Measured discharge _____ g.p.m. on _____ (Date)

Shut-in pressure at ground surface _____ lbs. per sq. in. on _____ (Date)

Water is controlled by plunging (Cap, valve, etc.)

8. Casing: (Give diameter, commercial specifications and depth below ground surface of each casing size.)

2 in pipe
inch diameter from to feet
inch diameter from to feet
inch diameter from to feet
inch diameter from to feet

Describe and show depth of shoe, plug, adapter, liner or other details:

9. Perforated Casings or Screens:

..... from to
(Number per foot and size of perforations, or describe screen)
..... from to
..... from to
..... from to

10. Log of Well: (Describe each stratum or formation clearly, indicate if water bearing, and give thickness and depth as indicated.)

MATERIAL	Thickness (Feet)	Depth to Bottom (Feet)

If log of well is not available, give name and address of driller.

11. Infiltration Trench: Covered or open

Dimensions: Length ft. Minimum depth ft. Maximum depth ft.

Bottom width ft. Discharge g.p.m. Date of test

12. Tunnel: Type of lining

Dimensions:
(Length, course, and cross sectional size)

Position of water bearing stratum with reference to portal of tunnel

Log of tunnel: (Preceding table for log of well may be used, if desired. Give footage from portal and character of materials, as pertinent.)

13. Pumping Equipment:

(a) Pump *Jacuzzi* Capacity *915* g.p.m.
(Make, type and size)

(b) Motor *2 H.P.*
(Type and horsepower)

14. Location of area irrigated or to be irrigated, or place of use if for purposes other than irrigation.

Township North or South	Range E. or W. of Williams's Meridian	Section	Forty-acre Tract	Number Acres To Be Irrigated	Date of Reclamation
T17S	R4W	1	SW 1/4 of NW 1/4	0.52 Acre	1950

15. If the ground water supply is supplemental to an existing water supply, identification of any application for a permit, permit, certificate or adjudicated right to appropriate water made or held by the registrant.

Township 173 Range 4 W W.M.
North

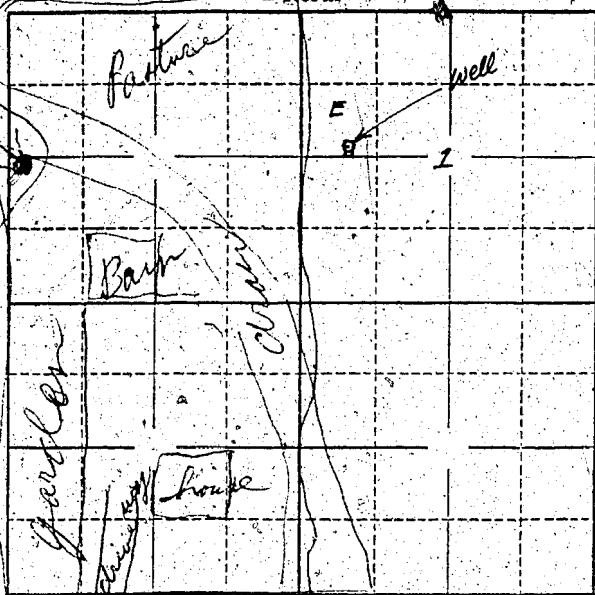

Locate well and acreage of irrigated land on plat.

Scale: $\frac{1}{2}$ inch = 1 Mile

STATE OF OREGON

County of Lane } ss.

I, C. E. Wallace, being first duly sworn, do hereby certify that I have read the foregoing Registration Statement and that all of the items therein contained are true to the best of my knowledge and belief.

C. E. Wallace
(Signature of Registrant)

Subscribed and sworn to before me this 30 day of July, 1958

My commission expires June 24 - 1961

Paul H. Stanley
(Notary Public) for Oregon

(SEAL)

CERTIFICATE OF REGISTRATION

STATE OF OREGON

County of Marion } ss.

This is to certify that the foregoing Registration Statement was received in the office of the State Engineer on the 31st day of July, 1958, at 2:05 o'clock A. M. and has been duly recorded in said office in Book No. _____ of Registration Statements on page GR 1008

Witness my hand this 14th day of July, 1960

Paul H. Stanley
(State Engineer)

By _____ (Deputy)

GR 1008