

Registration Statement

OF CLAIMANT OF RIGHT TO APPROPRIATE GROUND WATER

TO THE STATE ENGINEER OF OREGON:

I, Lloyd Wiedewitsch
of Cornelius Rt 2 County of Washington
(Mailing address)

State of _____ do hereby make application for a certificate of registration as evidence of a right to appropriate ground water.

1. Source from which water is withdrawn is Pump Well
(Flowing well, pump well, infiltration trench, or tunnel)

2. Location is: 1/2 mile E of Cornelius
(Approximate distance and direction from nearest city or town)

and is more particularly described as follows:

(a) 1560' N & 1585' E of SW corner of Sec 34
(Give distance and bearing to corner of section or other legal subdivision)
being within S 1/4 of S 1/2 of N 1/4 of Sec. 34, Twp. T 1 S, Rge. 3 W
(Smallest legal subdivision) (N. or S.) (E. or W.)

or (b) within limits of recorded platted property, town or city: _____

in Lot _____, Block _____ of _____
(Name of plat or addition)
County of _____
(If within city or town, give name)

3. Construction Work was begun on July 1950; was completed on July 1950
(Date) (Date)

and the ground water claimed was first used for the purposes set out below on July 1950
(Date)

since which time the water has been used irrigation intermittently
(Continuously or intermittently)

from July 1950 to July 1958
(Date) (Date)

4. Quantity of water claimed and used is 33 gallons per minute; 25 acre feet per year.

5. Purpose or Purposes for which water is used irrigation

(Domestic, irrigation, municipal, manufacturing, industrial, etc.)

6. Description of Well: Depth 30 feet. Type Dug
(Dug or drilled)

diameter 7 inches. Elevation of ground at well site 200 feet, mean sea level.
(As near as known)

Depth to water table 12 feet.

7. Capacity of Well: 33 g.p.m. with 27 feet drawdown.

_____ g.p.m. with _____ feet drawdown.

Date of test July 1, 1958

If Flowing Well: Measured discharge _____ g.p.m. on _____
(Date)

Shut-in pressure at ground surface _____ lbs. per sq. in. on _____
(Date)

Water is controlled by _____
(Cap, valve, etc.)

8. Casing: (Give diameter, commercial specifications and depth below ground surface of each casing size.)

6 inch diameter from 0.5 to 20 feet
 inch diameter from to feet
 inch diameter from to feet
 inch diameter from to feet

Describe and show depth of shoe, plug, adapter, liner or other details:

9. Perforated Casings or Screens:

..... from to
 (Number per foot and size of perforations, or describe screen)
 from to
 from to
 from to

10. Log of Well: (Describe each stratum or formation clearly, indicate if water bearing, and give thickness and depth as indicated.)

MATERIAL	Thickness (Feet)	Depth to Bottom (Feet)
Top Soil	42	12
Sub Soil clay	67	18
Hard pan	1 1/2	19 1/2
Brown Sand	3	22 1/2
Hard pan	1	23 1/2
Brown Sand	3	26 1/2
Hard pan	1/2	27
Blue Sand	3	30

If log of well is not available, give name and address of driller:

11. Infiltration Trench: Covered or open

Dimensions: Length ft. Minimum depth ft. Maximum depth ft.

Bottom width ft. Discharge g.p.m. Date of test

12. Tunnel: Type of lining

Dimensions:
(Length, course, and cross sectional size)

Position of water bearing stratum with reference to portal of tunnel

Log of tunnel: (Preceding table for log of well may be used, if desired. Give footage from portal and character of materials, as pertinent.)

13. Pumping Equipment:

(a) Pump Montgomery Ward Jet Capacity 33 g.p.m.
(Make, type and size)

(b) Motor Electric 1 1/2 HP Heavy Duty
(Type and horsepower)

14. Location of area irrigated or to be irrigated, or place of use if for purposes other than irrigation.

Township North or South	Range E. or W. of Willamette Meridian	Section	Forty-acre Tract	Number Acres To Be Irrigated	Date of Reclamation
1S	3W	34	SW 1/4 of SW 1/4 NW 1/4	10	July 1950

15. If the ground water supply is supplemental to an existing water supply, identification of any application for a permit, permit, certificate or adjudicated right to appropriate water made or held by the registrant.

Township 1S Range 34N, W.M.
North

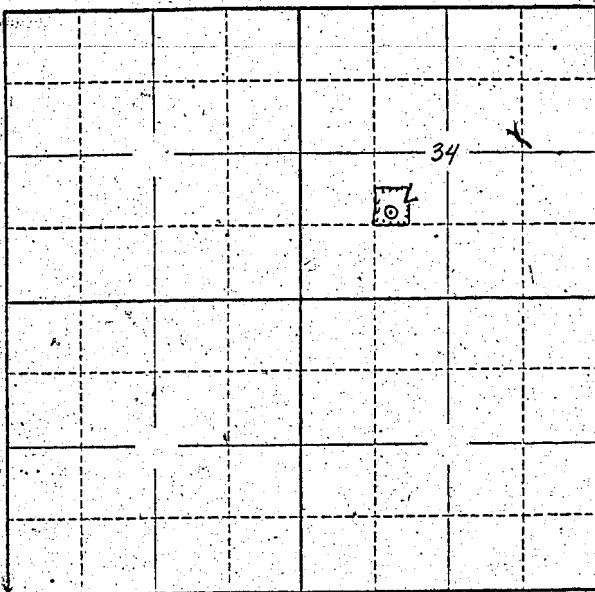

Locate well and acreage of irrigated land on plat.
Scale: 2" = 1 Mile

STATE OF OREGON

County of Washt } ss.

I, LLOYD WIEDEWITSCH, being first duly sworn, do hereby certify that I have read the foregoing Registration Statement and that all of the items therein contained are true to the best of my knowledge and belief.

Lloyd Wiedewitsch
(Signature of Registrant)

Subscribed and sworn to before me this 30 day of JULY, 1958

My commission expires 9-6-58

John Hurley
(Notary Public)

(SEAL)

CERTIFICATE OF REGISTRATION

STATE OF OREGON

County of Marion } ss.

This is to certify that the foregoing Registration Statement was received in the office of the State Engineer on the 31 day of July, 1958 at 8:00 o'clock A. M. and has been duly recorded in said office in Book No. 13 of Registration Statements on page GR 3091

Witness my hand this 16th day of June, 1959

Laura A. Stanley
(State Engineer)

By _____

(Deputy)

\$15.00

GR - 3091